

**Engine Model  
CPL**

**4BT 3.9**

(CDC 4.390)

**TURBOCHARGED**

**NON - EMISSION**

**239 Cubic Inch**

**Piston Std (m): 7163**

**CUMMINS CPL's**

690	817	1202	1631
727	857	1268	1659
730	858	1277	2021
762	971	1287	2340
763	1201	1508	2414

**CASE-IH (Agricultural)**

5120	Tractor
5220	"
8840	Windrower

**CASE (Construction)**

450C	Crawler
455C	"
550	"
550E	"
550G	"
570LXT	Backhoe
580K	"
580L	"
580SE	"
580SK	"
580SL	"
590SL	"
650G	Crawler
688	Excavator
860	Trencher
9010	Crawler
W11B	Wheel Loader

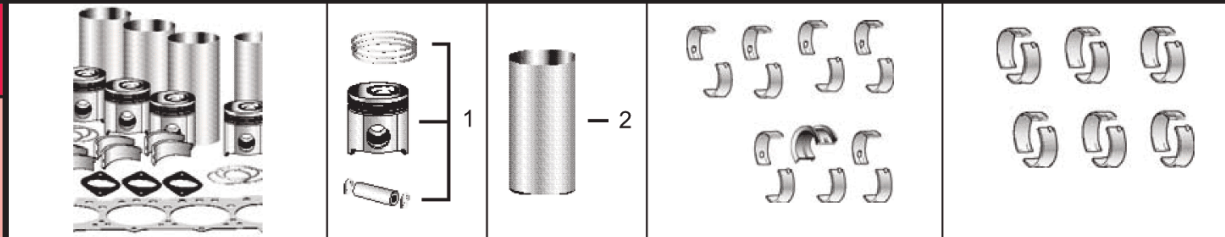

Eng. O/H & I/F Kit	1) Piston Kit *	Main Bearing Set	Con Rod Bearing
<b>COK2160/4</b> Std.	<b>2) Repair Sleeve</b>	<b>Use 1</b> <a href="#">C3802010</a> Std. <a href="#">C3802011</a> 0.25 mm <a href="#">C3802012</a> 0.50 mm <a href="#">C3802013</a> 0.75 mm	<a href="#">C3901170</a> Std. <a href="#">C3901171</a> 0.25 mm <a href="#">C3901172</a> 0.50 mm <a href="#">C3901173</a> 0.75 mm <hr/> <a href="#">C4893693</a> Std. ● <a href="#">C4892795</a> 0.25 mm ● <a href="#">C4892796</a> 0.50 mm ● <a href="#">C4892797</a> 0.75 mm ●
<b>COK2132/4</b> 0.50 mm	1) <a href="#">C3802160</a> Std.		
<b>COK2134/4</b> 1.00 mm	<a href="#">C3802132</a> 0.50 mm <a href="#">C3802134</a> 1.00 mm		
<b>COK2160F/4</b> Std. ●	<b>Use 4</b>		
<b>COK2132F/4</b> 0.50 mm ●			
<b>COK2134F/4</b> 1.00 mm ●	2) <a href="#">C3904166</a>		
<b>To order an In-Frame Kit change <u>OK</u> to <u>IK</u></b>			

**\* Piston Kit consists of:**  
 1) 1 [C3907163](#) Piston Std, 1 [C3802230](#) Ring Set Std, 1 [C3901793](#) Piston Pin, 2 [C3901706](#) Ret.  
 2) 1 [C3908815](#) Piston 0.50 mm, 1 [C3802232](#) Ring Set 0.50 mm, 1 [C3901793](#) Piston Pin, 2 [C3901706](#) Ret.  
 3) 1 [C3908816](#) Piston 1.00 mm, 1 [C3802234](#) Ring Set 1.00 mm, 1 [C3901793](#) Piston Pin, 2 [C3901706](#) Ret.

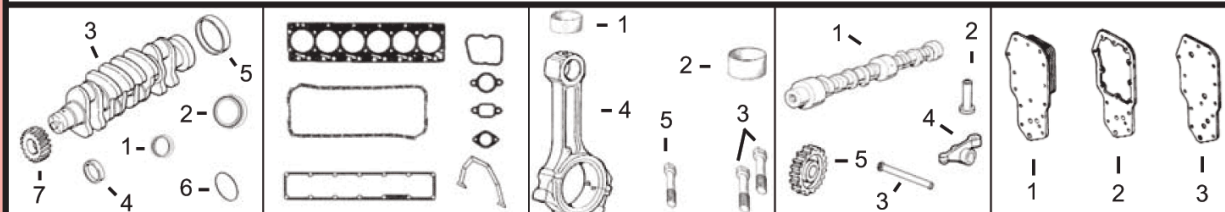

1) <b>Front Seal</b> 2) <b>Rear Seal</b>	1) <b>Top Gasket Set</b> 2) <b>Bottom Gasket Set</b>	1) <b>Bushing, Piston</b> 2) <b>Bushing, Cam</b>	1) Camshaft 2) Tappet 3) Push Rod 4) Rocker Arms 5) Camshaft Gear	1) Oil Cooler 7 Plate 2) Oil Cooler Gasket 3) Oil Cooler Gasket Filter Head
3) Crankshaft 4) Front Seal Sleeve 5) Rear Seal Sleeve 6) Rectangular Seal 7) Crankshaft, Gear	3) Head Gasket 4) Oil Pan Gasket 5) Valve Cover Gsk 6) Gear Housing Gsk 7) Rear Cover Gsk	3) Bolt, Con Rod 4) Con Rod 5) Bolt, Ex Manifold		

1) <a href="#">C3904353</a> 2) <a href="#">C3353978</a> 3) <a href="#">C3907803</a> 4) <a href="#">C3906080</a> 5) <a href="#">C3906081</a> 6) <a href="#">C3912473</a> 7) <a href="#">C3901258</a>	1) <a href="#">C3804896</a> 2) <a href="#">C3802375</a> 3) <a href="#">C3921393</a> 4) <a href="#">C3931602</a> 5) <a href="#">C3902666</a> 6) <a href="#">C3916131</a> 7) <a href="#">C3928493</a>	1) <a href="#">C4891178</a> x4 2) <a href="#">C3901306</a> x1 (3) 3) <a href="#">C3900919</a> x8 4) <a href="#">C3901569</a> (7) <a href="#">C4943979</a> (8) 5) <a href="#">C3944593</a>	1) <a href="#">C3925582</a> (9) 2) <a href="#">C3925031</a> 3) <a href="#">C3904679</a> 4) <a href="#">C3910811</a> x4 <a href="#">C3910810</a> x4 5) <a href="#">C3907431</a>	1) <a href="#">C3921557</a> 2) <a href="#">C3926760</a> 3) <a href="#">C3929792</a>
---	---	--	---	---

	Guide, Valve	1) Intake, Valve Kit 2) Insert, Valve	1) Exhaust, Valve Kit 2) Insert, Valve	1) Spring, Valve 2) Seal, Valve 3) Retainer, Valve
	<a href="#">C3904408</a> <b>Thick W. 60.50 mm IN</b> <a href="#">C3904409</a> <b>Thick W. 51.75 mm EX</b> <a href="#">C3906206</a> (1) <b>Thin Wall</b>	1) <a href="#">C3802355</a> Kit Consists of: <a href="#">C3901117</a> Valve x1 <a href="#">C3900250</a> Collet x2 2) <a href="#">C3906854</a> <b>Use 4</b>	1) <a href="#">C3802356</a> Kit Consists of: <a href="#">C3901607</a> Valve x1 <a href="#">C3900250</a> Collet x2 2) <a href="#">C3904105</a> <b>Use 4</b>	1) <a href="#">C3900276</a> x8 2) <a href="#">C3921640</a> x8 (5) <a href="#">C3957912</a> x8 (6) 3) <a href="#">C3900299</a> x8 (5)

		<p>(●) On Fracture Split Con Rods use: 4 of <a href="#">C3901170</a> (or O/S) and 4 of <a href="#">C4893693</a> (or O/S).                  (1) Can be Used on Both Intake and Exhaust.                  (2) Diaphragm Style.                  (3) For Storm blocks use <a href="#">C3940059</a>.                  (4) Do not use on Marine Engines.                  (5) For use on engines prior to April, 2003.                  (6) For use on engines from April, 2003, (Top Hat Style).                  (7) Machine split connecting rod.                  (8) Fracture split connecting rod.                  (9) Use ESN or application model to confirm correct camshaft.</p>
1) Water Pump 2) Water Pump Seal 3) Thermostat 1) <a href="#">C3286277</a> 2) <a href="#">C3906698</a> 3) <a href="#">C3802273</a>	1) Pump, Oil 2a) Lift Pump 2b) Lift Pump 1) <a href="#">C3926202</a> 2a) <a href="#">C3918000</a> 2b) <a href="#">C3904374</a> (2)	1) Cylinder Head (With Valves) 2) Head Bolts 1) <a href="#">C3920005</a> (4) 2) <a href="#">C3920779</a> x4 <a href="#">C3920780</a> x10