

**Engine Model
CPL**

6CT 8.3

(CDC 6.830)

TURBOCHARGED

Piston Std (m):

3163, 9564, 9928

CUMMINS CPL's

602 828 1274 1603

603 955 1275 9820

753 985 1281

819 1248 1603

CASE-IH (Agricultural)

1660 Combine

1666 Combine, ESN > 44706126 >

1670 Combine, ESN > 44706125

1680 Combine, ESN > 44706125

2044 Cot Picker, ESN > 44706125

2166 Combine, PIN > JJC0180000

7110 Tractor

7120 Tractor

7130 Tractor

7140 Tractor, ESN > 44706125

7150 Tractor, ESN > 44706125

7210 Tractor

7220 Tractor, PIN > JJA0064978

9110 Tractor, ESN > 44706125

9130 Tractor, ESN > 44706125

9210 Tractor

9230 Tractor, ESN > 44706125

9240 Tractor

9310 Tractor, PIN > JEE0036001

CASE (Construction)

721 Loader

721B Loader, PIN > JEE053200

821 Loader

821B Loader, PIN > JEE050601

1150E Crawler

1155E Crawler

1187C Excav, ESN > 44706125

1550 Crawler, ESN > 44706125

9040 Excavator

9040B Excav, PIN > DAC4#2001

W36 Loader

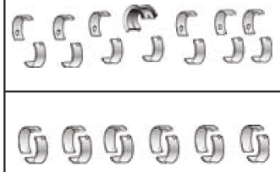
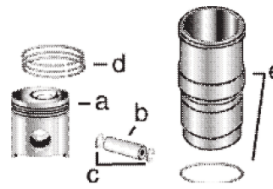

**Engine Overhaul
&
Engine In Frame Kit**

**Cylinder Kit
Thin Wall (*)**

**Cylinder Kit
Thick Wall (**)
Long Liner**

**Cylinder Kit
Thick Wall (***)
Short Liner**

**Main Bearing Set
Con Rod Bearing**

**COK2400
Thin Wall**

C3802400

C3802403

C3802403S

C3802210 Std.

**COK2403
Thick Wall Long**

Consists of:

Consists of:

Consists of:

C3802211 0.25 mm

**COK2403S
Thick Wall Short**

a) C3923163

a) C3923163

a) C3923163

C3802212 0.50 mm

b) C3901597

b) C3901597

b) C3901597

C3802213 0.75 mm

c) C3901996

c) C3901996

c) C3901996

Use 1

d) C3802258

d) C3802258

d) C3802258

C3901430 Std.

e) C3802370

e) C3802407

e) C3800328

C3901431 0.25 mm

**To order an In-Frame
Kit change OK to IK
in above part number**

(C3907792 Liner +
C3907177 Seal)

(C3919937 Liner +
C3907177 Seal)

(C3948095 Liner +
C3907177 Seal)

C3901432 0.50 mm

C3901433 0.75 mm

Use 12 (1)

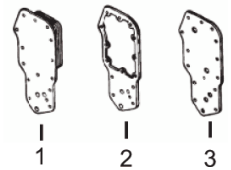
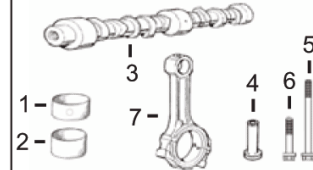
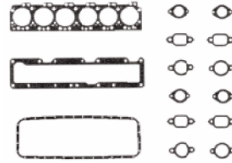
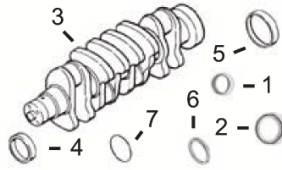

**1) Front Seal
2) Rear Seal
3) Crankshaft
4) Front Wear Sleeve
5) Rear Wear Sleeve
6) Front Rectangular Seal
7) Rear Rectangular Seal**

**1) Top Gasket Set
2) Bottom Gasket Set
3) Head Gasket
4) Oil Pan Gasket
5) Valve Cover Gasket
6) Front Gear Gasket
7) Front Cover Gasket
8) Rear Cover Gasket**

**1) Bushing, Piston
2) Bushing, Camshaft
3) Camshaft
4) Tappet
5) Head Bolt Long
6) Head Bolt Short
7) Con Rod**

**1) Oil Cooler 12 Plate
2) Oil Cooler Gasket
3) Oil Cooler Gasket
Filter Head**

1) C3353977
2) C3353978
3) C3918986
4) C3908277
5) C3906081
6) C3903475
7) C3912473

1) C4025271
2) C3800348
3) C3938267
4) C3914017
5) C3905449
6) C3929253
7) C3917780
8) C3914301

1) C3913990 x6
2) C3943199 x7
3) C3924471 (2)
4) C3925031
5) C3917728 x14 (3)
6) C3917729 x12 (3)
7) C3901383 (4)

1) C3918175
2) C3918174
3) C3914308

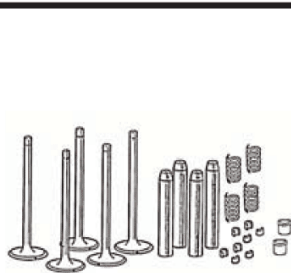

**1) Intake, Valve Kit
2) Insert, Valve**

**1) Exhaust, Valve Kit
2) Insert, Valve**

**1) Spring, Valve
2) Seal, Valve
3) Guide, Valve
4) Retainer, Valve Spring**

1) C3802463
Consists of:
C3924492 Valve x1
C3901177 Collet x2
2) C3924582
Use 6

1) C3802085
Consists of:
C3921444 Valve x1
C3901177 Collet x2
2) C3924583
Use 6

1) C3906412 x12
2) C3915707 x12
3) C3923564 x12
4) C3912976 x12

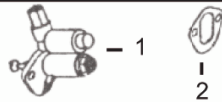
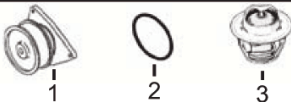

**1) Water Pump
2) Water Pump Seal
3) Thermostat**

Oil Pump
C3930338
(3415365)

**1) Fuel Lift Pump
2) Fuel Pump Gsk**
1) C3917998
2) C3914304

1) C3800976 (5) (6)
2) C3902089
3) C3928639 x2

(*) Block 3802265 (Thin Wall) Flange ø 5.223".

(**) Block 3802408 (Thick Wall / Long Liner) Flange ø 5.152", (Length: 9.33" / 237 mm).

(***) Block 3934906 (Thick Wall / Short Liner) Flange ø 5.152", (Length: 9.12" / 234 mm).

(1) Order in multiples of two.

(2) To use C3924471 to replace 3917882 buy the following from Cummins: 3918777 Cam Gear, 3927155 Thrust and 3902332 Key.

(3) Only use on engines built from year 1991 onwards.

(4) Do not use with Crankshaft part number 3965006.

(5) Some applications use short nose pump C3806180.

(6) Marine applications use C3800975.