

**Engine Model
CPL**

6B 5.9

(CDC 6.590)

NATURALLY ASPIRATED

NON - EMISSION

359 Cubic Inch

Piston Std (m): 6223

CUMMINS CPL's

- 596 802 1320
- 691 845 1403
- 714 * 960 1433
- 791 * 999

* Marine Engine

CASE-IH (Agricultural)

- 5130 Tractor
- 5230 "

CASE (Construction)

- 680K/L Backhoe
- 850D/E Crawler
- 855D/E "
- W14B/C Wheel Loader

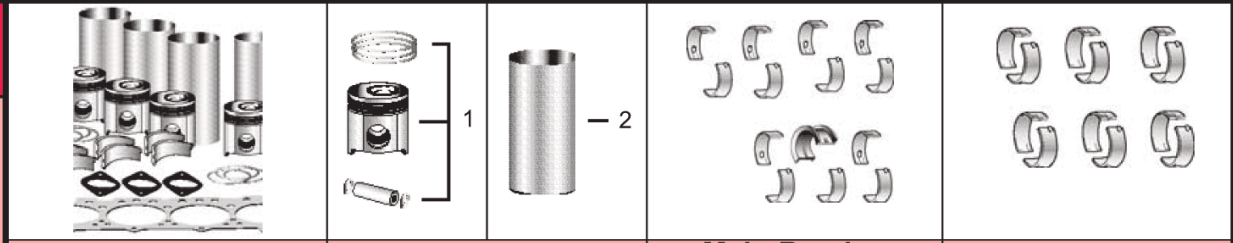

Eng. O/H & I/F Kit	1) Piston Kit *	Main Bearing Set	Con Rod Bearing
COK2060/6 Std. COK2062/6 0.50 mm COK2064/6 1.00 mm <hr/> COK2060F/6 Std. ● COK2062F/6 0.50 mm ● COK2064F/6 1.00 mm ● To order an In-Frame Kit change OK to IK	2) Repair Sleeve 1) C3802060 Std. C3802062 0.50 mm C3802064 1.00 mm Use 6 2) C3904166	C3802070 Std. C3802071 0.25 mm C3802072 0.50 mm C3802073 0.75 mm Use 1	C3901170 Std. C3901171 0.25 mm C3901172 0.50 mm C3901173 0.75 mm <hr/> C4893693 Std. ● C4892795 0.25 mm ● C4892796 0.50 mm ● C4892797 0.75 mm ●

* Piston Kit consists of:
 1) 1 **C3906223** Piston Std, 1 **C3802040** Ring Set Std, 1 **C3901793** Piston Pin, 2 **C3901706** Ret.
 2) 1 **C3906209** Piston 0.50 mm, 1 **C3802042** Ring Set 0.50 mm, 1 **C3901793** Piston Pin, 2 **C3901706** Ret.
 3) 1 **C3906208** Piston 1.00 mm, 1 **C3802044** Ring Set 1.00 mm, 1 **C3901793** Piston Pin, 2 **C3901706** Ret.

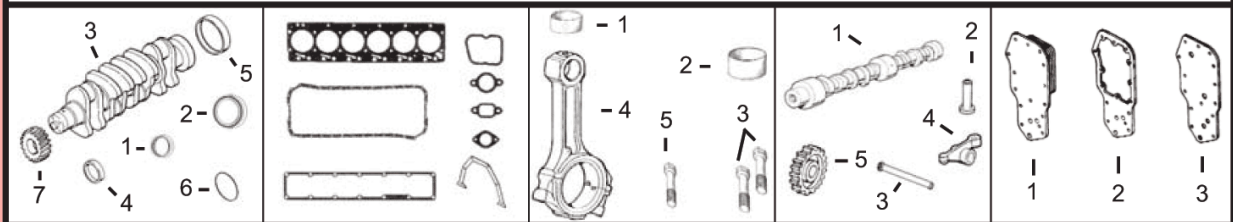

1) Front Seal 2) Rear Seal 3) Crankshaft 4) Front Seal Sleeve 5) Rear Seal Sleeve 6) Rectangular Seal 7) Crankshaft, Gear	1) Top Gasket Set 2) Bottom Gasket Set 3) Head Gasket 4) Oil Pan Gasket 5) Valve Cover Gsk 6) Gear Housing Gsk 7) Rear Cover Gsk	1) Bushing, Piston 2) Bushing, Cam 3) Bolt, Con Rod 4) Con Rod 5) Bolt, Ex Manifold	1) Camshaft 2) Tappet 3) Push Rod 4) Rocker Arms 5) Camshaft Gear	1) Oil Cooler 7 Plate 2) Oil Cooler Gasket 3) Oil Cooler Gasket Filter Head
1) C3904353 2) C3353978 3) C3907804 4) C3906080 5) C3906081 6) C3912473 7) C3901258	1) C3802363 2) C3802376 3) C3921394 4) C3931346 (7) 5) C3902666 6) C3916131 7) C3928493	1) C4891178 x6 2) C3901306 x1 (3) 3) C3900919 x12 4) C3901569 (8) C4943979 (8) 5) C3944593	1) C3914639 2) C3925031 3) C3904679 4) C3910811 x6 C3910810 x6 5) C3907431	1) C3921558 2) C3926760 3) C3929792

	Guide, Valve 1) Intake, Valve Kit 2) Insert, Valve	1) Exhaust, Valve Kit 2) Insert, Valve	1) Spring, Valve 2) Seal, Valve 3) Retainer, Valve
	C3904408 Thick W. 60.50 mm IN C3904409 Thick W. 51.75 mm EX C3906206 (1) Thin Wall	1) C3802355 Kit Consists of: C3901117 Valve x1 C3900250 Collet x2 2) C3906854 Use 6	1) C3802356 Kit Consists of: C3901607 Valve x1 C3900250 Collet x2 2) C3904105 Use 6

	1) Pump, Oil 2a) Lift Pump 2b) Lift Pump	1) Cylinder Head (With Valves) 2) Head Bolts	(●) On Fracture Split Con Rods use: 6 of C3901170 (or O/S) and 6 of C4893693 (or O/S). (1) Can be Used on Both Intake and Exhaust. (2) Diaphragm Style. (3) For Storm blocks use C3940059 . (4) Do not use on Marine Engines. (5) For use on engines prior to April, 2003. (6) For use on engines from April, 2003, (Top Hat Style). (7) Applications with internally cast oil suction tube in Aluminum oil pan, must use 3938161 oil pan gasket. (8) C3901569 Machine Split rod. C4943979 Fracture Split rod.
1) C3286277 2) C3906698 3) C3802273	1) C3926203 2a) C3918000 2b) C3904374 (2)	1) C3913381 (4) 2) C3920779 x6 C3920780 x14	