

**Engine Model
CPL**

6BT 5.9

(CDC 6.590)

TURBOCHARGED

NON - EMISSION

359 Cubic Inch

Piston Std (m): 7163

CUMMINS CPL's

597	938	1163	1288
692	943	1168	1289 *
716	947	1189	1440
729	948	1207	1627
761	949	1245	1685
804	950	1246	2049
807	994	1266	2413
856	1160	1279	

* Marine Engine

CASE-IH

(Agricultural)

1896	Tractor
5140	"
5240	"
5250	"

CASE (Construction)

621/B	Wheel Loader
680L	Backhoe
780C/D	"
850D/E	Crawler
855D/E/G	"
880D	"
888	Excavator
1085B/C	"
1086B	"
1088	"
1150E/G	"
1155E	"
8850	Windrower
9030/B	Excavator
W14B/C	Wheel Loader

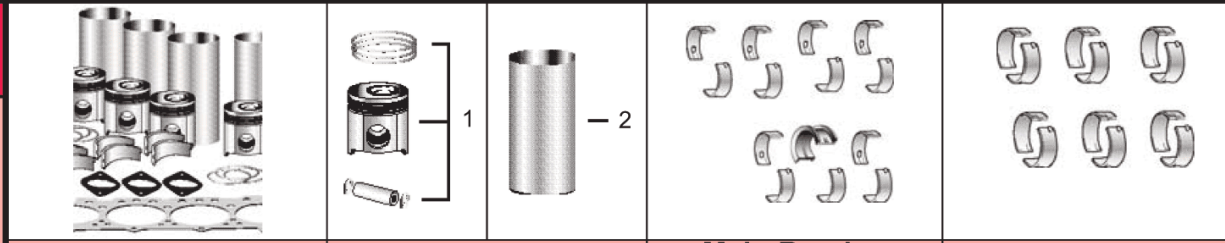

Eng. O/H & I/F Kit	1) Piston Kit *	Main Bearing Set	Con Rod Bearing
COK2160/6 Std.	2) Repair Sleeve	Use 1 C3802070 Std. C3802071 0.25 mm C3802072 0.50 mm C3802073 0.75 mm	Use 6 C3901170 Std. C3901171 0.25 mm C3901172 0.50 mm C3901173 0.75 mm <hr/> C4893693 Std. ● C4892795 0.25 mm ● C4892796 0.50 mm ● C4892797 0.75 mm ●
COK2132/6 0.50 mm	1) C3802160 Std.		
COK2134/6 1.00 mm	C3802132 0.50 mm C3802134 1.00 mm		
COK2160F/6 Std. ●	Use 6		
COK2132F/6 0.50 mm ●			
COK2134F/6 1.00 mm ●	2) C3904166		
To order an In-Frame Kit change OK to IK			

*** Piston Kit consists of:**
 1) 1 [C3907163](#) Piston Std, 1 [C3802230](#) Ring Set Std, 1 [C3901793](#) Piston Pin, 2 [C3901706](#) Ret.
 2) 1 [C3908815](#) Piston 0.50 mm, 1 [C3802232](#) Ring Set 0.50 mm, 1 [C3901793](#) Piston Pin, 2 [C3901706](#) Ret.
 3) 1 [C3908816](#) Piston 1.00 mm, 1 [C3802234](#) Ring Set 1.00 mm, 1 [C3901793](#) Piston Pin, 2 [C3901706](#) Ret.

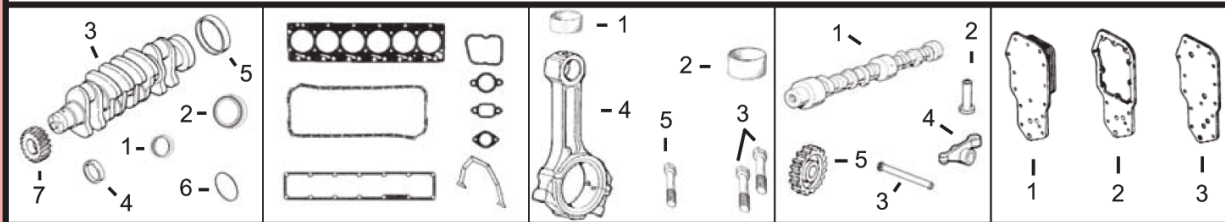

1) Front Seal 2) Rear Seal	1) Top Gasket Set 2) Bottom Gasket Set	1) Bushing, Piston 2) Bushing, Cam	1) Camshaft 2) Tappet 3) Push Rod 4) Rocker Arms 5) Camshaft Gear	1) Oil Cooler 7 Plate 2) Oil Cooler Gasket 3) Oil Cooler Gasket Filter Head
3) Crankshaft 4) Front Seal Sleeve 5) Rear Seal Sleeve 6) Rectangular Seal 7) Crankshaft, Gear	3) Head Gasket 4) Oil Pan Gasket 5) Valve Cover Gsk 6) Gear Housing Gsk 7) Rear Cover Gsk	3) Bolt, Con Rod 4) Con Rod 5) Bolt, Ex Manifold		

1) C3904353 2) C3353978 3) C3907804 4) C3906080 5) C3906081 6) C3912473 7) C3901258	1) C3802363 2) C3802376 3) C3921394 4) C3931346 (7) 5) C3902666 6) C3916131 7) C3928493	1) C4891178 x4 2) C3901306 x1 (3) 3) C3900919 x12 4) C3901569 (7) C4943979 (8) 5) C3944593	1) C3914639 2) C3925031 3) C3904679 4) C3910811 x6 C3910810 x6 5) C3907431	1) C3921558 2) C3926760 3) C3929792
---	---	---	---	---

	Guide, Valve	1) Intake, Valve Kit 2) Insert, Valve	1) Exhaust, Valve Kit 2) Insert, Valve	1) Spring, Valve 2) Seal, Valve 3) Retainer, Valve
	Thick W. 60.50 mm IN C3904408 Thick W. 51.75 mm EX C3904409 C3906206 (1) Thin Wall	1) C3802355 Kit Consists of: C3901117 Valve x1 C3900250 Collet x2 2) C3906854 Use 6	1) C3802356 Kit Consists of: C3901607 Valve x1 C3900250 Collet x2 2) C3904105 Use 6	1) C3900276 x12 2) C3921640 x12 (5) C3957912 x12 (6) 3) C3900299 x12 (5)

		<p>(●) On Fracture Split Con Rods use: 6 of C3901170 (or O/S) and 6 of C4893693 (or O/S). (1) Can be Used on Both Intake and Exhaust. (2) Diaphragm Style. (3) For Storm blocks use C3940059. (4) Do not use on Marine Engines. (5) For use on engines prior to April, 2003. (6) For use on engines from April, 2003, (Top Hat Style). (7) NOT to be used in applications with internally cast oil suction tube in Aluminum oil pan, must then use 3938161 oil pan gasket.</p>
1) Water Pump 2) Water Pump Seal 3) Thermostat 1) C3286277 2) C3906698 3) C3802273	1) Pump, Oil 2a) Lift Pump 2b) Lift Pump 1) C3926203 2a) C3918000 2b) C3904374 (2)	1) Cylinder Head (With Valves) 2) Head Bolts 1) C3913381 (4) 2) C3920779 x6 C3920780 x14