

**Engine Model
CPL**

4BT 3.9

(CDC 4.390)

TURBOCHARGED

NON - EMISSION

239 Cubic Inch

Piston Std (m): 7163

CUMMINS CPL's

690	817	1202	1631
727	857	1268	1659
730	858	1277	2021
762	971	1287	2340
763	1201	1508	2414

CASE-IH (Agricultural)

5120	Tractor
5220	"
8840	Windrower

CASE (Construction)

450C	Crawler
455C	"
550	"
550E	"
550G	"
570LXT	Backhoe
580K	"
580L	"
580SE	"
580SK	"
580SL	"
590SL	"
650G	Crawler
688	Excavator
860	Trencher
9010	Crawler
W11B	Wheel Loader

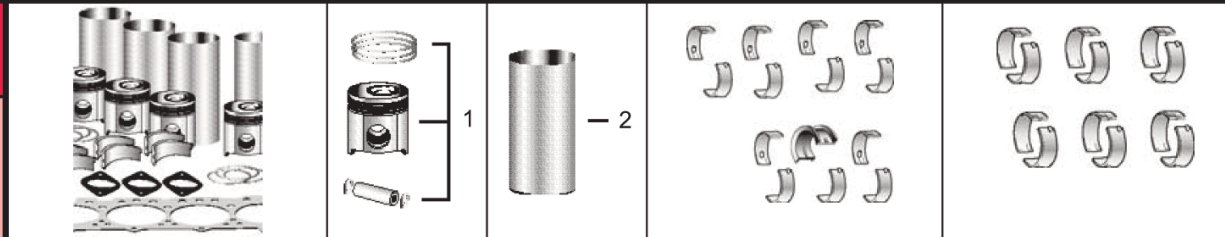

Eng. O/H & I/F Kit	1) Piston Kit *	Main Bearing Set	Con Rod Bearing
COK2160/4 Std.	2) Repair Sleeve	C3802010 Std. C3802011 0.25 mm C3802012 0.50 mm C3802013 0.75 mm	C3901170 Std. C3901171 0.25 mm C3901172 0.50 mm C3901173 0.75 mm
COK2132/4 0.50 mm	1) C3802160 Std.		
COK2134/4 1.00 mm	C3802132 0.50 mm		
COK2160F/4 Std.	C3802134 1.00 mm		
COK2132F/4 0.50 mm	Use 4		
COK2134F/4 1.00 mm	2) C3904166	Use 1	C4893693 Std. ● C4892795 0.25 mm ● C4892796 0.50 mm ● C4892797 0.75 mm ●
To order an In-Frame Kit change <u>OK</u> to <u>IK</u>			

* Piston Kit consists of:

1) 1 C3907163 Piston Std,	1 C3802230 Ring Set Std,	1 C3901793 Piston Pin, 2 C3901706 Ret.
2) 1 C3908815 Piston 0.50 mm,	1 C3802232 Ring Set 0.50 mm,	1 C3901793 Piston Pin, 2 C3901706 Ret.
3) 1 C3908816 Piston 1.00 mm,	1 C3802234 Ring Set 1.00 mm,	1 C3901793 Piston Pin, 2 C3901706 Ret.

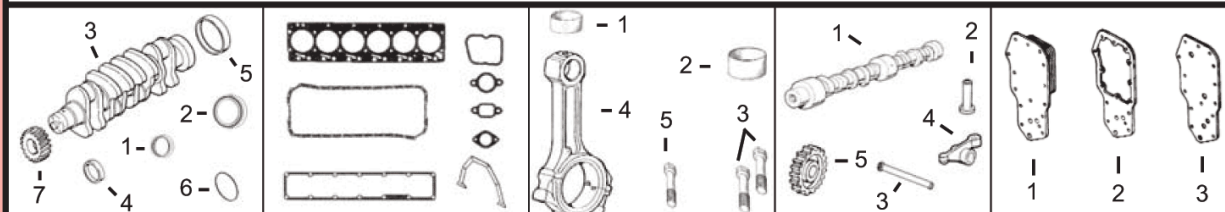

1) Front Seal 2) Rear Seal	1) Top Gasket Set 2) Bottom Gasket Set	1) Bushing, Piston 2) Bushing, Cam	1) Camshaft 2) Tappet 3) Push Rod 4) Rocker Arms 5) Camshaft Gear	1) Oil Cooler 7 Plate 2) Oil Cooler Gasket 3) Oil Cooler Gasket Filter Head
3) Crankshaft 4) Front Seal Sleeve 5) Rear Seal Sleeve 6) Rectangular Seal 7) Crankshaft, Gear	3) Head Gasket 4) Oil Pan Gasket 5) Valve Cover Gsk 6) Gear Housing Gsk 7) Rear Cover Gsk	3) Bolt, Con Rod 4) Con Rod 5) Bolt, Ex Manifold		

1) C3904353 2) C3353978 3) C3907803 4) C3906080 5) C3906081 6) C3912473 7) C3901258	1) C3804896 2) C3802375 3) C3921393 4) C3931602 5) C3902666 6) C3916131 7) C3928493	1) C4891178 x4 2) C3901306 x1 (3) 3) C3900919 x8 4) C3901569 (7) C4943979 (8) 5) C3944593	1) C3925582 (9) 2) C3925031 3) C3904679 4) C3910811 x4 C3910810 x4 5) C3907431	1) C3921557 2) C3926760 3) C3929792
---	---	--	---	---

	Guide, Valve	1) Intake, Valve Kit 2) Insert, Valve	1) Exhaust, Valve Kit 2) Insert, Valve	1) Spring, Valve 2) Seal, Valve 3) Retainer, Valve
	C3904408 Thick W. 60.50 mm IN C3904409 Thick W. 51.75 mm EX C3906206 (1) Thin Wall	1) C3802355 Kit Consists of: C3901117 Valve x1 C3900250 Collet x2 2) C3906854 Use 4	1) C3802356 Kit Consists of: C3901607 Valve x1 C3900250 Collet x2 2) C3904105 Use 4	1) C3900276 x8 2) C3921640 x8 (5) C3957912 x8 (6) 3) C3900299 x8 (5)

		<p>(●) On Fracture Split Con Rods use: 4 of C3901170 (or O/S) and 4 of C4893693 (or O/S).</p> <p>(1) Can be Used on Both Intake and Exhaust.</p> <p>(2) Diaphragm Style.</p> <p>(3) For Storm blocks use C3940059.</p> <p>(4) Do not use on Marine Engines.</p> <p>(5) For use on engines prior to April, 2003.</p> <p>(6) For use on engines from April, 2003, (Top Hat Style).</p> <p>(7) Machine split connecting rod.</p> <p>(8) Fracture split connecting rod.</p> <p>(9) Use ESN or application model to confirm correct camshaft.</p>
1) Water Pump 2) Water Pump Seal 3) Thermostat 1) C3286277 2) C3906698 3) C3802273	1) Pump, Oil 2a) Lift Pump 2b) Lift Pump 1) C3926202 2a) C3918000 2b) C3904374 (2)	1) Cylinder Head (With Valves) 2) Head Bolts 1) C3920005 (4) 2) C3920779 x4 C3920780 x10