

**Engine Model
CPL**

6B 5.9

(CDC 6.590)

NATURALLY ASPIRATED

NON - EMISSION

359 Cubic Inch

Piston Std (m): 6223

CUMMINS CPL's

- | | | |
|-------|-----|------|
| 596 | 802 | 1320 |
| 691 | 845 | 1403 |
| 714 * | 960 | 1433 |
| 791 * | 999 | |

* Marine Engine

CASE-IH (Agricultural)

- | | |
|------|---------|
| 5130 | Tractor |
| 5230 | " |

CASE (Construction)

- | | |
|--------|--------------|
| 680K/L | Backhoe |
| 850D/E | Crawler |
| 855D/E | " |
| W14B/C | Wheel Loader |

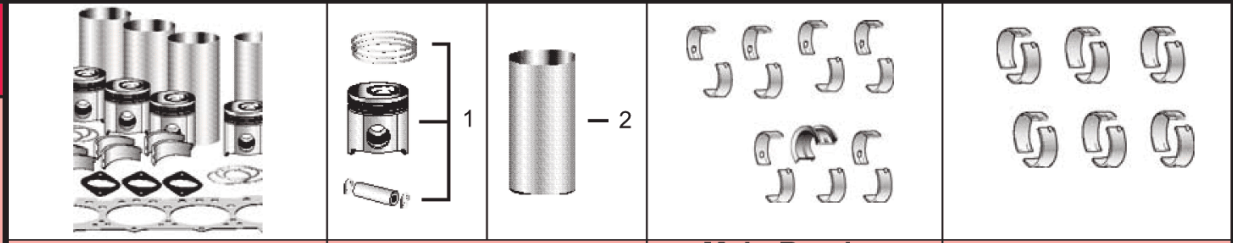

Eng. O/H & I/F Kit	1) Piston Kit *	Main Bearing Set	Con Rod Bearing
COK2060/6 Std.	2) Repair Sleeve	C3802070 Std. C3802071 0.25 mm C3802072 0.50 mm C3802073 0.75 mm	C3901170 Std. C3901171 0.25 mm C3901172 0.50 mm C3901173 0.75 mm
COK2062/6 0.50 mm	1) C3802060 Std.		
COK2064/6 1.00 mm	C3802062 0.50 mm C3802064 1.00 mm		
COK2060F/6 Std. ●	Use 6	Use 1	C4893693 Std. ● C4892795 0.25 mm ● C4892796 0.50 mm ● C4892797 0.75 mm ●
COK2062F/6 0.50 mm ●			
COK2064F/6 1.00 mm ●			
To order an In-Frame Kit change OK to IK			

* Piston Kit consists of:
 1) 1 [C3906223](#) Piston Std, 1 [C3802040](#) Ring Set Std, 1 [C3901793](#) Piston Pin, 2 [C3901706](#) Ret.
 2) 1 [C3906209](#) Piston 0.50 mm, 1 [C3802042](#) Ring Set 0.50 mm, 1 [C3901793](#) Piston Pin, 2 [C3901706](#) Ret.
 3) 1 [C3906208](#) Piston 1.00 mm, 1 [C3802044](#) Ring Set 1.00 mm, 1 [C3901793](#) Piston Pin, 2 [C3901706](#) Ret.

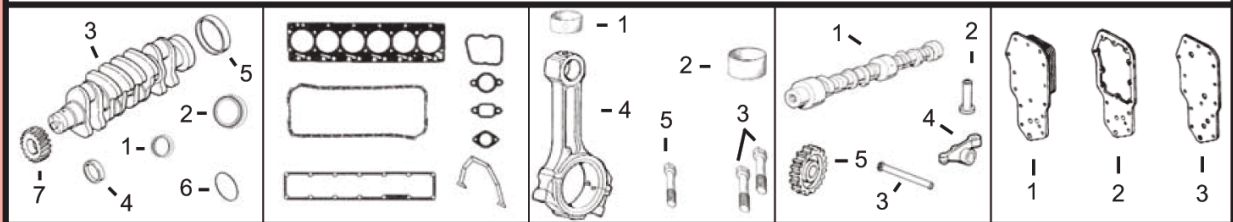

1) Front Seal 2) Rear Seal	1) Top Gasket Set 2) Bottom Gasket Set	1) Bushing, Piston 2) Bushing, Cam	1) Camshaft 2) Tappet 3) Push Rod 4) Rocker Arms 5) Camshaft Gear	1) Oil Cooler 7 Plate 2) Oil Cooler Gasket 3) Oil Cooler Gasket Filter Head
3) Crankshaft 4) Front Seal Sleeve 5) Rear Seal Sleeve 6) Rectangular Seal 7) Crankshaft, Gear	3) Head Gasket 4) Oil Pan Gasket 5) Valve Cover Gsk 6) Gear Housing Gsk 7) Rear Cover Gsk	3) Bolt, Con Rod 4) Con Rod 5) Bolt, Ex Manifold		
1) C3904353 2) C3353978 3) C3907804 4) C3906080 5) C3906081 6) C3912473 7) C3901258	1) C3802363 2) C3802376 3) C3921394 4) C3931346 (7) 5) C3902666 6) C3916131 7) C3928493	1) C4891178 x6 2) C3901306 x1 (3) 3) C3900919 x12 4) C3901569 (8) C4943979 (8) 5) C3944593	1) C3914639 2) C3925031 3) C3904679 4) C3910811 x6 C3910810 x6 5) C3907431	1) C3921558 2) C3926760 3) C3929792

	Guide, Valve	1) Intake, Valve Kit 2) Insert, Valve	1) Exhaust, Valve Kit 2) Insert, Valve	1) Spring, Valve 2) Seal, Valve 3) Retainer, Valve
	C3904408 Thick W. 60.50 mm IN C3904409 Thick W. 51.75 mm EX C3906206 (1) Thin Wall	1) C3802355 Kit Consists of: C3901117 Valve x1 C3900250 Collet x2 2) C3906854	1) C3802356 Kit Consists of: C3901607 Valve x1 C3900250 Collet x2 2) C3904105	1) C3900276 x12 2) C3921640 x12 (5) C3957912 x12 (6) 3) C3900299 x12 (5)

			(●) On Fracture Split Con Rods use: 6 of C3901170 (or O/S) and 6 of C4893693 (or O/S). (1) Can be Used on Both Intake and Exhaust. (2) Diaphragm Style. (3) For Storm blocks use C3940059 . (4) Do not use on Marine Engines. (5) For use on engines prior to April, 2003. (6) For use on engines from April, 2003, (Top Hat Style). (7) Applications with internally cast oil suction tube in Aluminum oil pan, must use 3938161 oil pan gasket. (8) C3901569 Machine Split rod. C4943979 Fracture Split rod.
1) Water Pump 2) Water Pump Seal 3) Thermostat	1) Pump, Oil 2a) Lift Pump 2b) Lift Pump	1) Cylinder Head (With Valves) 2) Head Bolts	
1) C3286277 2) C3906698 3) C3802273	1) C3926203 2a) C3918000 2b) C3904374 (2)	1) C3913381 (4) 2) C3920779 x6 C3920780 x14	