

300 Series
Engine & Equipment
Model

6.359D

6 Cyl

Bore: 4.19 in
 106.5 mm
 Pin Ø: 1.375 in
 35 mm

APPLICATIONS:

AGRICULTURAL

955	3040	3640
975	3050	4420
985	3140	4530
1055	3150	7440
1075	3155	7445
2940	3155TSS	9900
2950	3255	9910
2955	3350	9920

CONSTRUCTION

444D
 570B

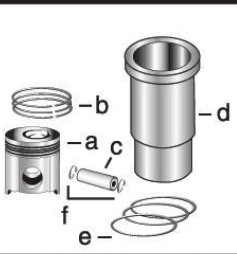

1) Engine O/H Kit	Piston-Liner Kit	Main Bearing	Thrust Bearing	Con Rod Bearing
2) Engine I/F Kit	TRE30250 Consists of:	TRE27352 Std.	TAT21139 Std.	TRE27348 Std.
1) TRE50784	a) TRE19282	TRE27353 .010	TAT21132 .010	TRE27349 .010
	b) TRE66820	TRE27360 .020	TAT21134 .020	TRE27358 .020
2) TIK50784	c) TR125754	TRE27368 .030	TAT21136 .030	TRE27364 .030
	d) TR116281			
	e) TAR65507			
	f) TM41029	Use 6	Use 1	Use 6

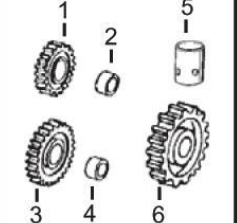
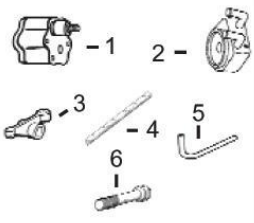
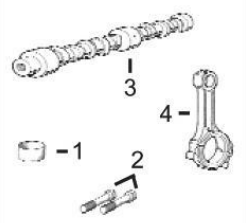
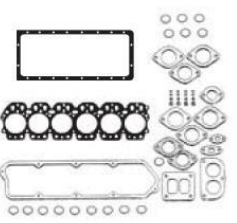
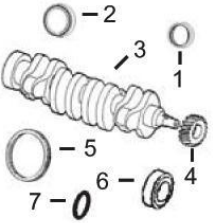

1) Front Seal 2) Rear Seal	1) O/H Gasket Set	1) Bush, Con Rod 2) Bolt, Con Rod	1) Pump, Oil 2) Oil Cooler 3) Rocker Arm 4) Rocker Shaft 5) Pump, Oil Tube 6) Cyl Hd Cap Screw	1) Lower Gear 2) Lower Bushing 3) Upper Gear 4) Upper Bushing 5) Cam. Follower 6) Cam. Gear
3) Crankshaft 4) Crankshaft, Gear 5) Ring Gear 6) Sleeve, Front 7) Packing, Sleeve	2) Head Gasket Set 3) Head Gasket 4) Oil Pan Gasket 5) Rocker Cover Gsk	3) Camshaft 4) Con Rod		

1) TAR67942 2) TRE44574 3) TAT22562 4) TT20094 5) TR28811 (129T) 6) TR81989 7) TH35244	1) TRE501580 2) TRE38852 3) TR114157 4) TR97344 5) TR75728	1) TR55647 x6 2) TR80033 x12 3) TR82821 (3) 4) TRE16495	1) TRE55343 (2) 2) TRE31929 3) TRE31973 4) TR54986 5) TR113752 6) TR85363 x26 (4)	1) TAT24252 2) TT26321 3) TAT18009 4) TT20034 5) TT20073 6) TT20070
-----------------------------------------------------------------------------------------------------------------------------------------------------------	-----------------------------------------------------------------------------------------------------------	----------------------------------------------------------------------------------------------	--------------------------------------------------------------------------------------------------------------------------------------------	------------------------------------------------------------------------------------------------------------------------------



Valve, Intake	Valve, Exhaust	Insert, Valve 1) Intake 2) Exhaust	1) Cap, Valve 2) Lock, Valve	1) Spring, Valve 2) Rotator, Valve 3) O'ring, Valve
TR79623 Std. TR79628 .003 TR79629 .015	TR79624 Std. TR79625 .003 TR79626 .015	1) TR73064 Std. 2) TR51734 Std.	1) TT20129 2) TT20077	1) TR26125 2) TRE11410 3) TR87627



Thermostat	TAR48675 180° F (1)
------------	----------------------------



Fuel Transfer Pump	TRE42211
--------------------	-----------------



Water Pump Repair Kit	
Without Impeller	With Impeller
See Chart	



Transmission Oil Pump	
TAL120106	TAL68094
Verify P/N for your application	

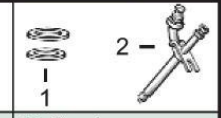

1) Seal 2) Injector, Pencil
1) TR60746 TR48000 2) TAR89564