

300 Series
Engine & Equipment
Model

4.239D

4 Cyl

Bore: 4.19 in
 106.5 mm
 Pin Ø: 1.375 in
 35 mm

APPLICATIONS:

AGRICULTURAL

- 940 2450
- 942 2535
- 1640 2550
- 1840 2555CS
- 2130 2650
- 2135 2730
- 2250 2735
- 2350 3330
- 2355 3430
- 2355CS 6602
- 2360

CONSTRUCTION

- 70 400G
- 70D 415B
- 210C 415C
- 244E 490
- 290D 515B
- 310C/D
- 315C

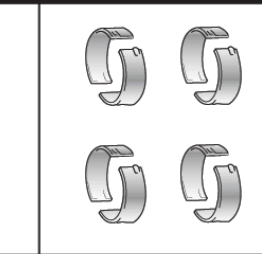
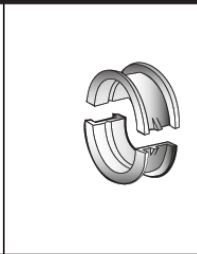
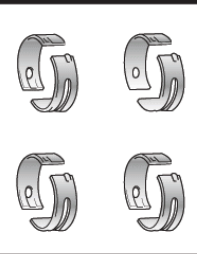
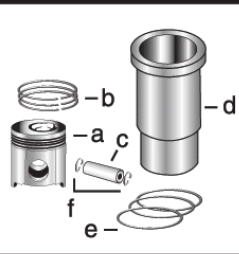
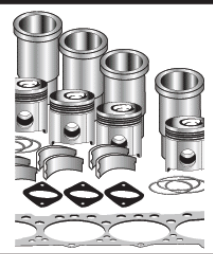

1) Engine O/H Kit **Piston-Liner Kit** **Main Bearing** **Thrust Bearing** **Con Rod Bearing**

2) Engine I/F Kit **TRE30250** **TRE27352** Std. **TAT21139** Std. **TRE27348** Std.

1) TAT86992 Consists of: **TRE27353** .010 **TAT21132** .010 **TRE27349** .010

2) TIK86992 a) **TRE19282** **TRE27360** .020 **TAT21134** .020 **TRE27358** .020

b) **TRE66820** **TRE27368** .030 **TAT21136** .030 **TRE27364** .030

c) **TR125754** **Use 4** **Use 1** **Use 4**

d) **TR116281**

e) **TAR65507**

f) **TM41029**

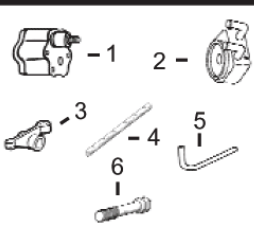
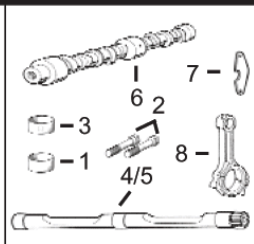
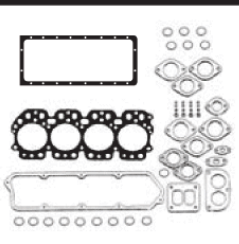
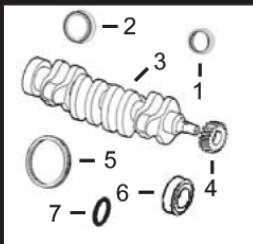

1) Front Seal **1) O/H Gasket Set** **1) Bush, Con Rod** **1) Pump, Oil**

2) Rear Seal **2) Head Gasket Set** **2) Bolt, Con Rod** **2) Oil Cooler**

3) Crankshaft **3) Head Gasket** **3) Bush, Bal. Shaft** **3) Rocker Arm**

4) Crankshaft, Gear **4) Oil Pan Gasket** **4) Bal. Shaft R/H** **4) Rocker Shaft**

5) Ring Gear **5) Rocker Cover Gsk** **5) Bal. Shaft L/H** **5) Pump, Oil Tube**

6) Sleeve, Front **6) Camshaft** **6) TR82820** (4) **6) Cyl Hd Cap Screw**

7) Packing, Sleeve **7) Bal. Shaft Stop** **7) TR88112** **1) Lower Gear**

1) TAR67942 **8) Con Rod** **8) TRE16495** **2) Lower Bushing**

2) TRE44574 **1) TRE501579** **1) TR55647 x4** **3) Upper Gear**

3) TAT18030 (1) **2) TRE38851** **2) TR80033 x8 (3)** **4) Upper Bushing**

or **TRE20585 (2)** **3) TR125863** **3) TR57160 x6 (5)** **5) Cam. Follower**

4) TT20094 **4) TR97342** **4) TRE26282 R/H (*)** **6) Cam. Gear**

5) TR114282 (142T) **5) TR26283 L/H (*)** **5) TR113752** **1) TAT24252**

6) TR81989 **6) TR82820 (4)** **6) TR85363 x18 (6)** **2) TT26321**

7) TH35244 **7) TR88112** **7) TR85363 x18 (6)** **3) TAT18009**

Valve, Intake **Valve, Exhaust** **Insert, Valve** **1) Cap, Valve**

1) Intake **1) Intake** **1) Intake** **2) Lock, Valve**

2) Exhaust **2) Exhaust** **2) Exhaust** **3) O'ring, Valve**

TR79623 Std. **TR79624** Std.

TR79628 .003 **TR79625** .003

TR79629 .015 **TR79626** .015

1) TR73064 Std. **1) TT20129**

2) TR51734 Std. **2) TT20077**

1) Thermostat

2) Thermostat Cover

1) TRE33705 180° F

2) TT23620

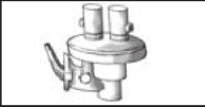

Fuel Transfer Pump

TRE42211



Water Pump Rep Kit

a) **TRE19507**

b) **TRE62658**



Water Pump

TAR97708 (m) R73604



Transmission Oil Pump

TAL120106 **TAL68094**

Verify P/N for your application

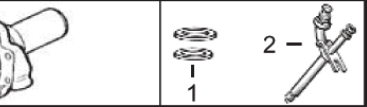

1) Seal

2) Injector, Pencil

1) TR60746

TR48000

2) TAR89564

(*) If these engines use bolt on weights shafts use **TAR69710** RH and **TAR69711** LH.
 (1) **TAT18030** Crankshaft 36mm (short) snout, (m) T23517.
 (2) **TRE20585** Crankshaft 60mm (long) snout, (m) R81959 or R121018.
 (3) For Connecting Rod (m) R58979, use **TR74194** Connecting Rod Bolt available upon request.
 (4) Threaded Type.
 (5) **TR91708** (Outer Diam. 2.00 mm / 0.078 in) Larger and **TR57160R** (Inner Diam 0.5 mm / 0.020 in) Smaller, are also available.
 (6) Replace all R78558 Cap Screws with Flanged Head Cap Screw **TR85363**.