

400 Series

Engine & Equipment
Model

6.466T

253,373 >

6.466A

317,859 >

6 Cyl

Bore: 4.56 in
116 mm
Pin Ø: 1.85 in
47 mm

Con Rod (m):
R71074 (P/N AR93341)

APPLICATIONS:

AGRICULTURAL

4250	5730
4440	6602
4450	6620
4640	6622
4650	7720
5460	9940
5720	9950

CONSTRUCTION

644C	790D
690C	850B
762A/B	892D
770A/B	

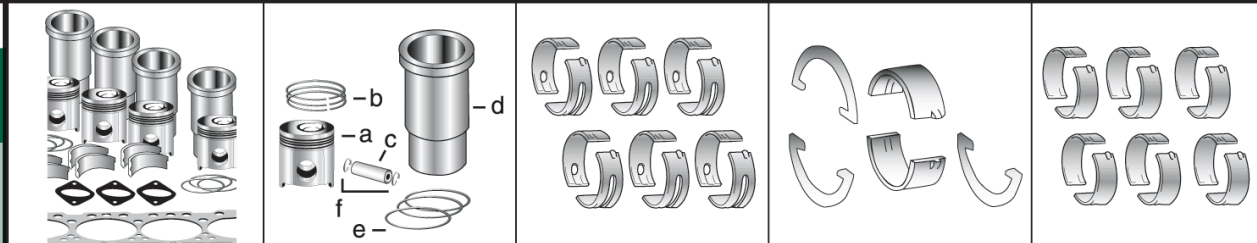



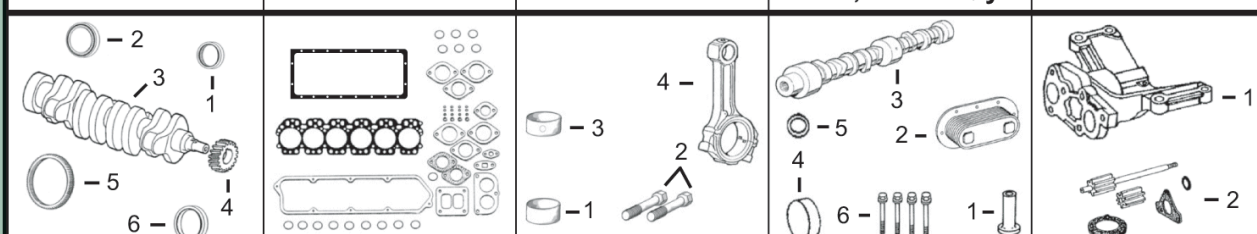

1) Engine O/H Kit	Piston-Liner Kit	Main Bearing	Thrust Bearing	Con Rod Bearing
2) Engine I/F Kit	TAR100646 Consists of: a) TAR100616 b) TRE48380 c) TR57771 d) TAR63060 e) TAR98850 f) TE1343FN	TAR74814 Std. TAR74816 .010 TAR74817 .020 TAR74818 .030 Use 6	TAR77748 Std. TAR77750 .010 TAR77751 .020 TAR77752 .030 Use 1 Thrust Washer TAR77747 Std. TAR77753 .007 Use 3, Order Qty 1	TAR73277 Std. TAR73279 .010 TAR73280 .020 TAR73281 .030 Use 6



1) Front Seal 2) Rear Seal	1) O/H Gasket Set	1) Bush, Con Rod 2) Bolt, Con Rod 3) Bushing, Cam	1) Cam Follower 2) Oil Cooler 3) Camshaft Kit 4) Plug, Camshaft 5) O'ring, Oil Cooler 6) Head Bolt Kit	1) Pump, Oil 2) Repair Kit
3) Crankshaft 4) Crankshaft, Gear 5) Ring Gear 6) Rear Gear	2) Head Gasket Set 3) Head Gasket 4) Oil Pan Gasket	4) Con Rod		
1) TAR49025 2) TRE520036 3) TRE53422 (6) 4) TR26049 (23T) 5) TR28811 (129T) 6) TR63326	1) TAR98845 2) TAR98851 3) TRE47336 4) TR71918	1) TR74008 x6 2) TR66452 x12 3) TR46903 x4 4) TAR93341 x1  (1)	1) TR52773 2) TAT25038 (5) 3) TAR100385 4) TR26115 5) TR47153 6) TMX365 (3)* TMX366 (4)**	1) TRE60622 2) TMX1062 (2)

	Valve, Intake	Valve, Exhaust	Insert, Valve 1) Intake 2) Exhaust	1) Cap, Valve 2) Lock, Valve	1) Spring, Valve 2) Rotator, Valve 3) O'ring, Valve
	TR50358 Std. TR55055 .003 TR55057 .015	TR50357 Std. TR55056 .003 TR55058 .015	1) TR78702 Std. 2) TR50356 Std.	1) TT20129 2) TT20077	1) TR26125 2) TRE11410 3) TR87627

				
Thermostat	Fuel Transfer Pump	Water Pump Rep Kit a) Without Impeller b) With Impeller	Water Pump	Pump, Oil, Quad Transmission
TAR48675 180° F	Not Used	See Chart	1) TRE55985 (m) R71224, (m) R83561 2) TRE20022 (OEM ESN 067685 >)	TRE20918 For Tractors 4250, 4040, 4450, 4640, 4650

(1) Shape, Conrod Bushing.
 (2) For Crankshaft driven Engine Pump, Oil Consists of: Shaft, Gears, and Gaskets.
 (3) [TMX365](#) Consists of: [TR88042](#) x6, [TR88043](#) x5, [TR88044](#) x8, [TR88045](#) x7. * With ESN > 317676.
 (4) [TMX366](#) Consists of: [TR88043](#) x11, [TR88044](#) x8, [TR88045](#) x7. ** With ESN 317677 >.
 (5) Some applications use [TAR55394](#).
 (6) [TRE53422](#) will require front key [TR116311](#) for the front damper.