

400 Series
Engine & Equipment
Model
6.466T

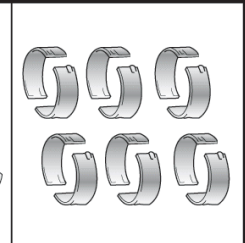
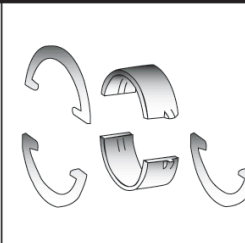
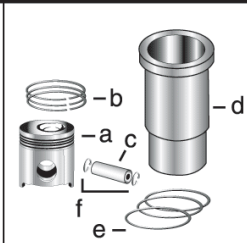

1) Engine O/H Kit	Piston-Liner Kit	Main Bearing	Thrust Bearing	Con Rod Bearing
--------------------------	-------------------------	---------------------	-----------------------	------------------------

253,373 >

6.466A

2) Engine I/F Kit	TAR100646 Consists of:	TAR74814 Std. TAR74816 .010 TAR74817 .020 TAR74818 .030	TAR77748 Std. TAR77750 .010 TAR77751 .020 TAR77752 .030	TAR73277 Std. TAR73279 .010 TAR73280 .020 TAR73281 .030
--------------------------	----------------------------------	--	--	--

317,859 >

1) TRG18847	a) TAR100616 b) TRE48380 c) TR57771 d) TAR63060 e) TAR98850 f) TE1343FN	Use 6	Use 1 Thrust Washer TAR77747 Std. TAR77753 .007	Use 6
--------------------	--	--------------	--	--------------

6 Cyl

2) TIK18847			Use 3, Order Qty 1	
--------------------	--	--	---------------------------	--

Bore: 4.56 in
116 mm
Pin Ø: 1.85 in
47 mm

Con Rod (m):
R71074 (P/N AR93341)

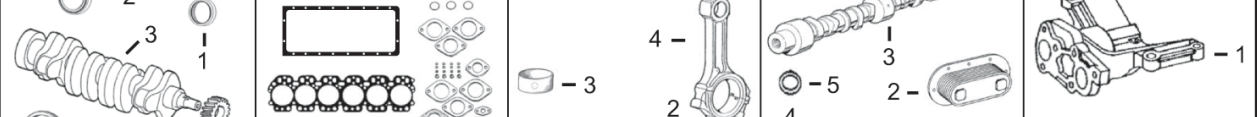

APPLICATIONS:

1) Front Seal 2) Rear Seal	1) O/H Gasket Set	1) Bush, Con Rod 2) Bolt, Con Rod 3) Bushing, Cam	1) Cam Follower 2) Oil Cooler 3) Camshaft Kit 4) Plug, Camshaft 5) O'ring, Oil Cooler 6) Head Bolt Kit	1) Pump, Oil 2) Repair Kit
---	--------------------------	--	---	---

AGRICULTURAL
4250 5730
4440 6602
4450 6620
4640 6622
4650 7720
5460 9940
5720 9950

3) Crankshaft 4) Crankshaft, Gear 5) Ring Gear 6) Rear Gear	2) Head Gasket Set 3) Head Gasket 4) Oil Pan Gasket	4) Con Rod		
1) TAR49025 2) TRE520036 3) TRE53422 (6) 4) TR26049 (23T) 5) TR28811 (129T) 6) TR63326	1) TAR98845 2) TAR98851 3) TRE47336 4) TR71918	1) TR74008 x6 2) TR66452 x12 3) TR46903 x4 4) TAR93341 x1  (1)	1) TR52773 2) TAT25038 (5) 3) TAR100385 4) TR26115 5) TR47153 6) TMX365 (3)* TMX366 (4)**	1) TRE60622 2) TMX1062 (2)

CONSTRUCTION
644C 790D
690C 850B
762A/B 892D
770A/B



Valve, Intake	Valve, Exhaust	Insert, Valve 1) Intake 2) Exhaust	1) Cap, Valve 2) Lock, Valve	1) Spring, Valve 2) Rotator, Valve 3) O'ring, Valve
TR50358 Std. TR55055 .003 TR55057 .015	TR50357 Std. TR55056 .003 TR55058 .015	1) TR78702 Std. 2) TR50356 Std.	1) TT20129 2) TT20077	1) TR26125 2) TRE11410 3) TR87627

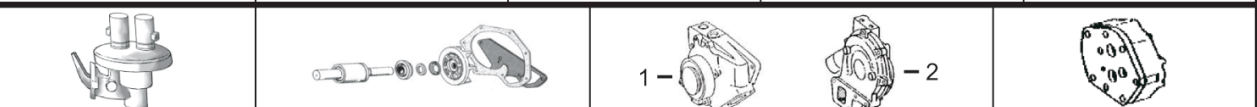

Thermostat TAR48675 180° F	Fuel Transfer Pump Not Used	Water Pump Rep Kit a) Without Impeller b) With Impeller See Chart	Water Pump 1) TRE55985 (m) R71224, (m) R83561 2) TRE20022 (OEM ESN 067685 >)	Pump, Oil, Quad Transmission TRE20918 For Tractors 4250, 4040, 4450, 4640, 4650
---	---	---	---	--

(1) Shape, Conrod Bushing.
(2) For Crankshaft driven Engine Pump, Oil Consists of: Shaft, Gears, and Gaskets.
(3) **TMX365** Consists of: **TR88042** x6, **TR88043** x5, **TR88044** x8, **TR88045** x7. * With ESN > 317676.
(4) **TMX366** Consists of: **TR88043** x11, **TR88044** x8, **TR88045** x7. ** With ESN 317677 >.
(5) Some applications use **TAR55394**.
(6) **TRE53422** will require front key **TR116311** for the front damper.