

300 Series
Engine & Equipment
Model
6.359T



6 Cyl

Bore: 4.19 in
 106.5 mm
 Pin Ø: 1.62 in
 41 mm

APPLICATIONS:

AGRICULTURAL

3140C 7445
 3540 7484
 3550 9400
 4050 9930
 7200

CONSTRUCTION

444D
 544E/EH/G
 570B
 710B/C

1) Engine O/H Kit	Piston-Liner Kit	Main Bearing	Thrust Bearing	Con Rod Bearing
2) Engine I/F Kit	TRE33115 Consists of:	TRE27352 Std.	TAT21139 Std.	TRE27348 Std.
1) TRE50783	a) TRE19278	TRE27353 .010	TAT21132 .010	TRE27349 .010
2) TIK50783	b) TRE66820	TRE27360 .020	TAT21134 .020	TRE27358 .020
	c) TR124230	TRE27368 .030	TAT21136 .030	TRE27364 .030
	d) TR116281			
	e) TAR65507			
	f) TR54114	Use 6	Use 1	Use 6

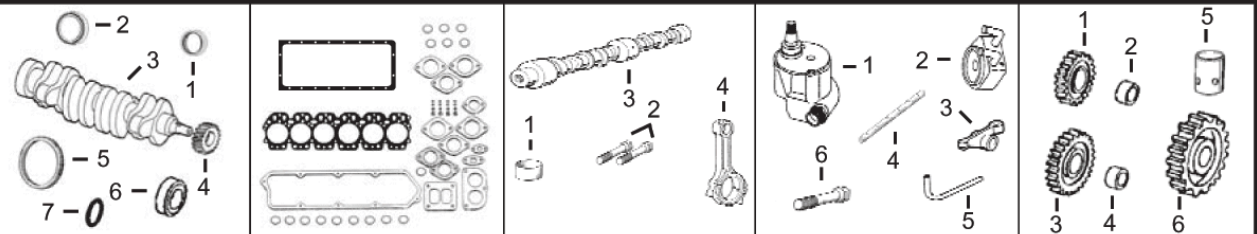

1) Front Seal 2) Rear Seal	1) O/H Gasket Set	1) Bush, Con Rod 2) Bolt, Con Rod	1) Pump, Oil 2) Oil Cooler 3) Rocker Arm 4) Rocker Shaft 5) Pump, Oil Tube 6) Cyl Hd Cap Screw	1) Lower Gear 2) Lower Bushing 3) Upper Gear 4) Upper Bushing 5) Cam. Follower 6) Cam. Gear
3) Crankshaft 4) Crankshaft, Gear 5) Ring Gear 6) Sleeve, Front 7) Packing, Sleeve	2) Head Gasket Set 3) Head Gasket 4) Oil Pan Gasket 5) Rocker Cover Gsk	3) Camshaft 4) Con Rod		
1) TAR67942 2) TRE44574 3) TAT22562 4) TT20094 5) TR28811 (129T) or TR114282 (142T) 6) TR81989 7) TH35244	1) TRE501580 2) TRE38852 3) TR114157 4) TR97344 5) TR75728	1) TR57451 x6 2) TR80033 x12 3) TR82821 (6) 4) TRE58347	1) TRE65580 (3) 2) TRE31929 3) TRE31973 (5) 4) TR54986 5) TR113752 6) TR85363 x26 (1)	1) TAT24252 2) TT26321 3) TAT18009 4) TT20034 5) TT20073 6) TT20070



Valve, Intake	Valve, Exhaust (4)	Insert, Valve 1) Intake 2) Exhaust	1) Cap, Valve 2) Lock, Valve	1) Spring, Valve 2) Rotator, Valve 3) O'ring, Valve
TR83071 Std. TR89223 .003 TR89224 .015	TR79624 Std. TR79625 .003 TR79626 .015	1) TR73064 Std. 2) TR51734 Std.	1) TT20129 2) TT20077	1) TR26125 2) TRE11410 3) TR87627

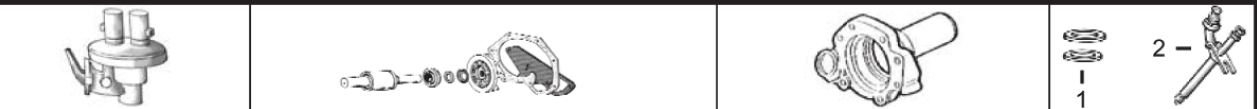

Thermostat	Fuel Transfer Pump	Water Pump Repair Kit		Transmission Oil Pump
TAR48675 180° F (2)	TRE42211	Without Impeller	With Impeller	TAL120106
		See Chart		1) Seal 2) Injector, Pencil
				1) TR60746 TR48000 2) TR37503
				Verify P/N for your application

(1) Replace all R78558 Cap Screws with Flanged Head Cap Screw **TR85363**.
 (2) Saran engines may use **TRE64354**.
 (3) Some Engine Models may use Standard Capacity Pump, Oil **TRE55343**.
 (4) Do not use 45° Valves with RE56545 Head.
 (5) To ESN 379968.
 (6) Threaded Type.