

**Engine & Equipment
Application**

1004.40T

**TURBOCHARGED /
INTERCOOLED**

4 Cyl, Lip Seal

Bore: 3.9370 in
100.00 mm

Stroke: 5.00 in
127.00 mm

GRADE "L"

Piston height: 70.161 mm
2.762 in

APPLICATIONS:

YE Builds and some **YD**
builds used in **Emission
Controlled** Areas

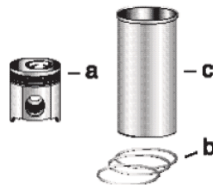

**1) Engine O/H
Kit**

Piston-Liner Kit

**Main Bearing
Set**

**Con Rod Bearing
Set**

**Thrust Washer
Set**

**2) Basic Engine
Kit**

PCK624

Consists of:

- a) PU5LF0024
- b) P4181A026
- c) P3135X062 (1)

4 Per Engine

- P81558 Std.
- P81558A .010
- P81558B .020
- P81558C .030

Set of 5 Pairs

- PU5ME0006 Std.
- PU5ME0006A .010
- PU5ME0006B .020
- PU5ME0006C .030

Set of 4 Pairs

P31137551/61

Set of 2 Pairs

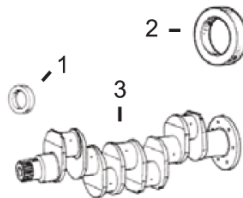

**1) Front Seal
2) Rear Seal**

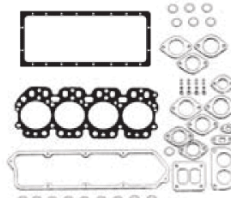

**1) Top Gasket Set
2) Bottom Gasket
3) Valve Cover Gsk**

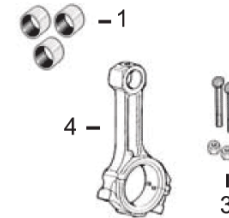

**1) Bush, Con Rod
2) Bolt, Con Rod
3) Dowel, Con Rod**

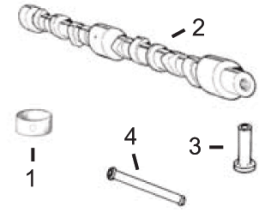

1) Bushing, Cam
2) Camshaft
3) Tappet
4) Push Rod

3) Crankshaft Kit

**4) Head Gasket
5) Oil Pan Set**

4) Con Rod

- 1) P2418F436
- 2) P2418F475
- 3) PZZ90212

- 1) PU5LT0178
- 2) PU5LB0152
- 3) P3681A021
- 4) P3681E025
- 5) PU5MK0600

- 1) P3112E005 x4 (2)
- 2) P32186142 x8
- 3) P3246A001 x8
- 4) PZZ90146

- 1) P31134132 x1
- 2) P31415361
- 3) P31434163
- 4) P31434307

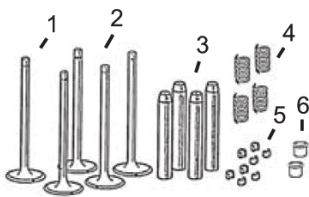

Valve Train Kit

**1) Valve, Intake
2) Valve, Exhaust**

**3) Guide, Valve
a) Intake
b) Exhaust**

**4) Spring, Valve
a) Inner
b) Outer**

**5) Lock, Valve
6) Seal, Valve**

PVTK417

- 1) P3142L072 x4
- 2) P3142A051 x4

- a) P3343F002 x4
- b) P3343J002 x4

- a) P31744133 x8
- b) P31745122 x8

- 5) P33173108 x16
- 6) P33817117 x8

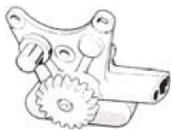

Oil Pump

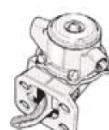

Lift Pump

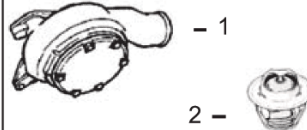

**1) Water Pump
2) Thermostat**

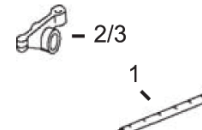

**1) Rocker Shaft
2) Rocker Arm LH
3) Rocker Arm RH**



**1) Cylinder Head
2) Glowplug**

P4132F056

P2641A067

- 1) P4131E012
- 2) P2485613

- 1) PZZ90032
- 2) P41151483
- 3) P41151484

- 1) N/A
- 2) P2666108
(Bayonet Fitting)

(1) Flanged, Semi Finished Liner available, P3135X063.

(2) Use with Con Rod PZZ90146.

(3) 30° Angle.