

**Engine & Equipment Application**

**1004.40**

**NATURALLY ASPIRATED**

**4 Cyl, Lip Seal**

**Kits include both rear seals**

Bore: 3.937 in  
100 mm

**APPLICATIONS:**

**HYSTER**  
H70-155XL (AA70218)  
S80-S155XL (AA70216)

**JCB**  
3CX Backhoe (AA50508)  
Backhoe Loader (AA50608)

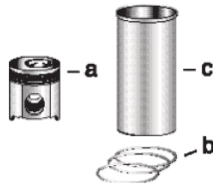

**1) Engine O/H Kit**

**Piston-Liner Kit**

**Main Bearing Set**

**Con Rod Bearing Set**

**Thrust Washer Set**

**2) Basic Engine Kit**

**PCK142**  
Consists of:  
a) [PMXF0015](#)  
b) [P4181A019](#)  
c) [P3135X042](#) (1)  
**4 Per Engine**

[P81558](#) Std.  
[P81558A](#) .010  
[P81558B](#) .020  
[P81558C](#) .030  
**Set of 5 Pairs**

[P85042](#) Std.  
[P85042A](#) .010  
[P85042B](#) .020  
[P85042C](#) .030  
**Set of 4 Pairs**

[P31137551/61](#)  
**Set of 2 Pairs**

**1) POK470**

**2) PBK470**

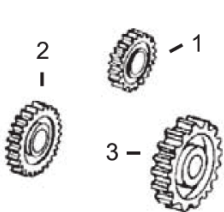
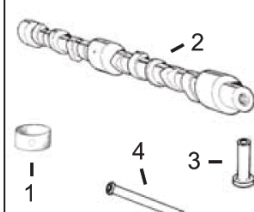
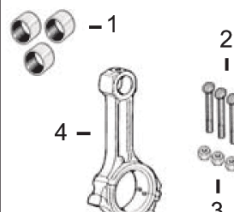
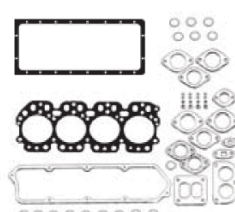
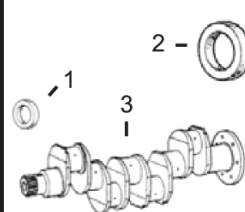

**1) Front Seal**  
**2) Rear Seal**

**1) Top Gasket Set**  
**2) Bottom Gasket**  
**3) Valve Cover Gsk**

**1) Bush, Con Rod**  
**2) Bolt, Con Rod**  
**3) Nut, Con Rod**

**1) Bushing, Cam**  
2) Camshaft  
3) Tappet  
4) Push Rod

1) Crankshaft Gear  
2) Camshaft Gear  
3) Idler Gear

**3) Crankshaft Kit**

4) Head Gasket  
5) Oil Pan Set

4) Con Rod

1) [P2418F436](#)  
2) [P2418F475](#) (3)  
[P2418F701](#) (4)  
3) [PZZ90202](#)

1) [PU5LT0178](#)  
2) [PU5LB0151](#)  
3) [P3681A021](#)  
4) [P3681E025](#)  
5) [PU5MK0600](#)

1) [P31134123](#) x4  
2) [P32762144](#) x8  
3) [P33221328](#) x8  
4) [PZZ90009](#)

1) [P31134132](#) x1  
2) [P31415361](#)  
3) [P31434163](#)  
4) [P31434307](#)

1) N/A  
2) [P31171353](#)  
3) N/A

**Valve Train Kit**

1) Valve, Intake  
2) Valve, Exhaust

3) Guide, Valve  
a) Intake  
b) Exhaust

4) Spring, Valve (2)  
a) Inner  
b) Outer

5) Lock, Valve  
6) Seal, Valve

**PVTK415**

1) [P3142L051](#) x4  
2) [P3142A051](#) x4

a) [P3343F002](#) x4  
b) [P3343J002](#) x4

a) [P31744133](#) x8  
b) [P31745122](#) x8

5) [P33173108](#) x16  
6) [P33817117](#) x8

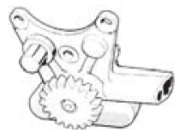
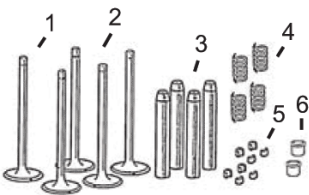

Oil Pump

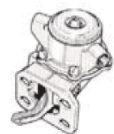

Lift Pump

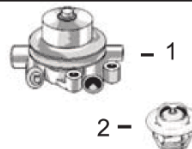

1) Water Pump  
2) Thermostat

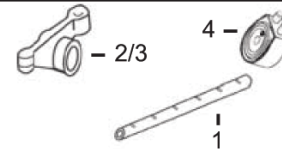

1) Rocker Shaft  
2) Rocker Arm LH  
3) Rocker Arm RH  
4) Oil Cooler



1) Cylinder Head  
2) Glowplug

[P4132F051](#)

[P2641A067](#)

1) [P4131E012](#)  
2) [P2485613](#)

1) [PZZ90032](#)  
2) [P41151483](#)  
3) [P41151484](#)  
4) [P2486A222](#) (5)

1) N/A  
2) [P2666108](#)  
(Bayonet Fitting)

(1) Flanged, Semi Finished Liner available, [P3135X041](#).

(2) Use Single Spring, Valve [P3174P405](#) for low speed applications (Not included in Kit).

(3) To ESN U176356H.

(4) From ESN U176357H.

(5) Applies to AA50608 ONLY.