

**Engine & Equipment Application**

**1004.42**

**NATURALLY ASPIRATED**

**4 Cyl, Lip Seal**

**Kits include both rear seals**

**Sleeveless Engines**

Bore: 4.055 in  
103 mm

**ENGINES BUILDS**

4.421 AR  
N4.421 AS

**APPLICATIONS:**

JCB (AR50690)

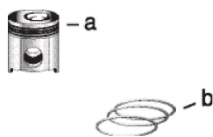

**1) Engine O/H Kit**

**a) Piston  
b) Ring Set**

**Main Bearing Set**

**Con Rod Bearing Set**

**Thrust Washer Set**

**2) Basic Kit**

a) [PU5LP0058](#) Std.  
[PU5LP0058B](#) 0.50  
[PU5LP0058D](#) 1.00  
b) [P4181A045](#) Std.  
[P4181A046](#) 0.50  
[P4181A047](#) 1.00  
**4 Per Engine**

[P81558](#) Std.  
[P81558A](#) .010  
[P81558B](#) .020  
[P81558C](#) .030  
**Set of 5 Pairs**

[P85042](#) Std. (5)  
[P85042A](#) .010  
[P85042B](#) .020  
[P85042C](#) .030  
**Set of 4 Pairs**

[P31137551/61](#)  
**Set of 2 Pairs**

1) [POK474](#) Std.  
[POK475](#) 0.50  
[POK476](#) 1.00

2) [PBK474](#) Std.  
[PBK475](#) 0.50  
[PBK476](#) 1.00

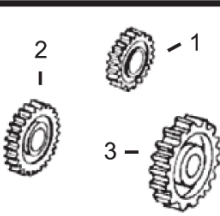
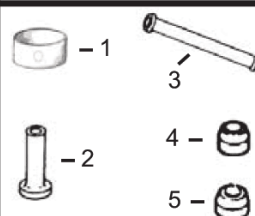
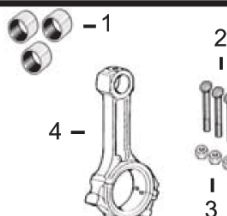
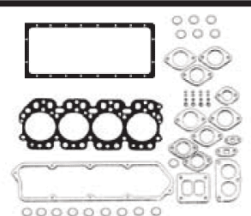
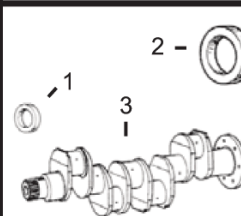

**1) Front Seal  
2) Rear Seal**

**1) Top Gasket Set  
2) Bottom Gasket**

**1) Bush, Con Rod  
2) Bolt, Con Rod  
3) Nut, Con Rod**

**1) Bushing, Cam**  
2) Tappet  
3) Push Rod  
4) Seal, Exhaust Valve  
5) Seal, Intake Valve

1) Crankshaft Gear  
2) Camshaft Gear  
3) Idler Gear

3) Crankshaft Kit

3) Head Gasket  
4) Valve Cover Gsk

4) Con Rod

1) [P2418F436](#)  
2) [P2418F475](#) (1)  
[P2418F701](#) (2)  
3) [PZZ90202](#) (6)  
[PZZ90226](#) (6)

1) [PU5LT0317](#)  
2) [PU5LB1171](#) (7)  
3) [P3681E042](#)  
4) [P3681A049](#)

1) [P3112E011](#) x4  
2) [P32762144](#) x8  
[P3212V003](#) x8 (3)  
3) [P33221328](#) x8  
4) [P4115C314](#) (4)

1) [P31134132](#) x1  
2) [P31434163](#)  
3) [P31434307](#)  
4) [P2418M505](#) x4  
5) [P2418M506](#) x4

1) [P31171681](#)  
2) [P3117L023](#)  
3) N/A

**Valve Train Kit**

1) Valve, Intake  
2) Valve, Exhaust

3) Guide, Valve  
a) Intake  
b) Exhaust

4) Spring, Valve

5) Lock, Valve

[PVTK422](#)

1) [P3142H041](#) x4  
2) [P3142D061](#) x4

a) [P3313A012](#) x4  
b) [P3318A705](#) x4

4) [P3174P412](#) x8

5) [P3142W004](#) x16

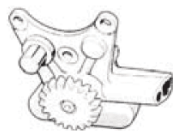
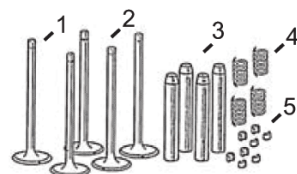

Oil Pump

[P4132F051](#)

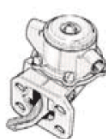

Lift Pump

[P2641A067](#)

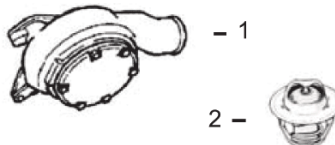

1) Water Pump  
2) Thermostat

1) [PU5MW0192](#)  
2) [P2485C036](#)

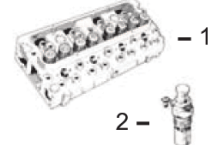

1) Cylinder Head  
2) Glowplug

1) N/A  
2) [P2666108](#)  
(Bayonet Fitting)

(1) To ESN U176356H.  
(2) From ESN U176357H.  
(3) Use with fractured split conrod.  
(4) Grade 1, Color Coded Green

(5) Use Con Rod Bearing Set, [PU5ME0013](#), from ESN U284278J. Order [POK473/45NB](#) or /30NB or [PBK473NB](#) and nominate the bearings.  
(6) [PZZ90202](#) To ESN U284277J and [PZZ90226](#) From ESN U284278J.  
(7) Max use Bottom Gasket Set [PU5LP0058D](#)