

**Engine & Equipment  
Application**

**1006.60T**

**TURBOCHARGED**

**6 Cyl, Lip Seal**

Kits include both rear seals

Bore: 3.9370 in  
100.00 mm

From ESN 557977X

**APPLICATIONS:**

**JCB**  
435 Front Loader (YB50292)

**MF AGRICULTURAL**  
3625 (YB31245)

**PERKINS USA**  
Power Units (YB30127)

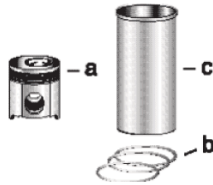

**1) Engine O/H Kit**

**Piston-Liner Kit**

**Main Bearing Set**

**Con Rod Bearing Set**

**Thrust Washer Set**

**2) Basic Engine Kit**

**PCK275**  
Consists of:  
a) PMXF0014  
b) P4181A026  
c) P3135X042 (3)  
**6 Per Engine**

PU5MB0030 Std.  
PU5MB0030A .010  
PU5MB0030B .020  
PU5MB0030C .030  
**Set of 7 Pairs**

PU5ME0003 Std.  
PU5ME0003A .010  
PU5ME0003B .020  
PU5ME0003C .030  
**Set of 6 Pairs**

P31137551/61  
**Set of 2 Pairs**

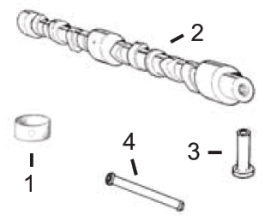
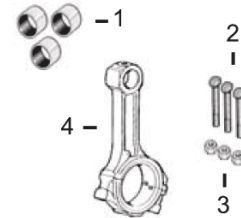
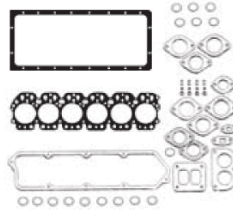
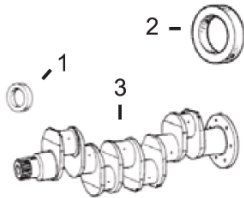

**1) Front Seal**  
**2) Rear Seal**

**1) Top Gasket Set**  
**2) Bottom Gasket**

**1) Bush, Con Rod**  
**2) Bolt, Con Rod**  
**3) Nut, Con Rod**

**1) Bushing, Cam**

**3) Crankshaft Kit**

**3) Head Gasket**

**4) Con Rod**

**2) Camshaft**  
**3) Tappet**  
**4) Push Rod**

1) P2418F436  
2) P2418F475 (4)  
P2418F701 (5)  
3) PZZ90085

1) PU5LT1179  
2) PU5LB0153  
3) P3681H205

1) P31134131 x6  
2) P32762144 x12  
3) P33221328 x12  
4) PZZ90013 (1)

1) P31134132 x1  
2) P31416307  
3) P31434163  
4) P31434307

**Valve Train Kit**

1) Valve, Intake  
2) Valve, Exhaust

3) Guide, Valve  
a) Intake  
b) Exhaust

4) Spring, Valve  
a) Inner  
b) Outer

5) Lock, Valve  
6) Seal, Valve

**PVTK614**

1) P3142L072 x6 (2)  
2) P3142A051 x6

a) P3343F002 x6  
b) P3343J002 x6

a) P31744133 x12  
b) P31745122 x12

5) P33173108 x24  
6) P33817117 x12

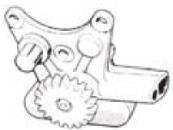
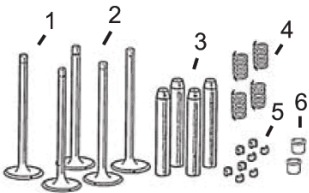

Oil Pump

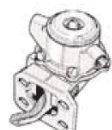

Lift Pump

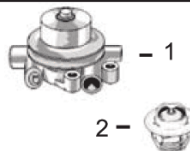

1) Water Pump  
2) Thermostat

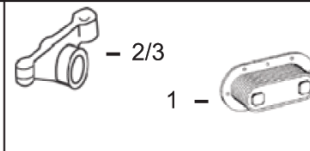

1) Oil Cooler  
2) Rocker Arm LH  
3) Rocker Arm RH

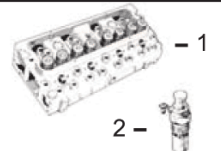

1) Cylinder Head  
2) Glowplug

P4132F057

P2641729

1) PU5MW0092  
2) P2485613

1) P2486A992 (6)  
2) P41151483  
3) P41151484

1) N/A  
2) P2666108  
(Bayonet Fitting)

(1) Check with Build List.

(2) 30° Angle.

(3) Flanged, Semi Finished Liner available, P3135X041.

(4) To ESN U764751H.

(5) From ESN U764752H.