

**Engine & Equipment Application**

**1104A - 44T**  
(RS)

**TURBOCHARGED**

Bore: 4.133 in  
105.00 mm

Stroke: 5.00 in  
127.00 mm

Displacement: 269 in<sup>3</sup>  
4.4 Liter

**APPLICATIONS:**

**GENSETS**



<b>1) Engine O/H Kit</b>	<b>Piston &amp; Ring Kit</b>	<b>Main Bearing Set</b>	<b>Con Rod Bearing Set</b>	<b>Thrust Washer Set</b>			
<b>2) Basic Kit</b>	<a href="#">P4115P025</a> Std.	<a href="#">PU5MB0018</a> Std.	<a href="#">PU5ME0013</a> Std.	<a href="#">P31137551/61</a>			
<b>1) <a href="#">POK424</a> Std.</b>	<b>4 Per Engine</b>	<b>Set of 5 Pairs</b>	<b>Set of 4 Pairs</b>	<b>Set of 2 Pairs</b>			
<b><a href="#">POK425</a> 0.50</b>					<a href="#">P4115P026</a> 0.50 mm	<a href="#">PU5MB0018A</a> .010	<a href="#">PU5ME0013A</a> .010
<b><a href="#">POK426</a> 1.00</b>					<a href="#">P4115P027</a> 1.00 mm	<a href="#">PU5MB0018B</a> .020	<a href="#">PU5ME0013B</a> .020
<b>2) <a href="#">PBK424</a> Std.</b>		<a href="#">PU5MB0018C</a> .030	<a href="#">PU5ME0013C</a> .030				
<b><a href="#">PBK425</a> 0.50</b>							
<b><a href="#">PBK426</a> 1.00</b>							

\* **Piston Kit consists of:**

- |   |  |
|---|--|
| 1) 1 X <a href="#">PMXFP025</a> Piston Std,     | 1 X <a href="#">PUPRK0002</a> Ring Set Std.      |
| 2) 1 X <a href="#">PMXFP026</a> Piston 0.50 mm, | 1 X <a href="#">PUPRK0002B</a> Ring Set 0.50 mm. |
| 3) 1 X <a href="#">PMXFP027</a> Piston 1.00 mm, | 1 X <a href="#">PUPRK0002D</a> Ring Set 1.00 mm. |

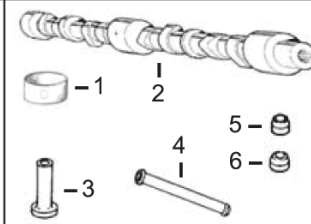
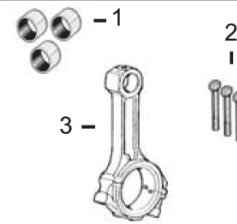
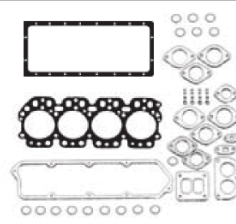
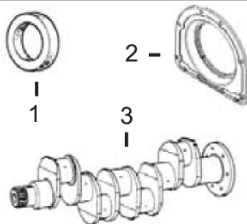

<b>1) Front Seal</b> <b>2) Rear Seal</b>	<b>1) Top Gasket Set</b> <b>2) Bottom Gasket</b>	<b>1) Bush, Con Rod</b> <b>2) Bolt, Con Rod</b>	<b>1) Bushing, Cam</b>
3) Crankshaft Kit	3) Head Gasket 4) Valve Cover Gasket 5) Oil Pan Gasket	3) Con Rod Kit	2) Camshaft 3) Tappet 4) Pushrod 5) Seal, Exhaust Valve 6) Seal, Intake Valve
1) <a href="#">P2418F436</a> 2) <a href="#">P2418F704</a> 3) <a href="#">PZZ90239</a>	1) <a href="#">PU5LT0357</a> 2) <a href="#">PU5LB0381</a> 3) <a href="#">P3681E051</a> 4) <a href="#">P3681A055</a> 5) <a href="#">P3681K037</a>	1) <a href="#">P3112A005</a> x4 2) <a href="#">P3212V003</a> x8 3) <a href="#">P4115C314</a> (2)	1) <a href="#">P3112D071</a> x1 2) <a href="#">P3141D211</a> 3) <a href="#">P31434163</a> 4) <a href="#">P31434307</a> 5) <a href="#">P2418M517</a> x4 6) <a href="#">P2418M519</a> x4

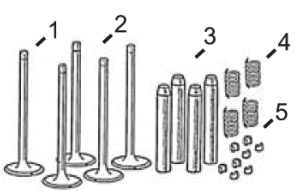

<b>Valve Train Kit</b>	1) Valve, Intake 2) Valve, Exhaust	3) Guide, Valve (Intake & Exhaust)	4) Spring, Valve	5) Lock, Valve
<b><a href="#">PVTK425</a></b>	1) <a href="#">P3142H071</a> x4 2) <a href="#">P3142A151</a> x4	3) <a href="#">P3313A012</a> x8	4) <a href="#">P3174A016</a> x8	5) <a href="#">P3142W004</a> x16

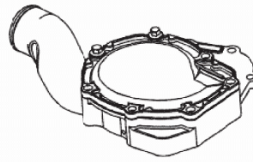
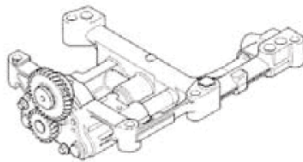

Oil Pump

Water Pump

Water Pump Gasket

[P4132F071](#) (1)

[PU5MW0194](#)

[P3682A011](#)

(1) Not to be used on engines with balancer units.  
(2) Grade J, Color Coded Green.