

Engine & Equipment Application



1104C - 44
(RE)

1104C - E44
(RF)

1104A - 44
(RR)

NATURALLY ASPIRATED
Bore: 4.133 in
105.00 mm

Stroke: 5.00 in
127.00 mm

Displacement: 269 in³
4.4 Liter

APPLICATIONS:

AGRICULTURAL

AGCO

- 3435S/F/V (RE37990)
- 3435GE/GEV (RE37990)
- 3425C (RE38157)
- 471 (RE37827)
- 481 (RE37830)
- 5425 (RE37873/RE37917)
- 5435 (RE37831/RE37919)

JCB
Telehandler (RE51141)

1) Engine O/H Kit	Piston & Ring Kit	Main Bearing Set	Con Rod Bearing Set	Thrust Washer Set			
2) Basic Kit	P4115P011 Std.	PU5MB0018 Std.	PU5ME0013 Std.	P31137551/61			
1) POK480 Std.	4 Per Engine	Set of 5 Pairs	Set of 4 Pairs	Set of 2 Pairs			
POK481 0.50					P4115P012 0.50 mm	PU5MB0018A .010	PU5ME0013A .010
POK482 1.00					P4115P013 1.00 mm	PU5MB0018B .020	PU5ME0013B .020
2) PBK480 Std.		PU5MB0018C .030	PU5ME0013C .030				
PBK481 0.50							
PBK482 1.00							

*** Piston Kit consists of:**

1) 1 X PMXFP011 Piston Std,	1 X PUPRK0003 Ring Set Std.
2) 1 X PMXFP012 Piston 0.50 mm,	1 X PUPRK0003B Ring Set 0.50 mm.
3) 1 X PMXFP013 Piston 1.00 mm,	1 X PUPRK0003D Ring Set 1.00 mm.

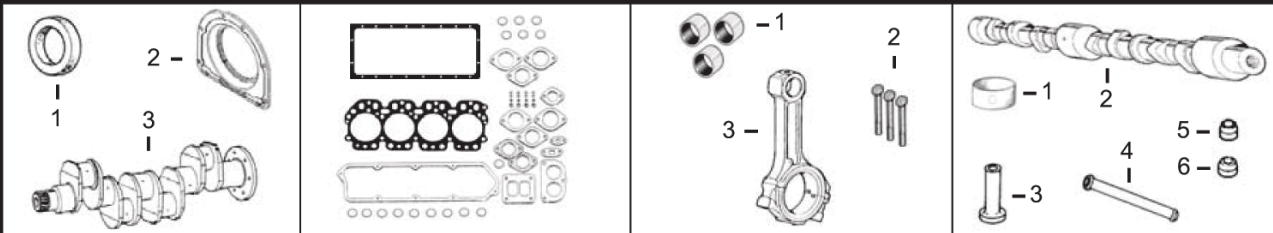

1) Front Seal 2) Rear Seal	1) Top Gasket Set 2) Bottom Gasket	1) Bush, Con Rod 2) Bolt, Con Rod	1) Bushing, Cam 2) Camshaft 3) Tappet 4) Pushrod 5) Seal, Exhaust Valve 6) Seal, Intake Valve
3) Crankshaft Kit	3) Head Gasket 4) Valve Cover Gasket 5) Oil Pan Gasket	3) Con Rod Kit	
1) P2418F436	1) PU5LT0357	1) P3112A005 x4	1) P3112D071 x1
2) P2418F704	2) PU5LB0383	2) P3212V003 x8	2) P3141D211
3) PZZ90239	3) P3681E051	3) P4115C314 (2)	3) P31434163
	4) P3681A055		4) P31434307
	5) P3681K036		5) P2418M517 x4
			6) P2418M519 x4

Valve Train Kit	1) Valve, Intake 2) Valve, Exhaust	3) Guide, Valve (Intake & Exhaust)	4) Spring, Valve	5) Lock, Valve
PVTK425	1) P3142H071 x4 2) P3142A151 x4	3) P3313A012 x8	4) P3174A016 x8	5) P3142W004 x16

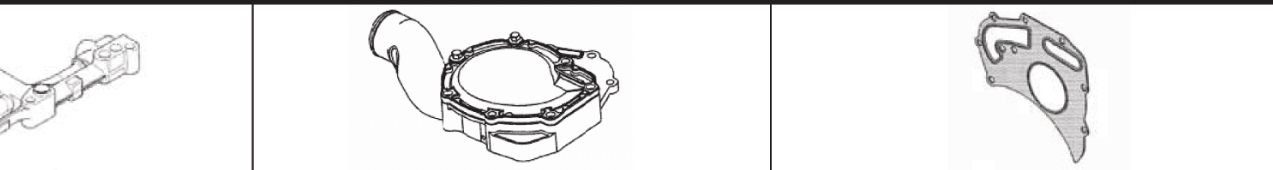

Oil Pump	Water Pump	Water Pump Gasket
P4132F071 (1)	PU5MW0194	P3682A011

(1) Not to be used on engines with balancer units.
(2) Grade J, Color Coded Green.