

Engine & Equipment Application

1104C - 44T
(RG)

1104C - E44T
(RH)

TURBOCHARGED

Bore: 4.133 in
105.00 mm

Stroke: 5.00 in
127.00 mm

Displacement: 269 in³
4.4 Liter

APPLICATIONS:

AGRICULTURAL

- AGCO**
3455/F/GE/GEV (RG37989)
3455S/F/GE/GEV (RG37991)
491 (RG37828)
492 (RG37829/RG38179)
5445/6445 (RG37832/RG37915)
5445/6445 (RG38120/RG38121)
5435T (RG38401/RG38402)
5460 (RG37833/RG51400)



1) Engine O/H Kit	Piston & Ring Kit	Main Bearing Set	Con Rod Bearing Set	Thrust Washer Set
2) Basic Kit	P4115P015 Std.	PU5MB0018 Std.	PU5ME0013 Std.	P31137551/61
1) POK486 Std.	4 Per Engine	Set of 5 Pairs	Set of 4 Pairs	Set of 2 Pairs
POK487 0.50				
POK488 1.00				
2) PBK486 Std.				
PBK487 0.50				
PBK488 1.00				

*** Piston Kit consists of:**
 1) 1 X [PMXFP015](#) Piston Std., 1 X [PUPRK0002](#) Ring Set Std.
 2) 1 X [PMXFP016](#) Piston 0.50 mm, 1 X [PUPRK0002B](#) Ring Set 0.50 mm.
 3) 1 X [PMXFP017](#) Piston 1.00 mm, 1 X [PUPRK0002D](#) Ring Set 1.00 mm.

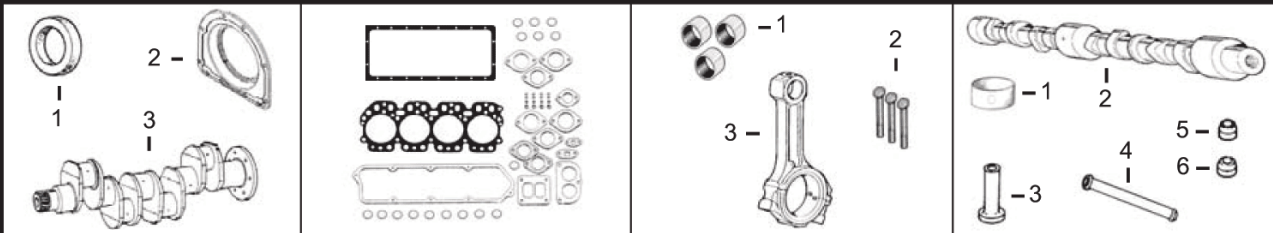

1) Front Seal	1) Top Gasket Set	1) Bush, Con Rod	1) Bushing, Cam
2) Rear Seal	2) Bottom Gasket	2) Bolt, Con Rod	2) Camshaft
3) Crankshaft Kit	3) Head Gasket	3) Con Rod Kit	3) Tappet
	4) Valve Cover Gasket		4) Pushrod
	5) Oil Pan Gasket		5) Seal, Exhaust Valve
			6) Seal, Intake Valve
1) P2418F436	1) PU5LT0357	1) P3112A005 x4	1) P3112D071 x1
2) P2418F704	2) PU5LB0383	2) P3212V003 x8	2) P3141D211
3) PZZ90239	3) P3681E051	3) P4115C314 (2)	3) P31434163
	4) P3681A055		4) P31434307
	5) P3681K036		5) P2418M517 x4
			6) P2418M519 x4

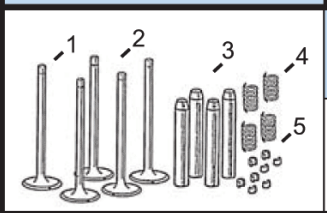

Valve Train Kit	1) Valve, Intake	3) Guide, Valve (Intake & Exhaust)	4) Spring, Valve	5) Lock, Valve
	2) Valve, Exhaust			
PVTK425	1) P3142H071 x4	3) P3313A012 x8	4) P3174A016 x8	5) P3142W004 x16
	2) P3142A151 x4			

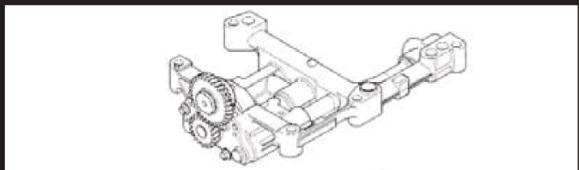

Oil Pump

[P4132F071](#) (1)

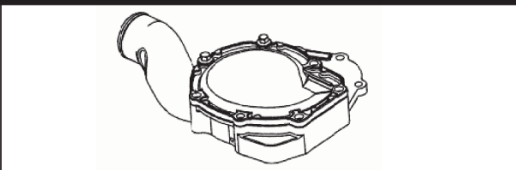

Water Pump

[PU5MW0194](#)



Water Pump Gasket

[P3682A011](#)

(1) Not to be used on engines with balancer units.
(2) Grade J, Color Coded Green.