

**Engine & Equipment  
Application**

**1104D - 44**  
(NK)

**NATURALLY  
ASPIRATED**

Bore: 4.133 in  
105.00 mm

Stroke: 5.00 in  
127.00 mm

Displacement: 269 in<sup>3</sup>  
4.4 Liter

**APPLICATIONS:**

AG Tractors  
Backhoe Loaders  
Forklifts  
Telehandlers

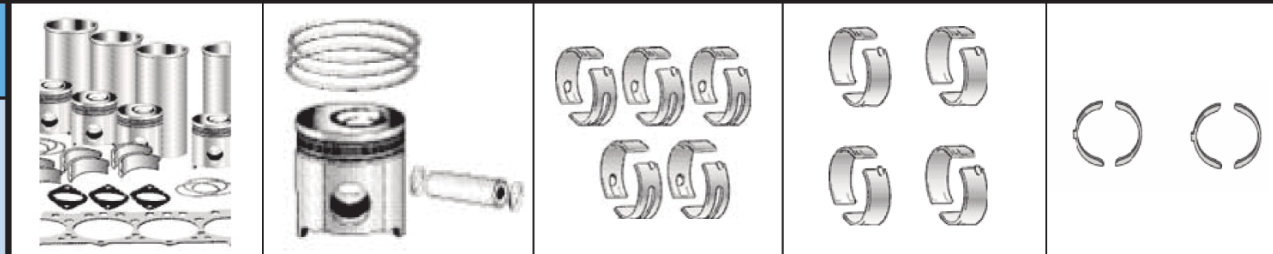

<b>1) Engine O/H Kit</b>	<b>Piston &amp; Ring Kit</b>	<b>Main Bearing Set</b>	<b>Con Rod Bearing Set</b>	<b>Thrust Washer Set</b>
<b>2) Basic Kit</b>	<a href="#">PU5PR0063</a> Std.	<a href="#">PU5MB0033</a> Std.	<a href="#">PU5ME0034</a> Std.	<a href="#">P31137551/61</a>
<b>1) <a href="#">POK500</a> Std.</b>	<b>4 Per Engine</b>	<b>Set of 5 Pairs</b>	<b>Set of 4 Pairs</b>	<b>Set of 2 Pairs</b>
<b><a href="#">POK501</a> 0.50</b>				
<b><a href="#">POK502</a> 1.00</b>				
<b>2) <a href="#">PBK500</a> Std.</b>				
<b><a href="#">PBK501</a> 0.50</b>				
<b><a href="#">PBK502</a> 1.00</b>				

**\* Piston Kit consists of:**

1) 1 X <a href="#">PMXFP063</a> Piston Std,	1 X <a href="#">PUPRK0003</a> Ring Set Std.
2) 1 X <a href="#">PMXFP063B</a> Piston 0.50 mm,	1 X <a href="#">PUPRK0003B</a> Ring Set 0.50 mm.
3) 1 X <a href="#">PMXFP063D</a> Piston 1.00 mm,	1 X <a href="#">PUPRK0003D</a> Ring Set 1.00 mm.

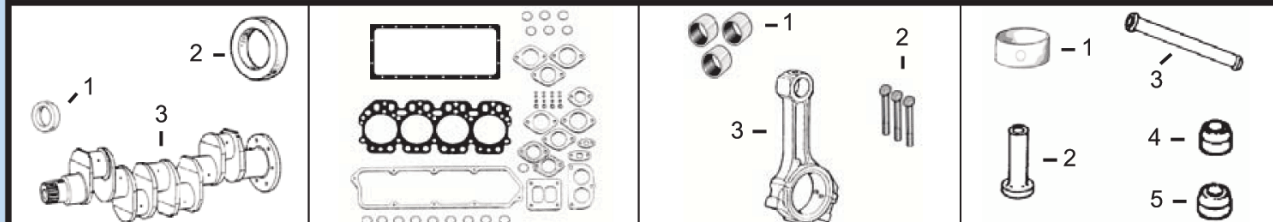

<b>1) Front Seal</b> <b>2) Rear Seal</b>	<b>1) Top Gasket Set</b> <b>2) Bottom Gasket</b>	<b>1) Bush, Con Rod</b> <b>2) Bolt, Con Rod</b>	<b>1) Bushing, Cam</b>
3) Crankshaft Kit	3) Head Gasket 4) Valve Cover Gasket 5) Oil Pan Gasket	3) Con Rod Kit	2) Tappet 3) Push Rod 4) Seal, Exhaust Valve 5) Seal, Intake Valve
1) <a href="#">P2418F436</a> 2) <a href="#">P2418F704</a> 3) <a href="#">PZZ90239</a>	1) <a href="#">PU5LT0357</a> 2) <a href="#">PU5LB0381</a> 3) <a href="#">P3681E051</a> 4) <a href="#">P3681A055</a> 5) <a href="#">P3681K037</a>	1) <a href="#">P3112A005</a> x4 2) <a href="#">P3212V003</a> x8 3) <a href="#">P4115C314</a> (2)	1) <a href="#">P3112D071</a> x1 2) <a href="#">P3142U061</a> 3) <a href="#">P3142V011</a> 4) <a href="#">P2418M517</a> x4 5) <a href="#">P2418M519</a> x4

<b>Valve Train Kit</b>	1) Valve, Intake 2) Valve, Exhaust	3) Guide, Valve (Intake & Exhaust)	4) Spring, Valve	5) Lock, Valve
<a href="#">PVTK426</a>	1) <a href="#">P3142H101</a> x4 2) <a href="#">P3142A171</a> x4	3) <a href="#">P3313A012</a> x8	4) <a href="#">P3174A031</a> x8	5) <a href="#">P2714A002</a> x16

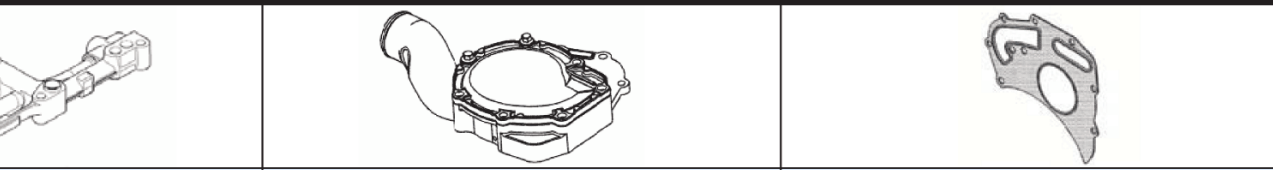

<b>Oil Pump</b>	<b>Water Pump</b>	<b>Water Pump Gasket</b>
<a href="#">P4132F073</a> (1)	<a href="#">PU5MW0208</a>	<a href="#">P3682A011</a>

(1) Not to be used on engines with balancer units.  
(2) Grade J, Color Coded Green.