

**Engine & Equipment
Application**

4.203

**INDIRECT
INJECTION**

4 Cyl, Rope Seal

Bore: 3.6020 in
91.491 mm

To ESN 2820092

APPLICATIONS:

MF AGRICULTURAL
65

MF INDUSTRIAL
356 Tractor Shovel

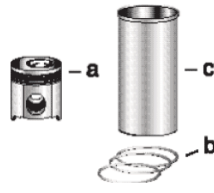

**1) Engine O/H
Kit**

Piston-Liner Kit

**Main Bearing
Set**

**Con Rod Bearing
Set**

**Thrust Washer
Set**

**2) Basic Engine
Kit**

PCK152
Consists of:

[P68082](#) Std.

[P85035](#) Std.

[P31137211/21](#)

1) POK430

a) [P81512](#) (1)

[P68082A](#) .010

[P85035A](#) .010

b) [P41158057](#)

[P68082B](#) .020

[P85035B](#) .020

2) PBK430

c) [P31358308](#) (2)

[P68082C](#) .030

[P85035C](#) .030

4 Per Engine

Set of 5 Pairs

Set of 4 Pairs

Set of 2 Pairs

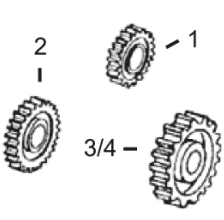
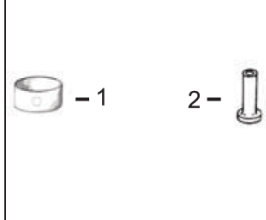
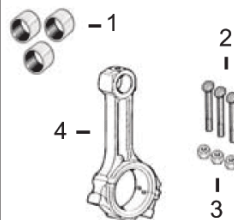
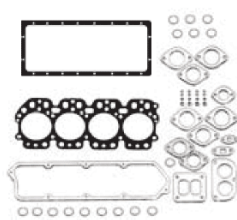
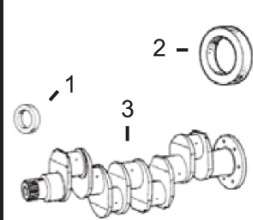

**1) Front Seal
2) Rear Seal**

**1) Top Gasket Set
2) Bottom Gasket**

**1) Bush, Con Rod
2) Bolt, Con Rod
3) Nut, Con Rod**

**1) Bushing, Cam
2) Tappet**

**1) Crankshaft Gear
2) Camshaft Gear
3) Idler Gear, Lower
4) Idler Gear, Upper**

3) Crankshaft Kit

3) Head Gasket

4) Con Rod

1) [P2415344](#)
2) [P36883106](#) x2
3) [PZZ90121](#)

1) [P69036](#)
2) [PU5LB0500](#)
3) [P36812125](#)

1) [P31134151](#) x4
2) [P0095250](#) x8
3) [P33221327](#) x8
4) [PZZ90011](#)

1) [P31134119](#) x1
2) [P0860012](#)

1) [P0410228](#)
2) N/A
3) [P41115004](#)
4) [P41115005](#)

Valve Train Kit

**1) Valve, Intake
2) Valve, Exhaust**

**3) Guide, Valve
(Intake & Exhaust)**

**4) Spring, Valve
a) Inner
b) Outer**

5) Lock, Valve

PVTK404

1) [P31431261](#) x4
2) [P0910002](#) x4

3) [P33261723](#) x8

a) [P0780007](#) x8
b) [P0780006](#) x8

5) [P0230001](#) x16

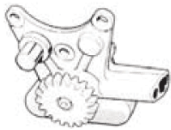
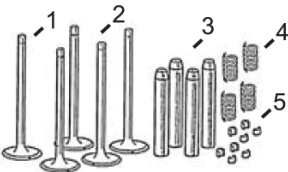

Oil Pump

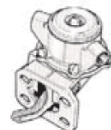

Lift Pump

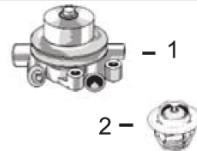

**1) Water Pump
a) Without Pulley
b) With Pulley
2) Thermostat**

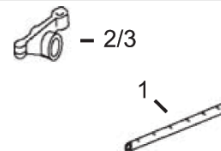

**1) Rocker Shaft
2) Rocker Arm LH
3) Rocker Arm RH**



**1) Cylinder Head
(With Valves)
2) Glowplug**

[P41314164](#)

[P2641A065](#)

1a) [PU5MW0061](#)
b) [P41312892](#)
2) [P2485666](#)

1) [PZZ90139](#)
2) [P3737A101](#)
3) [P3737A091](#)

1) [PZZ80089](#)
2) [P2666103](#)
(Screw Fitting)
[P2666108](#)
(Bayonet Fitting)

(1) Flat Head Piston.

(2) Cast sleeve replaces OEM Chrome Liner with Flange thickness 0.040".