

**Engine & Equipment
Application**

4.248.2

4 Cyl, Lip Seal

Bore: 3.9785 in
101.054 mm

APPLICATIONS:

CATERPILLAR

T80D (LG70149)
T50-150D (LG70109)
V60C (LG70069/LG70091)
V80D (LG70067/LG70090)

CLARK EQUIPMENT

C500 (H) 60-80 (LG70159)
C500Y-100-150 (LG70104)
CTD20-50 (LG70097/LG70106)

HYSTER

H60-80E (LG70063)
H60-110E (LG70127)

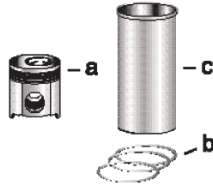

1) Engine O/H Kit	Piston-Liner Kit	Main Bearing Set	Con Rod Bearing Set	Thrust Washer Set
2) Basic Engine Kit	<u>PCK2482</u> Consists of:	<u>P81558</u> Std.	<u>P85042</u> Std.	<u>P31137551/61</u>
1) <u>POK462</u>	a) <u>P68814</u>	<u>P81558A</u> .010	<u>P85042A</u> .010	
	b) <u>P41158022</u>	<u>P81558B</u> .020	<u>P85042B</u> .020	
2) <u>PBK462</u>	c) <u>P3135X034</u> (7)	<u>P81558C</u> .030	<u>P85042C</u> .030	
	4 Per Engine	Set of 5 Pairs	Set of 4 Pairs	Set of 2 Pairs

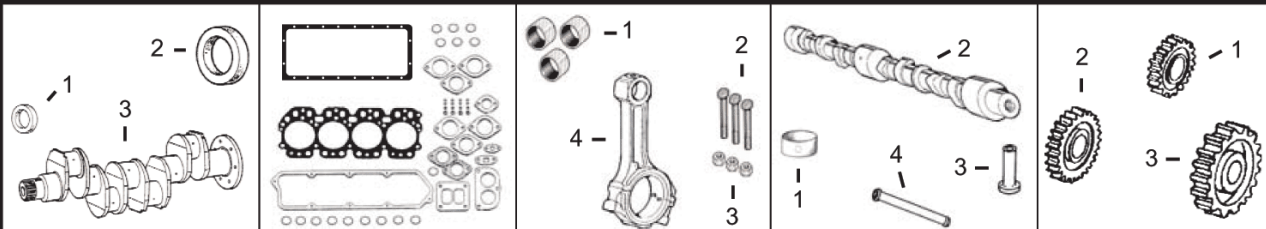

1) Front Seal 2) Rear Seal	1) Top Gasket Set 2) Bottom Gasket 3) Valve Cover Gsk	1) Bush, Con Rod 2) Bolt, Con Rod 3) Nut, Con Rod	1) Bushing, Cam	1) Crankshaft Gear 2) Camshaft Gear 3) Idler Gear
3) Crankshaft Kit	4) Head Gasket 5) Oil Pan Set 6) Timing Cover Gsk	4) Con Rod	2) Camshaft 3) Tappet 4) Push Rod	
1) <u>P2418F436</u> 2) <u>P2418F475</u> 3) <u>PZZ90082</u>	1) <u>PU5LT0176</u> 2) <u>PU5LB0046</u> 3) <u>P3681A027</u> 4) <u>P3681E036</u> 5) <u>PU5MK0600</u> 6) <u>P3681P045</u>	1) <u>P31134123</u> x4 2) <u>P32762144</u> x8 3) <u>P33221328</u> x8 4) <u>PZZ90009</u>	1) <u>P31134132</u> x1 2) <u>P31415292</u> (2) <u>P31415381</u> (3) 3) <u>P31434163</u> 4) <u>P31434307</u>	1) <u>P31171681</u> 2) <u>P31171353</u> <u>P31171931</u> (6) 3) <u>P31171951</u>

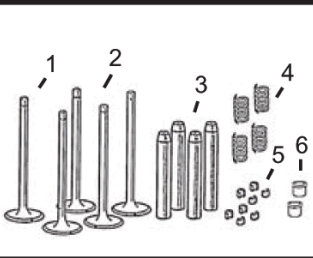

Valve Train Kit	1) Valve, Intake 2) Valve, Exhaust	3) Guide, Valve a) Intake b) Exhaust	4) Spring, Valve a) Inner b) Outer	5) Lock, Valve 6) Seal, Valve
<u>PVTK413</u>	1) <u>P31431315</u> x4 2) <u>P3142A052</u> x4	a) <u>P3343F002</u> x4 b) <u>P3343J002</u> x4	a) <u>P31744131</u> x8 b) <u>P31745121</u> x8	5) <u>P33173108</u> x16 6) <u>P33817117</u> x8

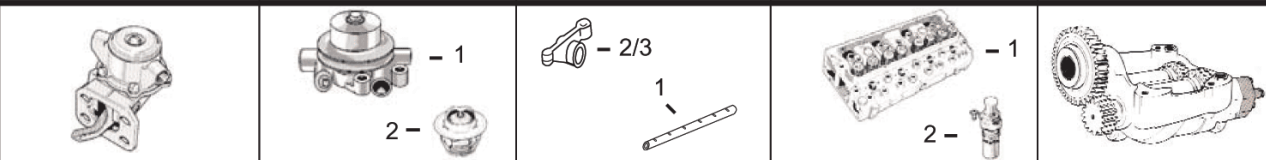
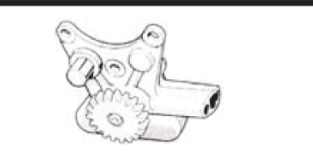

Oil Pump	Lift Pump	1) Water Pump 2) Thermostat	1) Rocker Shaft 2) Rocker Arm LH 3) Rocker Arm RH	1) Cylinder Head (With Valves) 2) Glowplug	Balancer Unit
-----------------	------------------	--------------------------------	---	---	----------------------

<u>P41314182</u> <u>P4132F041</u> (5)	<u>P2641728</u>	1) <u>P4131A013</u> (1) <u>PU5MW0105</u> (1) 2) <u>P2485666</u> (8)	1) <u>PZZ90032</u> 2) <u>P41151483</u> 3) <u>P41151484</u>	1) <u>PZZ80175</u> 2) <u>P2666103</u> (Screw Fitting) <u>P2666108</u> (Bayonet Fitting)	<u>P41733082</u> (4) <u>P4111K051</u> (5)
--	------------------------	--	---	--	--

(1) Check with Build List.
 (2) To ESN U108196N.
 (3) From ESN U108197N.
 (4) Use on Build No: LG70104.
 (5) Use on Build No: LG70159.
 (6) Use on Build Nos: LG70067/LG70090.
 (7) Flanged, Semi Finished Liner available, **P3135X033**.
 (8) Build LG70149 use **P2485613**, and Build LG70159, LG70104 use **P2485609**.