

**Engine & Equipment
Application**

6.354.2

6 Cyl, Rope & Lip Seal

Kits include both rear seals

Bore: 3.8770 in
98.476 mm

APPLICATIONS:

WHITE COCKSHUTT

7600 Combine (TJ22189)

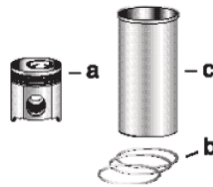

1) Engine O/H Kit

Piston-Liner Kit

Main Bearing Set

Con Rod Bearing Set

Thrust Washer Set

2) Basic Engine Kit

[PU5MK0125](#)

Consists of:

[P85010](#) Std.

[P85043](#) Std.

[P31137551/61](#)

1) [POK668](#)

a) [P86745](#)

[P85010A](#) .010

[P85043A](#) .010

2) [PBK668](#)

b) [P41158032](#)

[P85010B](#) .020

[P85043B](#) .020

c) [P31358394](#) (2)

[P85010C](#) .030

[P85043C](#) .030

6 Per Engine

Set of 7 Pairs

Set of 6 Pairs

Set of 2 Pairs

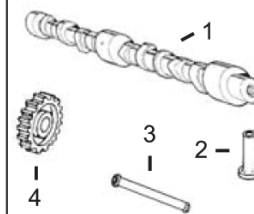
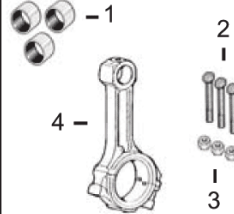
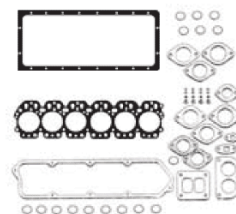
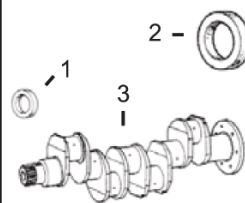

1) **Front Seal**
2) **Rear Seal**

1) **Top Gasket Set**
2) **Bottom Gasket**

1) **Bush, Con Rod**
2) **Bolt, Con Rod**
3) **Nut, Con Rod**

1) **Camshaft**
2) **Tappet**
3) **Push Rod**
4) **Camshaft Gear**

1) **Aux. Drive Shaft**
2) **Gear & Shaft**
3) **Gear**
4) **Front Bush**
5) **Rear Bush**
6) **Seal**

3) **Crankshaft Kit**

3) **Head Gasket**

4) **Con Rod**

1) [P2418F436](#)
2) [P36883108](#) x2
[P2418F475](#)
3) [PZZ90090](#) (1)

1) [PU5LT0028](#)
2) [PU5LB0056](#)
3) [P36812545](#)

1) [P31134123](#) x6
2) [P32762144](#) x12
3) [P332213288](#) x12
4) [PZZ90009](#)

1) N/A
2) [P31434163](#)
3) [P31434307](#)
4) [P31171353](#)

1) [P31173422](#)
2) [P41115367](#)
3) [P31171731](#)
4) [P31134129](#)
5) [P2511447](#)
6) [P2418F432](#)

Valve Train Kit

1) Valve, Intake
2) Valve, Exhaust

3) **Guide, Valve**
a) Intake
b) Exhaust

4) **Spring, Valve**
a) Inner
b) Outer

5) **Lock, Valve**
6) **Seal, Valve**

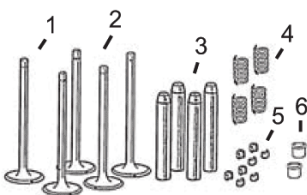

[PVTK610](#)

1) [P31431315](#) x6
2) [P3142A052](#) x6

a) [P3343F002](#) x6
b) [P3343J002](#) x6

a) [P31744131](#) x12
b) [P31745121](#) x12

5) [P33173108](#) x24
6) [P33817117](#) x12

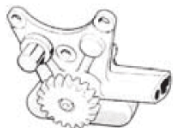

Oil Pump

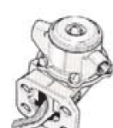

Lift Pump

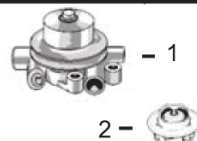

1) **Water Pump**
2) **Thermostat**



1) **Rocker Shaft**
2) **Rocker Arm LH**
3) **Rocker Arm RH**
4) **Relief Valve**



1) **Cylinder Head**
2) **Glowplug**

[P41314067](#)

[P2641A064](#)

1) [PU5MW0123](#)
2) [P2485604](#) x2

1) [PZZ90046](#)
2) [P41151483](#)
3) [P41151484](#)
4) [P41371115](#)
[P41371158](#)

1) N/A
2) Not Used

(1) From ESN U12129L.

(2) Parallel, Semi Finished Liner, [P31358324](#), Flanged, Semi Finished Liner, [P31358393](#), and Finished Liner in .010" Oversize, [P31358398](#), are also available.