

**Engine & Equipment
Application**

6.354.4

6 Cyl, Lip Seal

Bore: 3.8770 in
98.476 mm

APPLICATIONS:

CLARK EQUIPMENT
16000-30000 (TW70007)
C500-160-300D (TW70142)

HYSTER
H150-275-300-350H
(TW70005)

MF AGRICULTURAL
1014 (TW31087)
TX550 Combine (TW31015)

PERKINS USA
General Industrial (TW33425)

WHITE FARM
8600 Combine (TW70114)

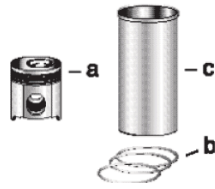

1) Engine O/H Kit

Piston-Liner Kit

Main Bearing Set

Con Rod Bearing Set

Thrust Washer Set

2) Basic Engine Kit

[PU5MK0127](#)

[PU5MB0030](#) Std.

[P85043](#) Std.

[P31137551/61](#)

Consists of:

- a) [P86740](#)
- b) [P41158041](#)
- c) [P31358394](#) (3)

- [PU5MB0030A](#) .010
- [PU5MB0030B](#) .020
- [PU5MB0030C](#) .030

- [P85043A](#) .010
- [P85043B](#) .020
- [P85043C](#) .030

6 Per Engine

Set of 7 Pairs

Set of 6 Pairs

Set of 2 Pairs

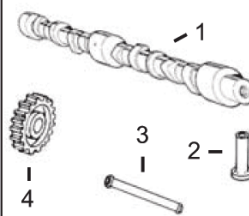
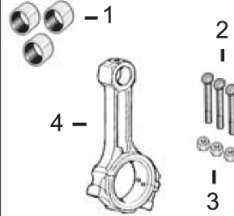
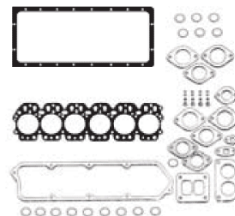
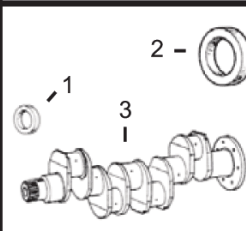

**1) Front Seal
2) Rear Seal**

**1) Top Gasket Set
2) Bottom Gasket**

**1) Bush, Con Rod
2) Bolt, Con Rod
3) Nut, Con Rod**

**1) Camshaft
2) Tappet
3) Push Rod
4) Camshaft Gear**

**1) Aux. Drive Shaft
2) Gear & Shaft
3) Gear
4) Front Bush
5) Rear Bush
6) Seal**

3) Crankshaft Kit

3) Head Gasket

4) Con Rod

- 1) [P2418F436](#)
- 2) [P2418F475](#)
- 3) [PZZ90086](#)

- 1) [PU5LT0017](#)
- 2) [PU5LB0056](#)
- 3) [P3681H202](#)

- 1) [P31134123](#) X6
- 2) [P32762144](#) X12
- 3) [P33221328](#) X12
- 4) [PZZ90009](#)

- 1) [P31416303](#)
- 2) [P31434163](#)
- 3) [P31434307](#)
- 4) [P31171353](#)
[P31171931](#) (1)

- 1) [P31173423](#)
- 2) [P41115367](#)
- 3) [P31171733](#)
- 4) [P31134129](#)
- 5) [P2511447](#)
- 6) [P2418F432](#)

Valve Train Kit

**1) Valve, Intake
2) Valve, Exhaust**

**3) Guide, Valve
a) Intake
b) Exhaust**

**4) Spring, Valve
a) Inner
b) Outer**

**5) Lock, Valve
6) Seal, Valve**

[PVTK611](#)

- 1) [P31431315](#) X6
- 2) [P3142A051](#) X6

- a) [P3343F002](#) X6
- b) [P3343J002](#) X6

- a) [P31744131](#) X12
- b) [P31745121](#) X12

- 5) [P33173108](#) X24
- 6) [P33817117](#) X12

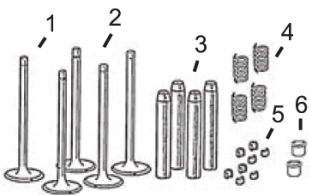

Oil Pump

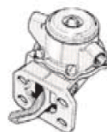

Lift Pump

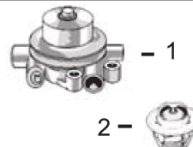

**1) Water Pump
2) Thermostat**

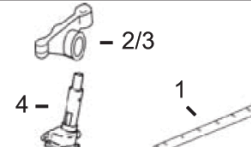

**1) Rocker Shaft
2) Rocker Arm LH
3) Rocker Arm RH
4) Relief Valve**

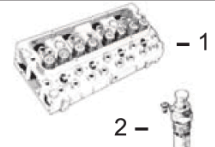

**1) Cylinder Head
(With Valves)
2) Glowplug**

[P4132F015](#)

[P2641729](#)

- 1) [P41313027](#) (2)
[PU5MW0129](#) (2)
- 2) [P2485613](#) X2

- 1) [PZZ90046](#)
- 2) [P41151483](#)
- 3) [P41151484](#)
- 4) [P41371193](#)
[P41371195](#)

- 1) [PZZ80024](#)
- 2) [P2666108](#)
(Bayonet Fitting)

(1) Use Only on Build No: TW70014.

(2) Check with Build List.

(3) Flanged, Semi Finished Liner, [P31358393](#), and Finished Liner in .010" Oversize, [P31358398](#), are also available.