

**Engine & Equipment  
Application**

# 6.354.4

6 Cyl, Lip Seal

Bore: 3.8770 in  
98.476 mm

**APPLICATIONS:**

**MF AGRICULTURAL**

699 (TW31125)  
2675 (TW31008)  
3090 (TW31159)

**WHITE FARM**

2-85 Tractor (TW70008)

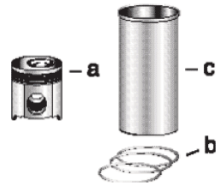

**1) Engine O/H Kit**

**Piston-Liner Kit**

**Main Bearing Set**

**Con Rod Bearing Set**

**Thrust Washer Set**

**2) Basic Engine Kit**

**PCK619**  
Consists of:  
a) PU5LP0019  
b) P41158017  
c) P31358394 (3)  
**6 Per Engine**

PU5MB0030 Std.  
PU5MB0030A .010  
PU5MB0030B .020  
PU5MB0030C .030  
**Set of 7 Pairs**

P85043 Std.  
P85043A .010  
P85043B .020  
P85043C .030  
**Set of 6 Pairs**

P31137551/61  
**Set of 2 Pairs**

**1) POK673**

**2) PBK673**

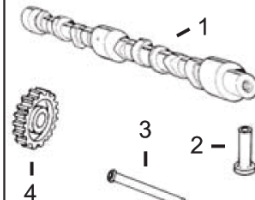
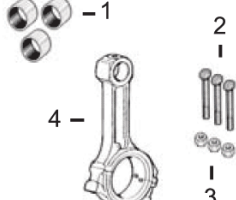
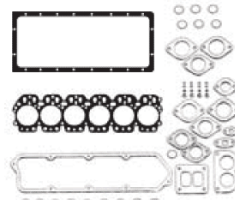
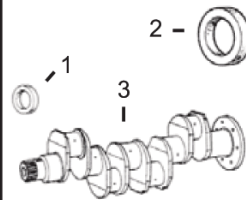

**1) Front Seal  
2) Rear Seal**

**1) Top Gasket Set  
2) Bottom Gasket**

**1) Bush, Con Rod  
2) Bolt, Con Rod  
3) Nut, Con Rod  
4) Con Rod**

**1) Camshaft  
2) Tappet  
3) Push Rod  
4) Camshaft Gear**

**1) Aux. Drive Shaft  
2) Gear & Shaft  
3) Gear  
4) Front Bush  
5) Rear Bush  
6) Seal**

**3) Crankshaft Kit**

**3) Head Gasket**

1) P2418F436  
2) P2418F475  
3) PZZ90086

1) PU5LT0033  
2) PU5LB0056  
3) P3681H202

1) P31134123 X6  
2) P32762144 X12  
3) P33221328 X12  
4) PZZ90009

1) P31416303  
2) P31434163  
3) P31434307  
4) P31171353 (1)  
P31171931

1) P31173423 (2)  
2) P41115367  
3) P31171733  
4) P31134129  
5) P2511447  
6) P2418F432 (4)

**Valve Train Kit**

**1) Valve, Intake  
2) Valve, Exhaust**

**3) Guide, Valve  
a) Intake  
b) Exhaust**

**4) Spring, Valve  
a) Inner  
b) Outer**

**5) Lock, Valve  
6) Seal, Valve**

**PVTK611**

1) P31431315 X6  
2) P3142A051 X6

a) P3343F002 X6  
b) P3343J002 X6

a) P31744131 X12  
b) P31745121 X12

5) P33173108 X24  
6) P33817117 X12

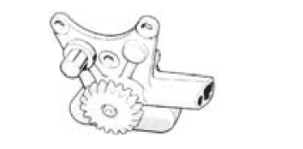
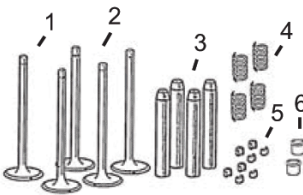

**Oil Pump**

P4132F015

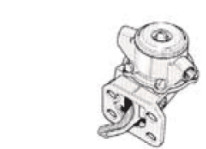

**Lift Pump**

P2641729

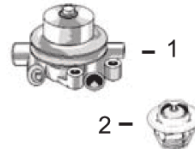

**1) Water Pump  
2) Thermostat**

1) P41313027  
2) P2485613 X2

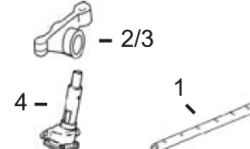

**1) Rocker Shaft  
2) Rocker Arm LH  
3) Rocker Arm RH  
4) Relief Valve**

1) PZZ90046  
2) P41151483  
3) P41151484  
4) P41371193  
P41371195



**1) Cylinder Head (With Valves)  
2) Glowplug**

1) PZZ80024  
2) P2666108  
**(Bayonet Fitting)**

(1) Use Only with Build No: TW31008.

(2) Do Not Use on Build No: TW70008.

(3) Flanged, Semi Finished Liner, P31358393, and Finished Liner in .010" Oversize, P31358398, are also available.

(4) Do not use on Build TW70008.