

**Engine & Equipment
Application**

C4.236

COMPENSATED

4 Cyl, Lip Seal

Bore: 3.8770 in
98.476 mm

To ESN U106654N

APPLICATIONS:

JCB

3CX Backhoe (LH50133)
200 Loader (LH50205)
200 Loader (LH50226)

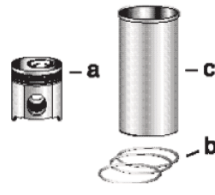

1) Engine O/H Kit

Piston-Liner Kit

Main Bearing Set

Con Rod Bearing Set

Thrust Washer Set

2) Basic Engine Kit

PCK114
Consists of:
a) PU5LP0011
b) P41158147
c) P31358394 (1)
4 Per Engine

P81558 Std.
P81558A .010
P81558B .020
P81558C .030
Set of 5 Pairs

P85042 Std.
P85042A .010
P85042B .020
P85042C .030
Set of 4 Pairs

P31137551/61
Set of 2 Pairs

1) POK452

2) PBK452

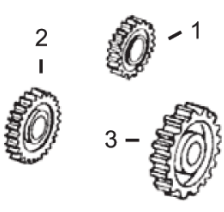
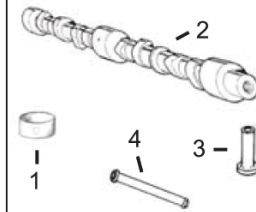
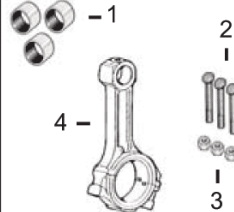
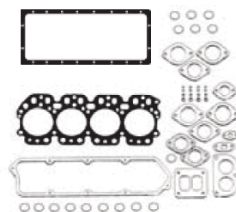
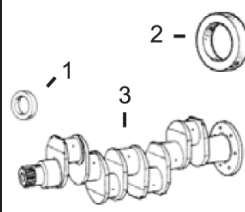

**1) Front Seal
2) Rear Seal**

**1) Top Gasket Set
2) Bottom Gasket
3) Valve Cover Gsk**
4) Head Gasket
5) Oil Pan Set
6) Timing Cover Gsk

**1) Bush, Con Rod
2) Bolt, Con Rod
3) Nut, Con Rod**
4) Con Rod

1) Bushing, Cam
2) Camshaft
3) Tappet
4) Push Rod

1) Crankshaft Gear
2) Camshaft Gear
3) Idler Gear

1) P2418F436
2) P2418F475
3) PZZ90082

1) PU5LT0176
2) PU5LB0045
3) P3681A027
4) P3681E016
5) PU5MK0600
6) P3681P045

1) P31134123 x4
2) P32762144 x8
3) P33221328 x8
4) PZZ90009

1) P31134132 x1
2) P31415374
3) P31434163
4) P31434307

1) P31171681
2) P31171353
P31171931 (2)
3) P41115023

Valve Train Kit

1) Valve, Intake
2) Valve, Exhaust

3) Guide, Valve
a) Intake
b) Exhaust

4) Spring, Valve
a) Inner
b) Outer

5) Lock, Valve
6) Seal, Valve

PVTK413

1) P31431315 x4
2) P3142A052 x4

a) P3343F002 x4
b) P3343J002 x4

a) P31744131 x8
b) P31745121 x8

5) P33173108 x16
6) P33817117 x8

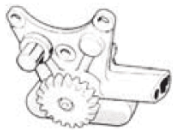
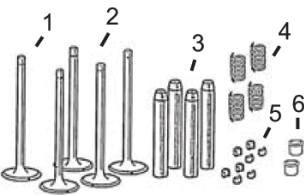

Oil Pump

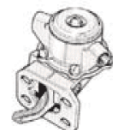

Lift Pump

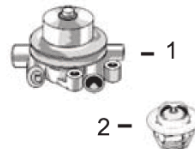

1) Water Pump
2) Thermostat

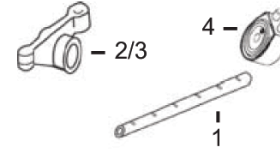

1) Rocker Shaft
2) Rocker Arm LH
3) Rocker Arm RH
4) Oil Cooler

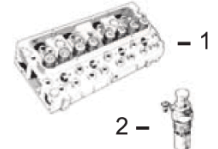

1) Cylinder Head
(With Valves)
2) Glowplug

P41314182

P2641728

1) PU5MW0108
2) P2485613

1) PZZ90032
2) P41151483
3) P41151484
4) P2486A218

1) PZZ80175
2) P2666108
(Bayonet Fitting)

(1) Parallel, Semi Finished Liner, P31358324, Flanged, Semi Finished Liner, P31358393, and Finished Liner in .010"Oversize, P31358398, are also available.

(2) Used on Build Nos: LH50133/LH50205.