

**Engine & Equipment
Application**

C4.236

COMPENSATED

4 Cyl, Lip Seal

Bore: 3.8770 in
98.476 mm

From ESN U106655N

APPLICATIONS:

JCB

3CX Backhoe (LH50133)
200 Loader (LH50205)
200 Loader (LH50226)

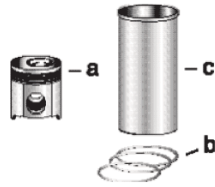

1) Engine O/H Kit

Piston-Liner Kit

Main Bearing Set

Con Rod Bearing Set

Thrust Washer Set

2) Basic Engine Kit

PCK416
Consists of:

[P81558](#) Std.

[P85042](#) Std.

[P31137551/61](#)

1) POK455

a) [PU5LP0011](#)

[P81558A](#) .010

[P85042A](#) .010

2) PBK455

b) [P41158147](#)

[P81558B](#) .020

[P85042B](#) .020

c) [P3135X032](#) (1)

[P81558C](#) .030

[P85042C](#) .030

4 Per Engine

Set of 5 Pairs

Set of 4 Pairs

Set of 2 Pairs

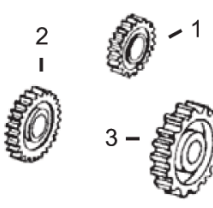
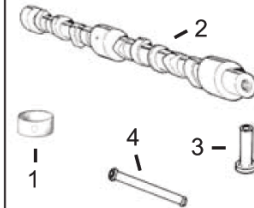
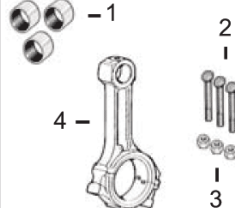
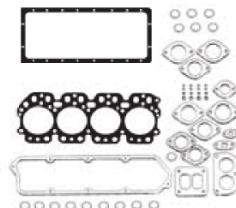
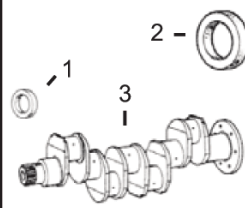

**1) Front Seal
2) Rear Seal**

**1) Top Gasket Set
2) Bottom Gasket
3) Valve Cover Gsk**

**1) Bush, Con Rod
2) Bolt, Con Rod
3) Nut, Con Rod**

1) Bushing, Cam

**1) Crankshaft Gear
2) Camshaft Gear
3) Idler Gear**

3) Crankshaft Kit

**4) Head Gasket
5) Oil Pan Set
6) Timing Cover Gsk**

4) Con Rod

**2) Camshaft
3) Tappet
4) Push Rod**

1) [P2418F436](#)

1) [PU5LT0046](#)

1) [P31134123](#) x4

1) [P31134132](#) x1

1) [P31171681](#)

2) [P2418F475](#)

2) [PU5LB0045](#)

2) [P32762144](#) x8

2) [P31415374](#)

2) [P31171353](#)

3) [PZZ90082](#)

3) [P3681A027](#)

3) [P33221328](#) x8

3) [P31434163](#)

[P31171931](#) (2)

4) [P3681E016](#)

4) [PZZ90009](#)

4) [P31434307](#)

3) [P41115023](#)

5) [PU5MK0600](#)

6) [P3681P045](#)

Valve Train Kit

**1) Valve, Intake
2) Valve, Exhaust**

3) Guide, Valve
a) Intake
b) Exhaust

4) Spring, Valve
a) Inner
b) Outer

**5) Lock, Valve
6) Seal, Valve**

[PVTK413](#)

1) [P31431315](#) x4

a) [P3343F002](#) x4

a) [P31744131](#) x8

5) [P33173108](#) x16

2) [P3142A052](#) x4

b) [P3343J002](#) x4

b) [P31745121](#) x8

6) [P33817117](#) x8

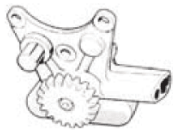
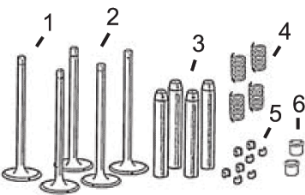

Oil Pump

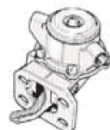

Lift Pump

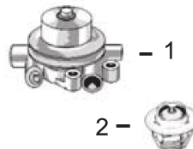

**1) Water Pump
2) Thermostat**

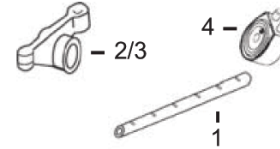

**1) Rocker Shaft
2) Rocker Arm LH
3) Rocker Arm RH
4) Oil Cooler**



**1) Cylinder Head
(With Valves)
2) Glowplug**

[P41314182](#)

[P2641728](#)

1) [PU5MW0108](#)

2) [P2485613](#)

1) [PZZ90032](#)

2) [P41151483](#)

3) [P41151484](#)

4) [P2486A218](#)

1) [PZZ80175](#)

2) [P2666108](#)

(Bayonet Fitting)

(1) Flanged, Semi Finished Liner available, [P3135X031](#).

(2) Used on Build Nos: LH50133/LH50205.