

Engine & Equipment
Application

D3.152

DIRECT INJECTION

3 Cyl, Rope Seal

Bore: 3.6020 in
91.491 mm

ESN ending with D & to
UA391044D

APPLICATIONS:

MF AGRICULTURAL

135
150
230
235

MF INDUSTRIAL

20
40
200 Crawler
203
205
2135
2200 Forklift & Treever
2244 Crawler
2500 Forklift

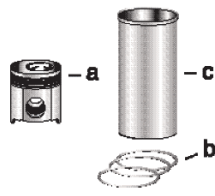

1) Engine O/H Kit

Piston-Liner Kit

Main Bearing Set

Con Rod Bearing Set

Thrust Washer Set

2) Basic Engine Kit

PU5MK0034

P68084 Std.

P85036 Std.

P31137211/21

Consists of:

1) POK303

a) **P68332**

P68084A .010

P85036A .010

2) PBK303

b) **P41158057**

P68084B .020

P85036B .020

c) **P31358345 (3)**

P68084C .030

P85036C .030

3 Per Engine

Set of 4 Pairs

Set of 3 Pairs

Set of 2 Pairs

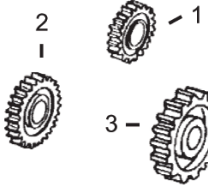
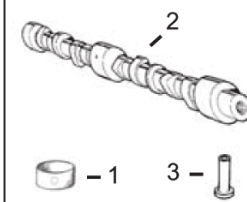
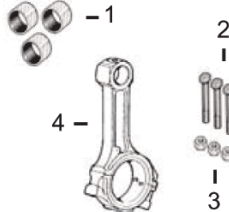
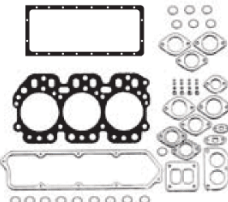
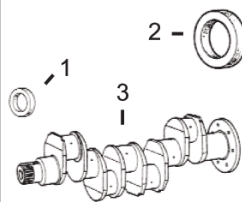

**1) Front Seal
2) Rear Seal**

**1) Top Gasket Set
2) Bottom Gasket**

**1) Bush, Con Rod
2) Bolt, Con Rod
3) Nut, Con Rod**

1) Bushing, Cam
2) Camshaft
3) Tappet

1) Crankshaft Gear
2) Camshaft Gear
3) Idler Gear

3) Crankshaft Kit

3) Head Gasket

4) Con Rod

1) **P2415344**
2) **P36883106 x2**
3) **PZZ90116**

1) **PU5LT0038**
2) **PU5LB0012**
3) **P3681E006**

1) **P31134151 x3**
2) **P0095250 x6**
3) **P33221327 x6**
4) **PZZ90010**

1) **P31134128 x1**
2) **P31415261**
3) **P0860012**

1) **P0410132**
2) **P0410241**
3) **P31164362**

Valve Train Kit

1) Valve, Intake
2) Valve, Exhaust

3) Guide, Valve
(Intake & Exhaust)

4) Spring, Valve
a) Inner
b) Outer

5) Lock, Valve

PVTK302

1) **P31431281 x3**
2) **P31431591 x3**

3) **P33261723 x6**

a) Not Used
b) **P0780006 x6**

5) **P0230001 x12**

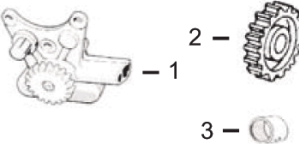
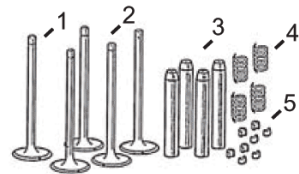

1) Oil Pump
2) Oil Pump Drive Gear
3) Bushing, Drive Gear

Lift Pump

P2641408 (1)
P2641A063 (2)

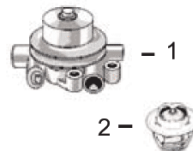

1) Water Pump
a) Without Pulley
b) With Pulley
2) Thermostat

1a) **PU5MW0023**
b) **P41312874**
2) **P2485666**

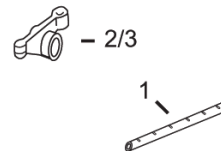

1) Rocker Shaft
2) Rocker Arm LH
3) Rocker Arm RH

1) **PZZ90047**
2) **P3737A101**
3) **P3737A091**



1) Cylinder Head
(With Valves)
2) Glowplug

1) **PZZ80082**
2) **P2666103**
(Screw Fitting)
P2666108
(Bayonet Fitting)

(1) To Engine No: UA38571D.

(2) From Engine No: UA38572D.

(3) Semi Finished Liner, **P31358323**, and Finished Liner in .010", **P31358384**, are available.