

Engine & Equipment
Application

D3.152

DIRECT INJECTION

3 Cyl, Lip Seal

Bore: 3.6020 in
91.491 mm

ESN Ending with DL from
UA391045DL

APPLICATIONS:

LANDINI TRACTORS

4500
4830

MF AGRICULTURAL

135
230
235

MF INDUSTRIAL

20
40

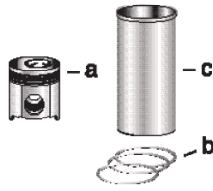

1) Engine O/H Kit

Piston-Liner Kit

Main Bearing Set

Con Rod Bearing Set

Thrust Washer Set

2) Basic Engine Kit

[PU5MK0034](#)

Consists of:

[P68084](#) Std. (4)

[P85036](#) Std.

[P31137211/21](#)

1) [POK304](#)

a) [P68332](#)

[P68084A](#) .010

[P85036A](#) .010

[P68084B](#) .020

[P85036B](#) .020

[P68084C](#) .030

[P85036C](#) .030

2) [PBK304](#)

c) [P31358345](#) (3)

3 Per Engine

Set of 4 Pairs

Set of 3 Pairs

Set of 2 Pairs

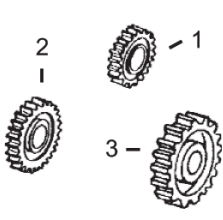
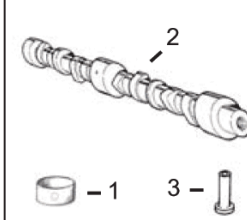
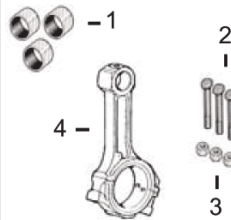
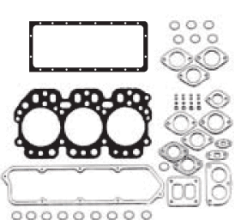
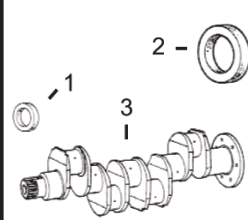

**1) Front Seal
2) Rear Seal**

**1) Top Gasket Set
2) Bottom Gasket**

**1) Bush, Con Rod
2) Bolt, Con Rod
3) Nut, Con Rod**

1) Bushing, Cam

**1) Crankshaft Gear
2) Camshaft Gear
3) Idler Gear**

3) Crankshaft Kit

3) Head Gasket

4) Con Rod

**2) Camshaft
3) Tappet**

1) [P2415344](#)
2) [P2418F475](#)
3) [PZZ90078](#)

1) [PU5LT0038](#)
2) [PU5LB0011](#)
3) [P3681E006](#)

1) [P31134151](#) x3
2) [P0095250](#) x6
3) [P33221327](#) x6
4) [PZZ90010](#)

1) [P31134128](#) x1
2) [P31415261](#)
3) [P0860012](#)

1) [P0410132](#)
2) [P0410241](#)
3) [P31164362](#)

Valve Train Kit

**1) Valve, Intake
2) Valve, Exhaust**

**3) Guide, Valve
(Intake & Exhaust)**

**4) Spring, Valve
a) Inner
b) Outer**

5) Lock, Valve

[PVTK303](#)

1) [P31431681](#) x3
2) [P31431011](#) x3

3) [P33261723](#) x6

a) Not Used
b) [P0780006](#) x6

5) [P0230001](#) x12

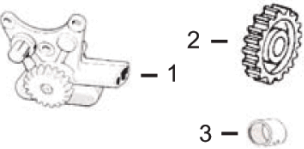
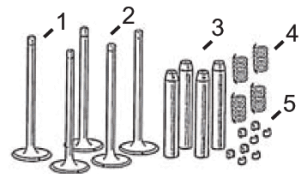

**1) Oil Pump
2) Oil Pump Drive Gear
3) Bushing, Drive Gear**

Lift Pump

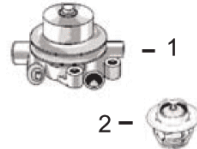

**1) Water Pump
a) Without Pulley
b) With Pulley
2) Thermostat**

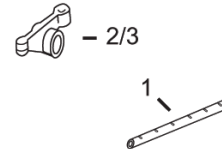

**1) Rocker Shaft
2) Rocker Arm LH
3) Rocker Arm RH**



**1) Cylinder Head
(With Valves)
2) Glowplug**

1) [P41314078](#)
2) [P41115025](#)
3) [P0050265](#)

[P2641A063](#) (1)
[P2641808](#) (2)

1a) [PU5MW0023](#)
b) [P41312874](#)
2) [P2485666](#)

1) [PZZ90047](#)
2) [P3737A101](#)
3) [P3737A091](#)

1) [PZZ80082](#)
2) [P2666103](#)
(Screw Fitting)
[P2666108](#)
(Bayonet Fitting)

(1) To Engine No: U635848G (2 Hole).

(2) From Engine No: U635849G (4 Hole).

(3) Semi Finished Liner, [P31358323](#), and Finished Liner in .010", [P31358384](#), are available.

(4) Use Main Bearing Set [PU5MB0014](#) ESN U983574C > For engine kit with these bearings, order [POK304NB](#) or [PBK304NB](#) and nominate the bearings