

Engine & Equipment Application

D3.152

DIRECT INJECTION

3 Cyl, Lip Seal

Bore: 3.6020 in
91.491 mm

APPLICATIONS:

INGERSOLL RAND COMPRESSORS

Model 85 (CE21575)
DRP 85S 85CFM (CE22236) (2)

LINCOLN ELECTRIC Welder (CE95231)

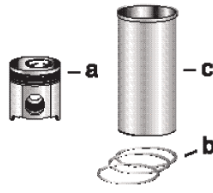

1) Engine O/H Kit	Piston-Liner Kit	Main Bearing Set	Con Rod Bearing Set	Thrust Washer Set
2) Basic Engine Kit	PU5MK0034 Consists of:	P68084 Std. (3)	P85036 Std.	P31137211/21
1) POK309	a) P68332	P68084A .010	P85036A .010	
	b) P41158057	P68084B .020	P85036B .020	
2) PBK309	c) P31358345 (1)	P68084C .030	P85036C .030	
	3 Per Engine	Set of 4 Pairs	Set of 3 Pairs	Set of 2 Pairs

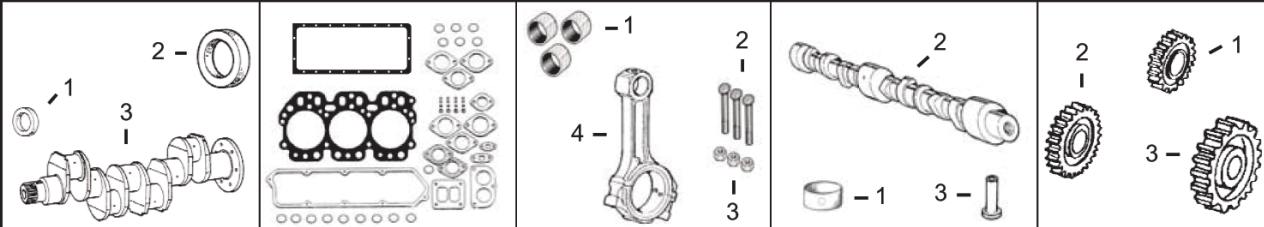

1) Front Seal 2) Rear Seal	1) Top Gasket Set 2) Bottom Gasket	1) Bush, Con Rod 2) Bolt, Con Rod 3) Nut, Con Rod	1) Bushing, Cam	1) Crankshaft Gear 2) Camshaft Gear 3) Idler Gear
3) Crankshaft Kit	3) Head Gasket	4) Con Rod	2) Camshaft 3) Tappet	
1) P2415344 2) P2418F475 3) PZZ90078 (7)	1) PU5LT0038 2) PU5LB0010 3) P3681E006	1) P31134151 x3 2) P0095250 x6 3) P33221327 x6 4) PZZ90010 (4)	1) P31134128 x1 2) P31415261 3) P0860012	1) P0410132 (7) 2) P0410241 3) P31164362

Valve Train Kit	1) Valve, Intake 2) Valve, Exhaust	3) Guide, Valve (Intake & Exhaust)	4) Spring, Valve a) Inner b) Outer	5) Lock, Valve
PVTK303	1) P31431681 x3 2) P31431011 x3	3) P33261723 x6	a) Not Used b) P0780006 x6	5) P0230001 x12

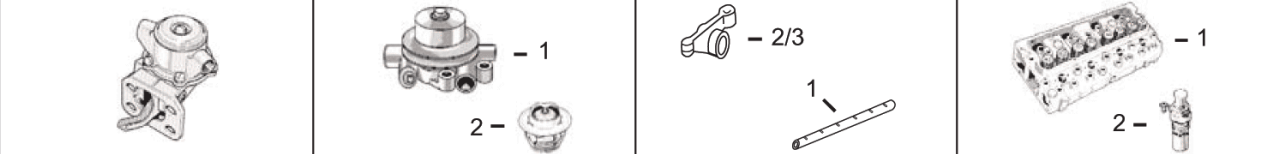

1) Oil Pump 2) Oil Pump Drive Gear 3) Bushing, Drive Gear	Lift Pump	1) Water Pump a) Without Pulley b) With Pulley 2) Thermostat	1) Rocker Shaft 2) Rocker Arm LH 3) Rocker Arm RH	1) Cylinder Head (With Valves) 2) Glowplug
1) P41314078 2) P41115025 3) P0050265	P2641408 (5) P2641808 (6)	1a) PU5MW0023 b) P41312874 2) P2485666	1) PZZ90047 2) P3737A101 3) P3737A091	1) PZZ80082 2) P2666103 (Screw Fitting)

(1) Semi Finished Liner, **P31358323**, and Finished Liner in .010", **P31358384**, are available. (4) Build CE95231 Uses **PZZ90011**.
 (2) From ESN U79698DL. (5) To Engine No: U635848G (2 Hole).
 (3) Use Main Bearing Set, **PU5MB0014**, from ESN U983574C. For engine kit with these bearings, order **POK309NB** or **PBK309NB** and nominate the bearings. (6) From Engine No: U635849G (4 Hole).
 (7) Not used on Build No: CE95231