

Engine & Equipment
Application

D3.152

DIRECT INJECTION

3 Cyl, Lip Seal

Bore: 3.6020 in
91.491 mm

APPLICATIONS:

MF AGRICULTURAL
250 (CE22488)

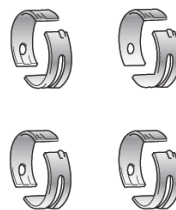
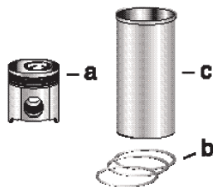

1) Engine O/H Kit	Piston-Liner Kit	Main Bearing Set	Con Rod Bearing Set	Thrust Washer Set
2) Basic Engine Kit	PU5MK0034 Consists of:	P68084 Std. (6)	P85036 Std.	P31137211/21
1) POK307/45 (1) POK307/35 (2)	a) P68332 b) P41158057 c) P31358345 (5)	P68084A .010 P68084B .020 P68084C .030	P85036A .010 P85036B .020 P85036C .030	
2) PBK307	3 Per Engine	Set of 4 Pairs	Set of 3 Pairs	Set of 2 Pairs

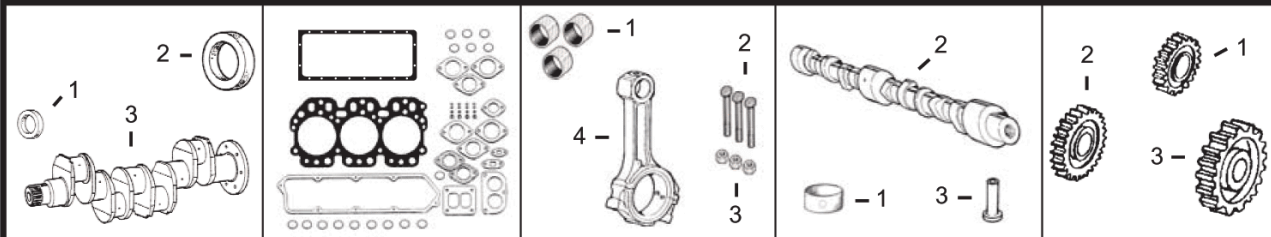

1) Front Seal 2) Rear Seal 3) Crankshaft Kit	1) Top Gasket Set 2) Bottom Gasket 3) Head Gasket	1) Bush, Con Rod 2) Bolt, Con Rod 3) Nut, Con Rod 4) Con Rod	1) Bushing, Cam 2) Camshaft 3) Tappet	1) Crankshaft Gear 2) Camshaft Gear 3) Idler Gear
1) P2415344 2) P2418F475 3) PZZ90078	1) PU5LT0038 2) PU5LB0011 3) P3681E006	1) P31134151 x3 2) P0095250 x6 3) P33221327 x6 4) PZZ90010	1) P31134128 x1 2) P31415261 3) P0860012	1) P0410132 2) P0410241 3) P31164362

Valve Train Kit a) 45° Angle b) 35° Angle	1) Valve, Intake 2) Valve, Exhaust a) 45° Angle b) 35° Angle	3) Guide, Valve (Intake & Exhaust)	4) Spring, Valve a) Inner b) Outer	5) Lock, Valve
a) PVTK302 b) PVTK303	1a) P31431281 x3 b) P31431681 x3 2a) P31431591 x3 b) P31431011 x3	3) P33261723 x6	a) Not Used b) P0780006 x6	5) P0230001 x12

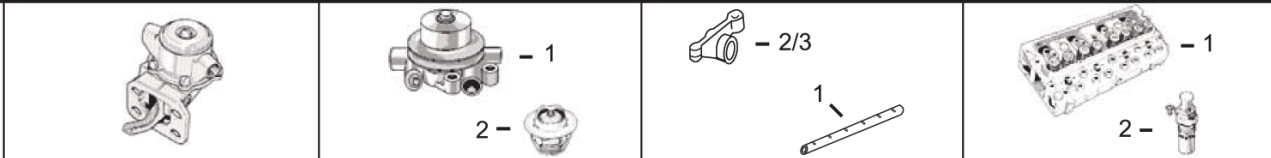

1) Oil Pump 2) Oil Pump Drive Gear 3) Bushing, Drive Gear	Lift Pump	1) Water Pump a) Without Pulley b) With Pulley 2) Thermostat	1) Rocker Shaft 2) Rocker Arm LH 3) Rocker Arm RH	1) Cylinder Head (With Valves) 2) Glowplug
1) P41314078 2) P41115025 3) P0050265	P2641A063 (3) P2641808 (4)	1a) PU5MW0023 b) P41312874 2) P2485666	1) PZZ90047 2) P3737A101 3) P3737A091	1) PZZ80082 2) P2666108 (Bayonet Fitting)

(1) Use with Cylinder Head **PZZ80082**.
 (2) Use with Cylinder Head 68128.
 (3) To Engine No: U635848G (2 Hole).
 (4) From Engine No: U635849G (4 Hole).
 (5) Semi Finished Liner, **P31358323**, and Finished Liner in .010", **P31358384**, are available.
 (6) Use Main Bearing Set, **PU5MB0014**, from ESN U983574C. For engine kit with these bearings, order **POK307/35NB**, **POK307/45NB** or **PBK307NB** and nominate the bearings. Only available in Std or 0.10 sizes.