

Engine & Equipment
Application

D4.203

DIRECT INJECTION

4 Cyl, Rope Seal

Bore: 3.6020 in
91.491 mm

To ESN 2939035

APPLICATIONS:

MF AGRICULTURAL
65

MF INDUSTRIAL
365 Tractor Shovel

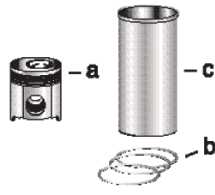

1) Engine O/H Kit

Piston-Liner Kit

Main Bearing Set

Con Rod Bearing Set

Thrust Washer Set

2) Basic Engine Kit

PCK153
Consists of:

[P68082](#) Std.

[P85035](#) Std.

[P31137211/21](#)

1) POK432

a) [P68332](#)

[P68082A](#) .010

[P85035A](#) .010

2) PBK432

b) [P41158057](#)

[P68082B](#) .020

[P85035B](#) .020

c) [P31358308](#) (1)

[P68082C](#) .030

[P85035C](#) .030

4 Per Engine

Set of 5 Pairs

Set of 4 Pairs

Set of 2 Pairs

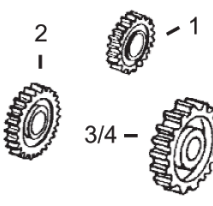
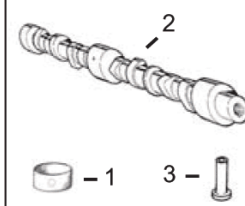
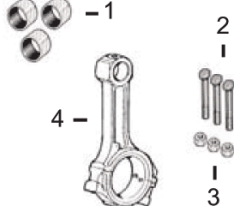
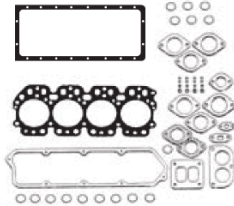
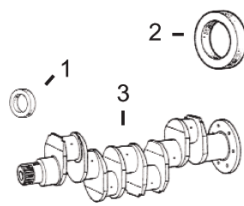

**1) Front Seal
2) Rear Seal**

**1) Top Gasket Set
2) Bottom Gasket**

**1) Bush, Con Rod
2) Bolt, Con Rod
3) Nut, Con Rod**

1) Bushing, Cam
2) Camshaft
3) Tappet

1) Crankshaft Gear
2) Camshaft Gear
3) Idler Gear, Lower
4) Idler Gear, Upper

3) Crankshaft Kit

3) Head Gasket

4) Con Rod

1) [P2415344](#)
2) [P36883106](#) X2
3) [PZZ90121](#)

1) [PU5LT0069](#)
2) [P82908](#)
3) [P36812138](#)

1) [P31134151](#) X4
2) [P0095250](#) X8
3) [P33221327](#) X8
4) [PZZ90010](#)

1) [P31134119](#) x1
2) [P31415214](#)
3) [P0860012](#)

1) [P0410228](#)
2) [P0410231](#)
3) [P41115004](#)
4) [P41115005](#)

Valve Train Kit

1) Valve, Intake
2) Valve, Exhaust

3) Guide, Valve
(Intake & Exhaust)

4) Spring, Valve
a) Inner
b) Outer

5) Lock, Valve

PVTK405

1) [P31431281](#) x4
2) [P31431591](#) x4

3) [P33261723](#) x8

a) [P0780007](#) x8
b) [P0780006](#) x8

5) [P0230001](#) x16

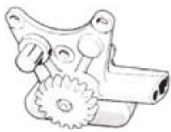
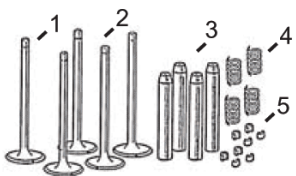

Oil Pump

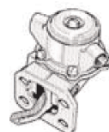

Lift Pump

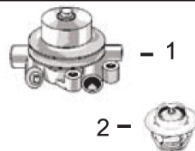

1) Water Pump
a) Without Pulley
b) With Pulley
2) Thermostat

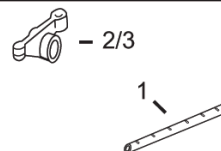

1) Rocker Shaft
2) Rocker Arm LH
3) Rocker Arm RH



1) Cylinder Head
2) Glowplug

[P41314164](#)

[P2641A065](#)

1a) [PU5MW0061](#)
b) [P41312892](#)
2) [P2485666](#)

1) [PZZ90139](#)
2) [P3737A101](#)
3) [P3737A091](#)

1) [PZZ80078](#)
2) [P2666103](#)
(Screw Fitting)
[P2666108](#)
(Bayonet Fitting)

(1) Cast sleeve replaces OEM Chrome Liner with Flange thickness 0.040".