

Engine & Equipment
Application

G3.152

GASOLINE ENGINE

3 Cyl, Rope Seal

Bore: 3.6020 in
91.491 mm

APPLICATIONS:

MF AGRICULTURAL

135
150

MF INDUSTRIAL

20
40
2500 Forklift

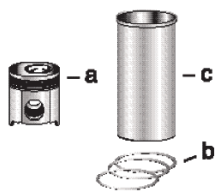

1) Engine O/H Kit

Piston-Liner Kit

Main Bearing Set

Con Rod Bearing Set

Thrust Washer Set

2) Basic Engine Kit

PCK154

[P68084](#) Std.

[P85036](#) Std.

[P31137211/21](#)

Consists of:

1) POK308

a) [P86723](#)

[P68084A](#) .010

[P85036A](#) .010

b) [P41158012](#)

[P68084B](#) .020

[P85036B](#) .020

2) PBK308

c) [P31358345](#) (1)

[P68084C](#) .030

[P85036C](#) .030

3 Per Engine

Set of 4 Pairs

Set of 3 Pairs

Set of 2 Pairs

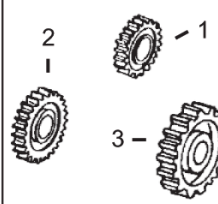
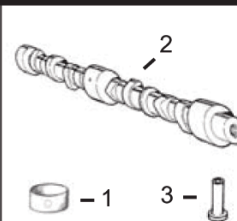
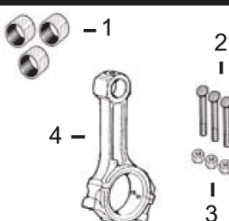
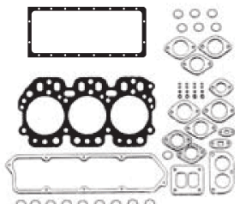
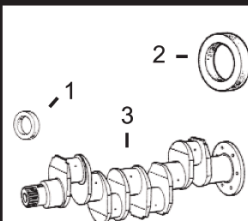

1) Front Seal
2) Rear Seal

1) Top Gasket Set
2) Bottom Gasket

1) Bush, Con Rod
2) Bolt, Con Rod
3) Nut, Con Rod

1) Bushing, Cam

1) Crankshaft Gear
2) Camshaft Gear
3) Idler Gear

3) Crankshaft Kit

3) Head Gasket

4) Con Rod

2) Camshaft
3) Tappet

1) [P2415344](#)
2) [P36883106](#) x2
3) [PZZ90116](#)

1) [PU5LT0037](#)
2) [PU5LB0012](#)
3) [P3681E006](#)

1) [P31134151](#) x3
2) [P0095250](#) x6
3) [P33221327](#) x6
4) [PZZ90011](#)

1) Not Used
2) [P31415261](#)
3) [P0860012](#)

1) [P0410132](#)
2) [P0410241](#)
3) [P31164362](#)

Valve Train Kit

1) Valve, Intake
2) Valve, Exhaust

3) Guide, Valve
(Intake & Exhaust)

4) Spring, Valve
a) Inner
b) Outer

5) Lock, Valve

PVTK304

1) [P31431741](#) x3
2) [P31431731](#) x3

3) [P3313E011](#) x6

a) Not Used
b) [P0780006](#) x6

5) [P0230001](#) x12

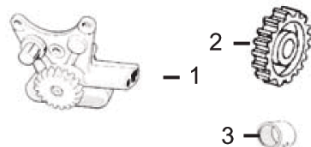
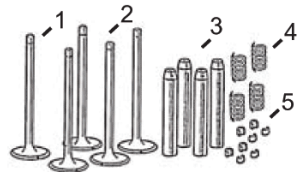

1) Oil Pump
2) Oil Pump Drive Gear
3) Bushing, Drive Gear

1) [P41314078](#)
2) [P41115025](#)
3) [P0050265](#)

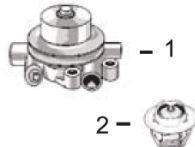

1) Water Pump
a) Without Pulley
b) With Pulley
2) Thermostat

1a) [PU5MW0023](#)
b) [P41312784](#)
2) [P2485666](#)

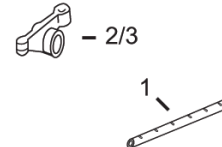

1) Rocker Shaft
2) Rocker Arm LH
3) Rocker Arm RH

1) [PZZ90047](#)
2) [P3737A101](#)
3) [P3737A091](#)