

Engine & Equipment Application

G4.236

GASOLINE ENGINE

4 Cyl, Lip Seal

Bore: 3.8770 in
98.476 mm

To ESN U106654N

APPLICATIONS:

CATERPILLAR

RT (LE70110)
T500-1500 (LE70148)
V80D (LE70089)
V100-140 (LE70094)

CLARK EQUIPMENT

C500-Y60 (LE80173/LE22376)

EATON CORP

Forklift (LE80177)

JACOBSEN MFG CO

H-15 & F10 Turf Tractor (LE70054)

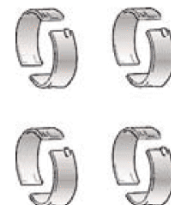
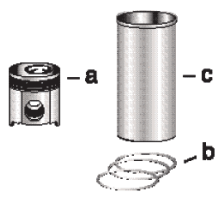

1) Engine O/H Kit

Piston-Liner Kit

Main Bearing Set

Con Rod Bearing Set

Thrust Washer Set

2) Basic Engine Kit

PCK394
Consists of:

P81558 Std.

P85042 Std.

P31137551/61

1) POK457

a) **PU5LP0047**

P81558A .010

P85042A .010

2) PBK457

b) **P41158142**

P81558B .020

P85042B .020

c) **P31358394 (5)**

P81558C .030

P85042C .030

4 Per Engine

Set of 5 Pairs

Set of 4 Pairs

Set of 2 Pairs

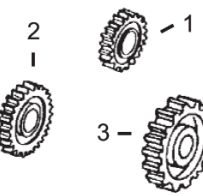
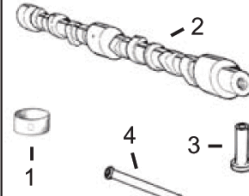
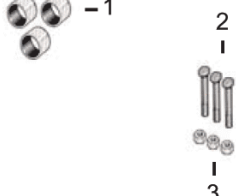
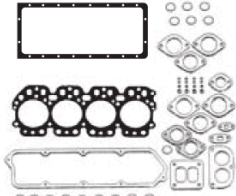
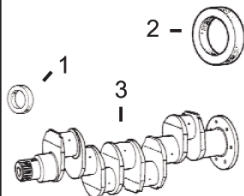

1) Front Seal

1) Top Gasket Set

1) Bush, Con Rod

1) Bushing, Cam

1) Crankshaft Gear

2) Rear Seal

2) Bottom Gasket

2) Bolt, Con Rod

2) Camshaft

2) Camshaft Gear

3) Crankshaft Kit

3) Valve Cover Gsk

3) Nut, Con Rod

3) Tappet

3) Idler Gear

4) Head Gasket

4) Oil Pan Set

4) Pushrod

5) Oil Pan Set

6) Timing Cover Gsk

1) **P2418F436**

1) **PU5LT0176**

1) **P31134144 x4**

1) **P31134132 x1**

1) **P31171681 (1)**

2) **P2418F475**

2) **PU5LB0046**

2) **P32762144 x8**

2) **P31415292**

2) **P31171353**

3) **PZZ90082**

3) **P3681A027**

3) **P33221328 x8**

3) **P31434163**

3) **P31171931 (4)**

4) **P3681E036**

4) **P31434307**

3) **P31171951**

5) **PU5MK0600**

6) **P3681P045 (3)**

Valve Train Kit

1) Valve, Intake
2) Valve, Exhaust

3) Guide, Valve
a) Intake
b) Exhaust

4) Spring, Valve
a) Inner
b) Outer

5) Lock, Valve
6) Seal, Valve

PVTK412

1) **P31431871 x4**
2) **P31431701 x4**

a) **P3343F002 x4**
b) **P3343J002 x4**

a) **P31744131 x8**
b) **P31745121 x8**

5) **P33173108 x16**
6) **P33817117 x8**

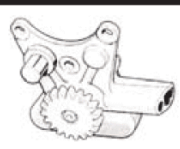
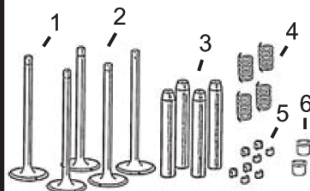

Oil Pump

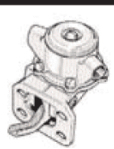

Lift Pump

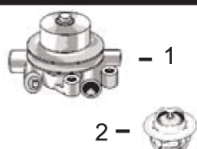

1) Water Pump
2) Thermostat

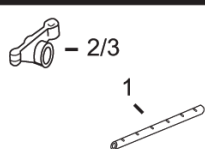

1) Rocker Shaft
2) Rocker Arm LH
3) Rocker Arm RH



1) Cylinder Head
2) Glowplug

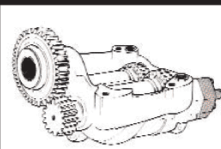

Balancer Unit

P41314182

P2641728

1) **P4131A013**
PU5MW0105 (7)
2) **P2485666 (6)**

1) **PZZ90032**
2) **P41151483**
3) **P41151484**

1) N/A
2) N/A

P41733082 (2)

(1) Do not Use on Build No: LE70089,LE22376, and LE80173.

(2) Use on Build No: LE22376,LE80173.

(3) Order with Kit for Build No: LE70089,LE70094.

(4) Use on Build Nos: LE70089/LE80173/LE22376.

(5) Parallel, Semi Finished Liner, **P31358324**, Flanged, Semi Finished Liner, **P31358393**, and Finished Liner in .010"Oversize, **P31358398**, are also available.

(6) Use **P2485613** on Build LE70148 and **P2485609** on Build LE80173.