

**Engine & Equipment
Application**

T4.236

TURBOCHARGED

4 Cyl, Lip Seal

Bore: 3.8770 in
98.476 mm

APPLICATIONS:

JCB

(From ESN U027774M)
4CX Backhoe (LJ50117)
410M Forklift (LJ50201)
415 Loader (LJ50224)
520S Loadall (LJ50183)

MF AGRICULTURAL

(From ESN U106655N)
698 (LJ31131)
3065 (LJ31217)
3370 (LJ31153)

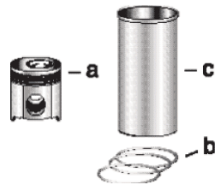

1) Engine O/H Kit	Piston-Liner Kit	Main Bearing Set	Con Rod Bearing Set	Thrust Washer Set
2) Basic Engine Kit	<u>PCK236T</u> Consists of: a) <u>PU5LP0022</u> b) <u>P41158145</u> c) <u>P3135X032</u> (2)	<u>P81558</u> Std. <u>P81558A</u> .010 <u>P81558B</u> .020 <u>P81558C</u> .030	<u>P85042</u> Std. <u>P85042A</u> .010 <u>P85042B</u> .020 <u>P85042C</u> .030	<u>P31137551/61</u>
1) <u>POK451</u>		4 Per Engine	Set of 5 Pairs	Set of 2 Pairs
2) <u>PBK451</u>				

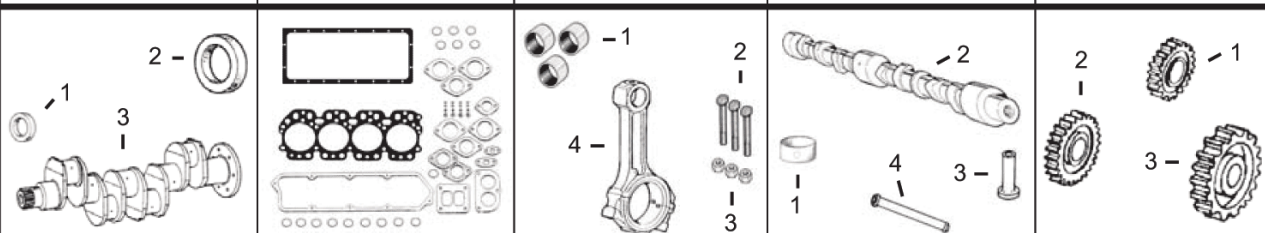

1) Front Seal 2) Rear Seal 3) Crankshaft Kit	1) Top Gasket Set 2) Bottom Gasket 3) Valve Cover Gsk 4) Head Gasket 5) Oil Pan Set 6) Timing Cover Gsk	1) Bush, Con Rod 2) Bolt, Con Rod 3) Nut, Con Rod 4) Con Rod	1) Bushing, Cam 2) Camshaft 3) Tappet 4) Push Rod	1) Crankshaft Gear 2) Camshaft Gear 3) Idler Gear
1) <u>P2418F436</u> 2) <u>P2418F475</u> 3) <u>PZZ90082</u>	1) <u>PU5LT0046</u> 2) <u>PU5LB0045</u> 3) <u>P3681A027</u> 4) <u>P3681E016</u> 5) <u>PU5MK0600</u> 6) <u>P3681P045</u>	1) <u>P31134131</u> x4 2) <u>P32762144</u> x8 3) <u>P33221328</u> x8 4) <u>PZZ90013</u>	1) <u>P31134132</u> x1 2) N/A 3) <u>P31434163</u> 4) <u>P31434307</u>	1) <u>P31171681</u> 2) <u>P31171353</u> <u>P31171931</u> (3) 3) N/A

Valve Train Kit	1) Valve, Intake 2) Valve, Exhaust	3) Guide, Valve a) Intake b) Exhaust	4) Spring, Valve a) Inner b) Outer	5) Lock, Valve 6) Seal, Valve
<u>PVTK414</u>	1) <u>P3142H002</u> x4 2) <u>P3142A052</u> x4	a) <u>P3343F002</u> x4 b) <u>P3343J002</u> x4	a) <u>P31744131</u> x8 b) <u>P31745121</u> x8	5) <u>P33173108</u> x16 6) <u>P33817117</u> x8

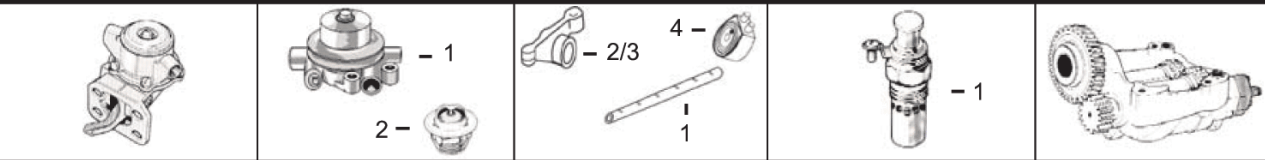

Oil Pump	Lift Pump	1) Water Pump 2) Thermostat	1) Rocker Shaft 2) Rocker Arm LH 3) Rocker Arm RH 4) Oil Cooler	1) Glowplug	Balancer Unit
-----------------	------------------	--------------------------------	--	-------------	----------------------

<u>P4132F012</u> <u>P4132F041</u> (1)	<u>P2641728</u>	1) <u>PU5MW0108</u> 2) <u>P2485613</u>	1) <u>PZZ90032</u> 2) <u>P41151483</u> 3) <u>P41151484</u> 4) <u>P2486A218</u>	1) <u>P2666108</u> (Bayonet Fitting)	<u>P4111K051</u> (1)
--	-----------------	---	---	--	----------------------

(1) For Use on Agricultural Applications.
(2) Flanged, Semi Finished Liner available, P3135X031.
(3) Used on Build No: LJ50201.