

# 300 Series

Engine & Equipment  
Model

## 3.152

> 154,765

O'rings on liner

3 Cyl.

Bore: 3.86 in  
98 mm  
Pin Ø: 1.185 in  
30 mm

**Block (m):**

T24963, T26935

**Con Rod (m):**

T20007, R81410

### APPLICATIONS:

#### AGRICULTURAL

820  
1020  
1030

#### CONSTRUCTION

300  
300A  
350A  
350B  
380

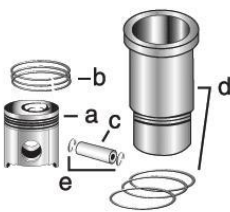

1) Engine O/H Kit

Piston-Liner Kit

Main Bearing

Thrust Bearing

Con Rod Bearing

2) Engine I/F Kit

**TPLK481**

Consists of:

- a) [TT23481](#)
- b) [TAR70633](#)
- c) [TT23482](#)
- d) [TAR51902](#)
- e) [TR51112](#)

[TRE27352](#) Std.

[TRE27353](#) .010

[TRE27360](#) .020

[TRE27368](#) .030

[TAT21139](#) Std.

[TAT21132](#) .010

[TAT21134](#) .020

[TAT21136](#) .030

[TRE27348](#) Std.

[TRE27349](#) .010

[TRE27358](#) .020

[TRE27364](#) .030

Use 3

Use 1

Use 3

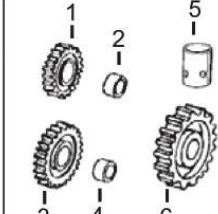
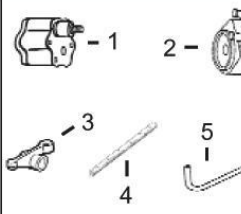
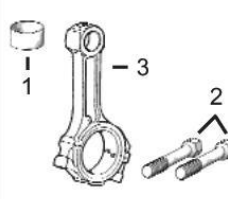
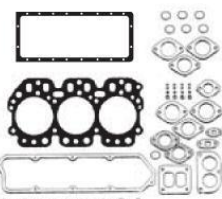
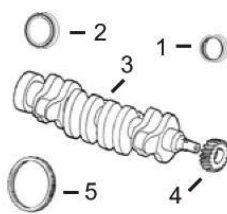

1) Front Seal  
2) Rear Seal

1) O/H Gasket Set

1) Bush, Con Rod  
2) Bolt, Con Rod

1) Pump, Oil  
2) Oil Cooler  
3) Rocker Arm  
4) Rocker Shaft  
5) Pump, Oil Tube

1) Lower Gear  
2) Lower Bushing  
3) Upper Gear  
4) Upper Bushing  
5) Cam. Follower  
6) Cam. Gear

3) Crankshaft  
4) Crankshaft, Gear  
5) Ring Gear

2) Head Gasket Set  
3) Head Gasket  
4) Oil Pan Gasket  
5) Rocker Cover Gsk

3) Con Rod

1) [TAR67942](#)  
2) [TRE44574](#) (1)  
3) [TAT18031](#)  
4) [TT20094](#)  
5) [TR114282](#) (142T)

1) [TRE38570](#)  
2) [TRE38848](#)  
3) [TR98460](#)  
4) [TR97341](#)  
5) [TR75729](#)

1) [TT23471](#) x3  
2) [TR74194](#) x6 (4)  
3) [TAT18005](#)

1) [TRE55343](#)  
2) [TRE31929](#) (3)  
3) [TRE31973](#)  
4) [TR54985](#)  
5) [TR113752](#)

1) [TAT24252](#)  
2) [TT26321](#)  
3) [TAT18009](#)  
4) [TT20034](#)  
5) [TT20073](#)  
6) [TT20070](#)

Valve, Intake

Valve, Exhaust

Insert, Valve

1) Cap, Valve  
2) Lock, Valve

1) Spring, Valve  
2) Rotator, Valve  
3) O'ring, Valve



[TR79623](#) Std.  
[TR79628](#) .003  
[TR79629](#) .015

[TR79624](#) Std.  
[TR79625](#) .003  
[TR79626](#) .015

1) [TR73064](#) Std.  
2) [TR51734](#) Std.

1) [TT20129](#)  
2) [TT20077](#)

1) [TR26125](#)  
2) [TRE11410](#)  
3) [TR87627](#)

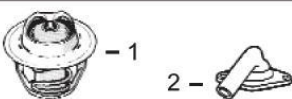

1) [TRE33705](#) 180° F (2)  
2) [TT23620](#)

Fuel Transfer Pump

[TRE42211](#)

Water Pump Repair Kit

Without Impeller

With Impeller

[TRE19507](#)

[TRE62658](#)

Injector, Pencil

[TAR89564](#)

Seal

[TR60746](#)  
[TR48000](#)

(1) Do not use with Flywheel Housing (m) T20300, T22991.

(2) Do not use with Housing (m) R54096, R70741, R74549.

(3) Conversion Kit [TMX386](#): Available Consists of: [TT31306](#) x1 Nipple [TR99802](#) x2 Hose.

(4) Use [TR74194](#) with C.Rod (m) T20007; use [TR80033](#) with C.Rod (m) R81410.