

300 Series

Engine & Equipment
Model

3.152

154,766 >

O'rings on Block

3 Cyl

Bore: 3.86 in
98 mm
Pin Ø: 1.185 in
30 mm

Block (m):

R53240, R55100,
R72967, T32339

Con Rod (m):

T20007, R81410

APPLICATIONS:

AGRICULTURAL

820
830
1020
1030

CONSTRUCTION

300
300A
300B
301
301A
350A/B
380

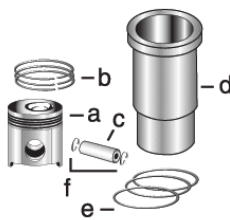
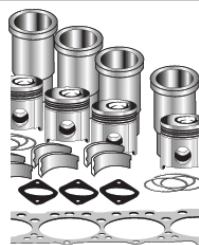

1) Engine O/H Kit

Piston-Liner Kit

Main Bearing

Thrust Bearing

Con Rod Bearing

2) Engine I/F Kit

[TAR71591](#)

[TRE27352](#) Std.

[TAT21139](#) Std.

[TRE27348](#) Std.

Consists of:

[TRE27353](#) .010

[TAT21132](#) .010

[TRE27349](#) .010

a) [TT23481](#)

[TRE27360](#) .020

[TAT21134](#) .020

[TRE27358](#) .020

b) [TAR70633](#)

[TRE27368](#) .030

[TAT21136](#) .030

[TRE27364](#) .030

c) [TT23482](#)

d) [TT32340](#)

e) [TAR71617](#)

f) [TR51112](#)

Use 3

Use 1

Use 3

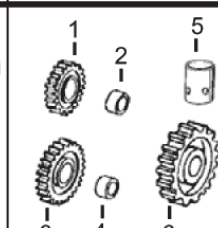
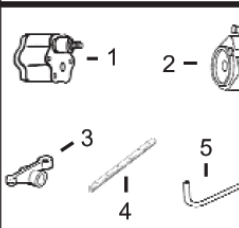
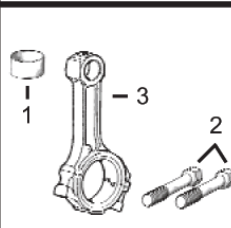
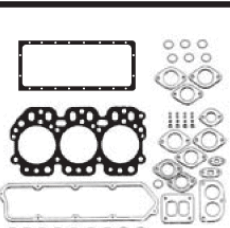
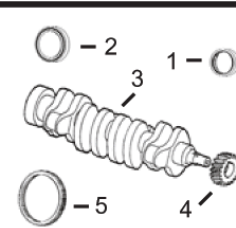

1) Front Seal

1) O/H Gasket Set

1) Bush, Con Rod

1) Pump, Oil

1) Lower Gear

2) Rear Seal

2) Head Gasket Set

2) Bolt, Con Rod

2) Oil Cooler

2) Lower Bushing

3) Crankshaft

3) Head Gasket

3) Con Rod

3) Rocker Arm

3) Upper Gear

4) Crankshaft, Gear

4) Oil Pan Gasket

4) Rocker Shaft

4) Upper Bushing

5) Ring Gear

5) Rocker Cover Gsk

5) Pump, Oil Tube

5) Cam. Follower

6) Cam. Gear

1) [TAR67942](#)

1) [TRE38570](#)

1) [TT23471](#) x3

1) [TRE55343](#)

1) [TAT24252](#)

2) [TRE44574](#) (1)

2) [TRE38848](#)

2) [TR74194](#) x6 (4)

2) [TRE31929](#) (3)

2) [TT26321](#)

3) [TAT18031](#)

3) [TR98460](#)

3) [TAT18005](#)

3) [TRE31973](#)

3) [TAT18009](#)

4) [TT20094](#)

4) [TR97341](#)

4) [TR54985](#)

4) [TT20034](#)

5) [TR114282](#) (142T)

5) [TR75729](#)

5) [TR113752](#)

5) [TT20073](#)

6) [TT20070](#)

Valve, Intake

Valve, Exhaust

Insert, Valve

1) Cap, Valve

1) Spring, Valve

1) Intake

2) Lock, Valve

2) Rotator, Valve

2) Exhaust

1) [TR73064](#) Std.

1) [TT20129](#)

1) [TR26125](#)

2) [TR51734](#) Std.

2) [TT20077](#)

2) [TRE11410](#)

[TR79623](#) Std.

[TR79624](#) Std.

[TR79628](#) .003

[TR79625](#) .003

[TR79629](#) .015

[TR79626](#) .015

3) [TR87627](#)

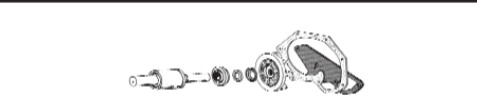
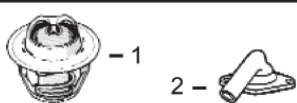

1) Thermostat
2) Thermostat Cover

Fuel Transfer Pump

Water Pump Repair Kit

Injector, Pencil

Seal

1) [TRE33705](#) 180° F (2)
2) [TT23620](#)

[TRE42211](#)

Without Impeller

With Impeller

[TAR89564](#)

[TR60746](#)

[TR48000](#)

[TRE19507](#)

[TRE62658](#)

(1) Do not use with Flywheel Housing (m) T20300, T22991.

(2) Do not use with Housing (m) R54096, R70741, R74549.

(3) Conversion Kit [TMX386](#): Available Consists of: [TT31306](#) x1 Nipple [TR99802](#) x2 Hose.

(4) Use [TR74194](#) with C.Rod (m) T20007; use [TR80033](#) with C.Rod (m) R81410.