

300 Series

Engine & Equipment
Model

3.152

> 154,765

O'rings on liner

3 Cyl.

Bore: 3.86 in
98 mm
Pin Ø: 1.185 in
30 mm

Block (m):

T24963, T26935

Con Rod (m):

T20007, R81410

APPLICATIONS:

AGRICULTURAL

820
1020
1030

CONSTRUCTION

300
300A
350A
350B
380

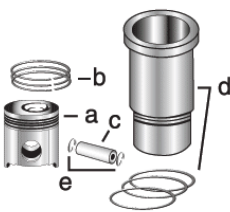

1) Engine O/H Kit

Piston-Liner Kit

Main Bearing

Thrust Bearing

Con Rod Bearing

2) Engine I/F Kit

[TPLK481](#)

Consists of:

- a) [TT23481](#)
- b) [TAR70633](#)
- c) [TT23482](#)
- d) [TAR51902](#)
- e) [TR51112](#)

[TRE27352](#) Std.

[TRE27353](#) .010

[TRE27360](#) .020

[TRE27368](#) .030

[TAT21139](#) Std.

[TAT21132](#) .010

[TAT21134](#) .020

[TAT21136](#) .030

[TRE27348](#) Std.

[TRE27349](#) .010

[TRE27358](#) .020

[TRE27364](#) .030

Use 3

Use 1

Use 3

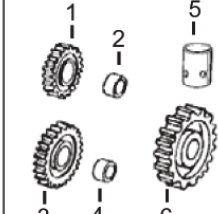
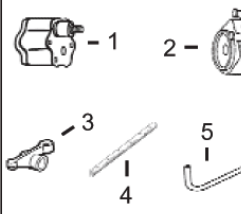
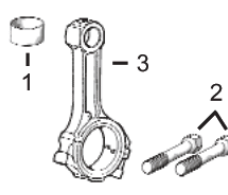
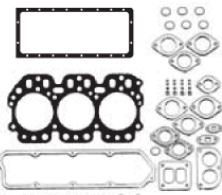
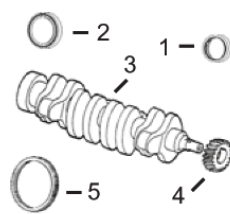

1) Front Seal
2) Rear Seal

1) O/H Gasket Set

1) Bush, Con Rod
2) Bolt, Con Rod

1) Pump, Oil
2) Oil Cooler
3) Rocker Arm
4) Rocker Shaft
5) Pump, Oil Tube

1) Lower Gear
2) Lower Bushing
3) Upper Gear
4) Upper Bushing
5) Cam. Follower
6) Cam. Gear

3) Crankshaft
4) Crankshaft, Gear
5) Ring Gear

2) Head Gasket Set
3) Head Gasket
4) Oil Pan Gasket
5) Rocker Cover Gsk

3) Con Rod

1) [TAR67942](#)
2) [TRE44574](#) (1)
3) [TAT18031](#)
4) [TT20094](#)
5) [TR114282](#) (142T)

1) [TRE38570](#)
2) [TRE38848](#)
3) [TR98460](#)
4) [TR97341](#)
5) [TR75729](#)

1) [TT23471](#) x3
2) [TR74194](#) x6 (4)
3) [TAT18005](#)

1) [TRE55343](#)
2) [TRE31929](#) (3)
3) [TRE31973](#)
4) [TR54985](#)
5) [TR113752](#)

1) [TAT24252](#)
2) [TT26321](#)
3) [TAT18009](#)
4) [TT20034](#)
5) [TT20073](#)
6) [TT20070](#)

Valve, Intake

Valve, Exhaust

Insert, Valve

1) Cap, Valve
2) Lock, Valve

1) Spring, Valve
2) Rotator, Valve
3) O'ring, Valve



[TR79623](#) Std.
[TR79628](#) .003
[TR79629](#) .015

[TR79624](#) Std.
[TR79625](#) .003
[TR79626](#) .015

1) [TR73064](#) Std.
2) [TR51734](#) Std.

1) [TT20129](#)
2) [TT20077](#)

1) [TR26125](#)
2) [TRE11410](#)
3) [TR87627](#)

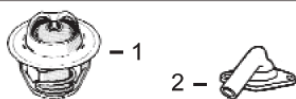

1) [TRE33705](#) 180° F (2)
2) [TT23620](#)

Fuel Transfer Pump

[TRE42211](#)

Water Pump Repair Kit

Without Impeller

With Impeller

[TRE19507](#)

[TRE62658](#)

Injector, Pencil

[TAR89564](#)

Seal

[TR60746](#)
[TR48000](#)

(1) Do not use with Flywheel Housing (m) T20300, T22991.

(2) Do not use with Housing (m) R54096, R70741, R74549.

(3) Conversion Kit [TMX386](#): Available Consists of: [TT31306](#) x1 Nipple [TR99802](#) x2 Hose.

(4) Use [TR74194](#) with C.Rod (m) T20007; use [TR80033](#) with C.Rod (m) R81410.