

300 Series
Engine & Equipment
Model

4.219 (1)

275,484 >

O'Rings on block

Large Pin

4 Cyl

Bore: 4.02 in
 102 mm
 Pin Ø: 1.375 in
 35 mm

Con Rod (m):
 R51727, R80034

APPLICATIONS:

AGRICULTURAL

499 2270
 1035 2280
 1130 2320
 1635 2440
 2030 2530
 2035 3300
 2120

CONSTRUCTION

310/B 450C/D
 401B/C/D 455D
 410/B 480B/C
 440B 540B

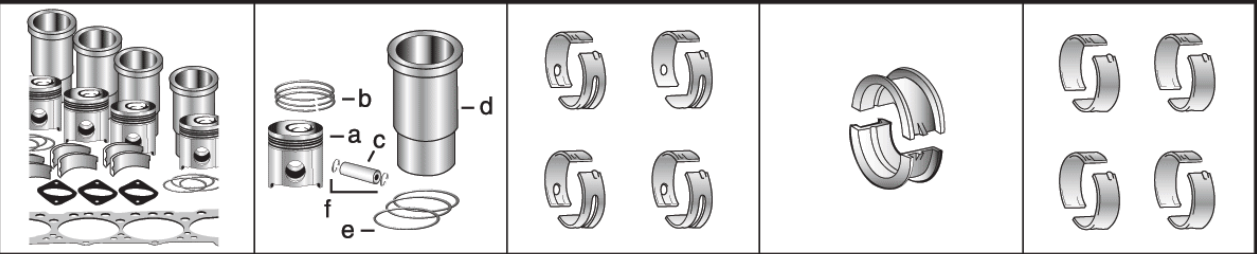

1) Engine O/H Kit	Piston-Liner Kit	Main Bearing	Thrust Bearing	Con Rod Bearing
2) Engine I/F Kit	TAR78041 Consists of:	<u>TRE27352</u> Std.	<u>TAT21139</u> Std.	<u>TRE27348</u> Std.
1) <u>TAT86984</u>	a) <u>TAR77762</u>	<u>TRE27353</u> .010	<u>TAT21132</u> .010	<u>TRE27349</u> .010
	b) <u>TAR55759</u>	<u>TRE27360</u> .020	<u>TAT21134</u> .020	<u>TRE27358</u> .020
2) <u>TIK86984</u>	c) <u>TR125754</u>	<u>TRE27368</u> .030	<u>TAT21136</u> .030	<u>TRE27364</u> .030
	d) <u>TR116463</u>			
	e) <u>TAR71618</u>			
	f) <u>TM41029</u>	Use 4	Use 1	Use 4

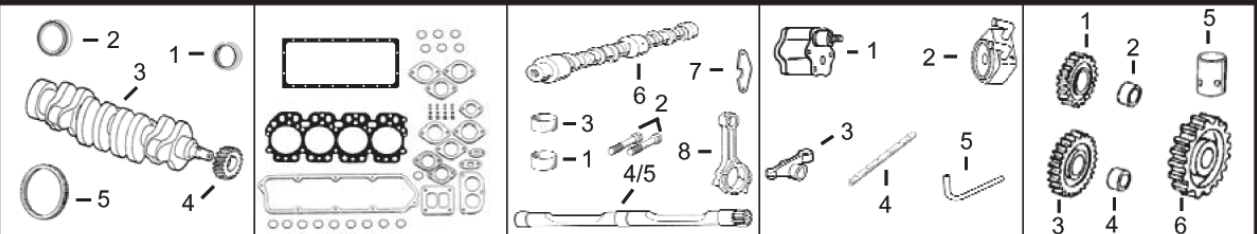

1) Front Seal 2) Rear Seal	1) O/H Gasket Set	1) Bush, Con Rod 2) Bolt, Con Rod 3) Bush, Bal. Shaft	1) Pump, Oil 2) Oil Cooler 3) Rocker Arm 4) Rocker Shaft 5) Pump, Oil Tube	1) Lower Gear 2) Lower Bushing 3) Upper Gear 4) Upper Bushing 5) Cam. Follower 6) Cam. Gear
3) Crankshaft 4) Crankshaft, Gear 5) Ring Gear	2) Head Gasket Set 3) Head Gasket 4) Oil Pan Gasket 5) Rocker Cover Gsk	4) Bal. Shaft R/H 5) Bal. Shaft L/H 6) Camshaft 7) Bal. Shaft Stop 8) Con Rod		
1) <u>TAR67942</u> 2) <u>TRE44574</u> 3) <u>TAT18030</u> 4) <u>TT20094</u> 5) <u>TR114282</u> (142T)	1) <u>TRE501579</u> 2) <u>TRE38851</u> 3) <u>TR125863</u> 4) <u>TR97342</u> 5) <u>TR73521</u>	1) <u>TR55647</u> x4 2) <u>TR74194</u> x8 (2) 3) <u>TR57160</u> x6 (5) 4) <u>TRE26282</u> R/H 5) <u>TRE26283</u> L/H 6) <u>TR82820</u> (4) 7) <u>TR88112</u> 8) <u>TRE16495</u>	1) <u>TRE55343</u> 2) <u>TRE31929</u> 3) <u>TRE31973</u> 4) <u>TR54987</u> 5) <u>TR113752</u>	1) <u>TAT24252</u> 2) <u>TT26321</u> 3) <u>TAT18009</u> 4) <u>TT20034</u> 5) <u>TT20073</u> 6) <u>TT20070</u>

Valve, Intake	Valve, Exhaust	Insert, Valve 1) Intake 2) Exhaust	1) Cap, Valve 2) Lock, Valve	1) Spring, Valve 2) Rotator, Valve 3) O'ring, Valve
<u>TR79623</u> Std. <u>TR79628</u> .003 <u>TR79629</u> .015	<u>TR79624</u> Std. <u>TR79625</u> .003 <u>TR79626</u> .015	1) <u>TR73064</u> Std. 2) <u>TR51734</u> Std.	1) <u>TT20129</u> 2) <u>TT20077</u>	1) <u>TR26125</u> 2) <u>TRE11410</u> 3) <u>TR87627</u>

1) Thermostat 2) Thermostat Cover	Fuel Transfer Pump	Water Pump Rep Kit a) Without Impeller b) With Impeller	Water Pump	Injector, Pencil	Seal
1) <u>TRE33705</u> 180° F (3) 2) <u>TT23620</u>	<u>TRE42211</u>	a) <u>TRE19507</u> b) <u>TRE62658</u>	<u>TAT27018</u> (m) R48997, (m) R51039	<u>TAR89564</u>	<u>TR60746</u> <u>TR48000</u>

(1) Some of these engines maybe turbocharged.
 (2) For Connecting Rods RE16495 and RE21076 Use Connecting Rod Bolt TR80033.
 (3) Do not use with Housing (m) R54096, R70741, R74549.
 (4) Threaded Type.
 (5) TR91708 (Outer Diam. 2.00 mm / 0.078 in) Larger and TR57160R (Inner Diam 0.5 mm / 0.020 in) Smaller, are also available.