

300 Series

Engine & Equipment
Model

3.164

179,602 >

O'Rings on Block
Large Pin

3 Cyl

Bore: 4.02 in
102 mm
Pin Ø: 1.375 in
35 mm

APPLICATIONS:

AGRICULTURAL

1530
2040
2330

CONSTRUCTION

301A
302
302A
310
350B
350C
350D

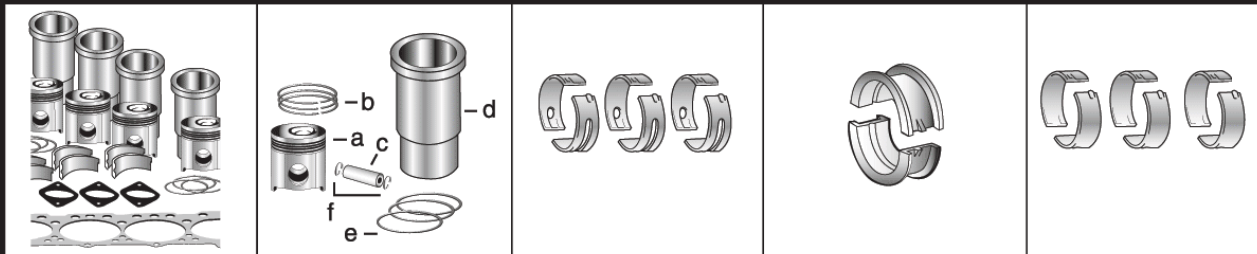

1) Engine O/H Kit	Piston-Liner Kit	Main Bearing	Thrust Bearing	Con Rod Bearing
2) Engine I/F Kit	TAR78041 Consists of:	TRE27352 Std.	TAT21139 Std.	TRE27348 Std.
1) TOK3041	a) TAR77762	TRE27353 .010	TAT21132 .010	TRE27349 .010
2) TIK3041	b) TAR55759	TRE27360 .020	TAT21134 .020	TRE27358 .020
	c) TR125754	TRE27368 .030	TAT21136 .030	TRE27364 .030
	d) TR116463			
	e) TAR71618			
	f) TM41029	Use 3	Use 1	Use 3

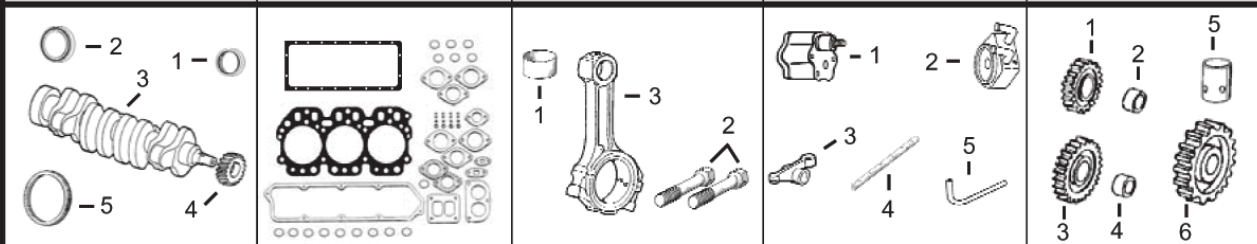

1) Front Seal 2) Rear Seal	1) O/H Gasket Set	1) Bush, Con Rod 2) Bolt, Con Rod	1) Pump, Oil 2) Oil Cooler 3) Rocker Arm 4) Rocker Shaft 5) Pump, Oil Tube	1) Lower Gear 2) Lower Bushing 3) Upper Gear 4) Upper Bushing 5) Cam. Follower 6) Cam. Gear
3) Crankshaft 4) Crankshaft, Gear 5) Ring Gear	2) Head Gasket Set 3) Head Gasket 4) Oil Pan Gasket 5) Rocker Cover Gsk	3) Con Rod		
1) TAR67942 2) TRE44574 3) TAT18031 4) TT20094 5) TR114282 (142T)	1) TRE501578 2) TRE38850 3) TR97356 4) TR97341 5) TR75729	1) TR55647 x3 2) TR74194 x6 3) TRE16495 (3)	1) TRE55343 2) TRE31929 (2) 3) TRE31973 4) TR54985 5) TR113752	1) TAT24252 2) TT26321 3) TAT18009 4) TT20034 5) TT20073 6) TT20070

Valve, Intake	Valve, Exhaust	Insert, Valve 1) Intake 2) Exhaust	1) Cap, Valve 2) Lock, Valve	1) Spring, Valve 2) Rotator, Valve 3) O'ring, Valve
TR79623 Std. TR79628 .003 TR79629 .015	TR79624 Std. TR79625 .003 TR79626 .015	1) TR73064 Std. 2) TR51734 Std.	1) TT20129 2) TT20077	1) TR26125 2) TRE11410 3) TR87627

1) Thermostat 2) Thermostat Cover	Fuel Transfer Pump	Water Pump Rep Kit a) Without Impeller b) With Impeller	Water Pump	Transmission Oil Pump	1) Seal 2) Injector, Pencil
1) TRE33705 180° F (1) 2) TT23620	TRE42211	a) TRE19507 b) TRE62658	TAT27018 (m) R48997, (m) R51039	TAL120106	1) TR60746 TR48000 2) TAR89564
				Verify P/N for your application	

(1) Do not use with Housing (m) R54096, R70741, R74549.
 (2) Conversion Kit **TMX386** Consists of **TT31306 x1** Nipple **TR99802 x2** Hose.
 (3) For Connecting Rods RE16495 and RE21076 Use Connecting Rod Bolt **TR80033**.