

300 Series
Engine & Equipment
Model

4.202

> 158,257

O'rings on liner

4 Cyl

Bore: 3.86 in (2)
 98 mm
 Pin Ø: 1.185 in
 30 mm

Block (m):
 T23406, T24961,
 T26933

APPLICATIONS:

AGRICULTURAL

2020
 2510

CONSTRUCTION

400
 440
 450
 480

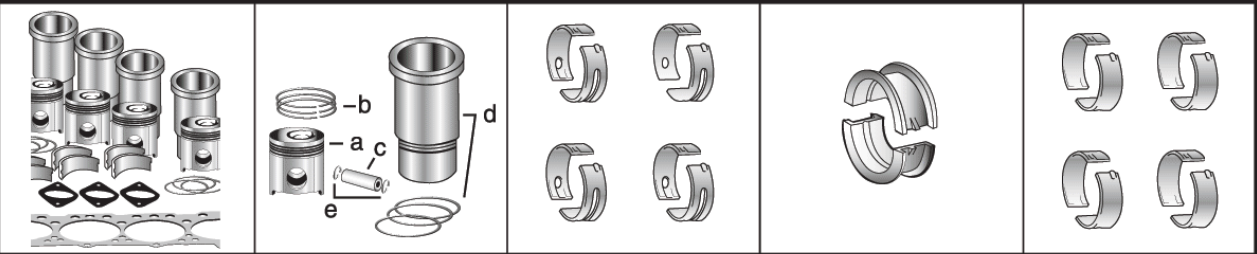

1) Engine O/H Kit **Piston-Liner Kit** **Main Bearing** **Thrust Bearing** **Con Rod Bearing**

2) Engine I/F Kit **TPLK481** **TRE27352** Std. **TAT21139** Std. **TRE27348** Std.

1) TOK4481 Consists of: **TRE27353** .010 **TAT21132** .010 **TRE27349** .010
2) TIK4481 a) **TT23481** **TRE27360** .020 **TAT21134** .020 **TRE27358** .020
 c) **TT23482** **TRE27368** .030 **TAT21136** .030 **TRE27364** .030
 d) **TAR51902**
 e) **TR51112**

Use 4

Use 1

Use 4

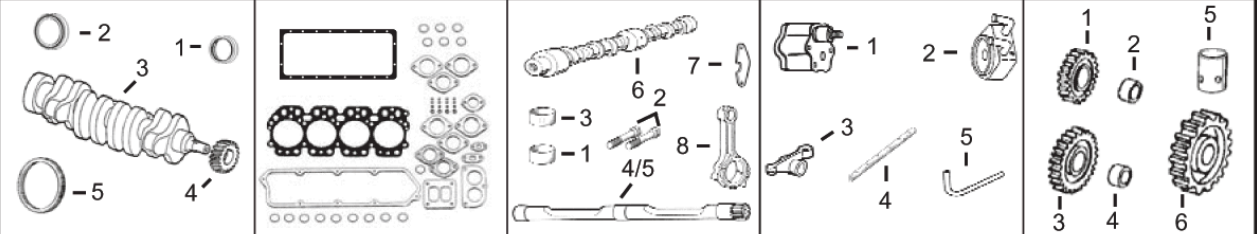

1) Front Seal **1) O/H Gasket Set** **1) Bush, Con Rod** **1) Pump, Oil** **1) Lower Gear**
2) Rear Seal **2) Head Gasket Set** **2) Bolt, Con Rod** **2) Oil Cooler** **2) Lower Bushing**
3) Crankshaft **3) Head Gasket** **3) Bush, Bal. Shaft** **3) Rocker Arm** **3) Upper Gear**
4) Crankshaft, Gear **4) Oil Pan Gasket** **4) Bal. Shaft R/H** **4) Rocker Shaft** **4) Upper Bushing**
5) Ring Gear **5) Rocker Cover Gsk** **5) Bal. Shaft L/H** **5) Pump, Oil Tube** **5) Cam. Follower**
6) Cam. Gear

1) TAR67942 **1) TRE38558** **1) TT23471 x4** **1) TRE55343** **1) TAT24252**
2) TRE44574 (1) **2) TRE38847** **2) TR74194 x8 (3)** **2) TRE31929** **2) TT26321**
3) TAT18030 **3) TR98461** **3) TR57160 x6 (6)** **3) TRE31973** **3) TAT18009**
4) TT20094 **4) TR97342** **4) TRE26282 R/H** **4) TR54987** **4) TT20034**
5) TR114282 (142T) **5) TR73521** **5) TRE26283 L/H** **5) TR113752** **5) TT20073**
6) TT20070

Valve, Intake **Valve, Exhaust** **Insert, Valve** **1) Cap, Valve** **1) Spring, Valve**
1) Intake **1) Intake** **1) Intake** **2) Lock, Valve** **2) Rotator, Valve**
2) Exhaust **2) Exhaust** **2) Exhaust** **3) O'ring, Valve**

TR79623 Std. **TR79624** Std. **1) TR73064** Std. **1) TT20129** **1) TR26125**
TR79628 .003 **TR79625** .003 **2) TR51734** Std. **2) TT20077** **2) TRE11410**
TR79629 .015 **TR79626** .015 **3) TR87627**



1) Thermostat **Fuel Transfer Pump** **Water Pump Repair Kit** **Injector, Pencil** **Seal**
2) Thermostat Cover

1) TRE33705 180° F (4) **TRE42211** **Without Impeller** **With Impeller** **TAR89564** **TR60746**
2) TT23620 **TRE19507** **TRE62658** **TR48000**

(1) Do not use with Flywheel Housing (m) T20300, T22991. (5) Threaded Type.
 (2) Always verify Bore diameter, on Block Replacement is 4.016"/102mm. (6) TR91708 (Outer Diam. 2.00 mm / 0.078 in) Larger and TR57160R (Inner Diam 0.5 mm / 0.020 in) Smaller, are also available.
 (3) Use TR74194 with C.Rod (m) T20007; use TR80033 with C.Rod (m) R81410.
 (4) Do not use with Housing (m) R54096, R70741, R74549.