

# 300 Series

Engine & Equipment  
Model

## 3.164

179,602 >

O'Rings on Block  
Large Pin

3 Cyl

Bore: 4.02 in  
102 mm  
Pin Ø: 1.375 in  
35 mm

### APPLICATIONS:

#### AGRICULTURAL

1530  
2040  
2330

#### CONSTRUCTION

301A  
302  
302A  
310  
350B  
350C  
350D

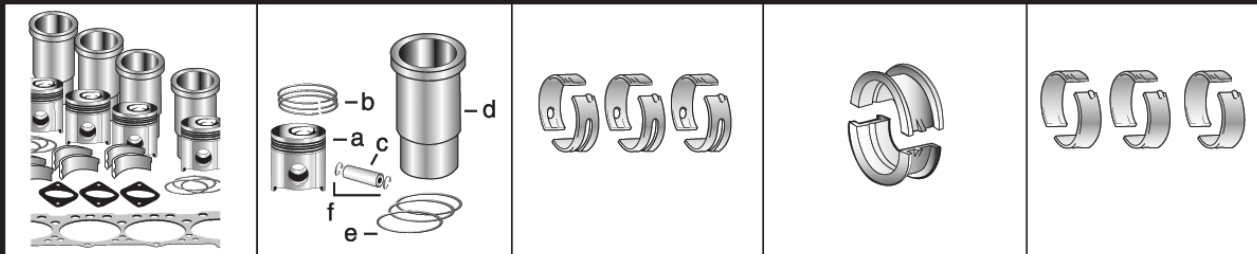

1) Engine O/H Kit	Piston-Liner Kit	Main Bearing	Thrust Bearing	Con Rod Bearing
-------------------	------------------	--------------	----------------	-----------------

2) Engine I/F Kit	<b>TAR78041</b> Consists of:	<u>TRE27352</u> Std.	<u>TAT21139</u> Std.	<u>TRE27348</u> Std.
1) <u>TOK3041</u>	a) <u>TAR77762</u>	<u>TRE27353</u> .010	<u>TAT21132</u> .010	<u>TRE27349</u> .010
2) <u>TIK3041</u>	b) <u>TAR55759</u>	<u>TRE27360</u> .020	<u>TAT21134</u> .020	<u>TRE27358</u> .020
	c) <u>TR125754</u>	<u>TRE27368</u> .030	<u>TAT21136</u> .030	<u>TRE27364</u> .030
	d) <u>TR116463</u>			
	e) <u>TAR71618</u>			
	f) <u>TM41029</u>			
		<b>Use 3</b>	<b>Use 1</b>	<b>Use 3</b>

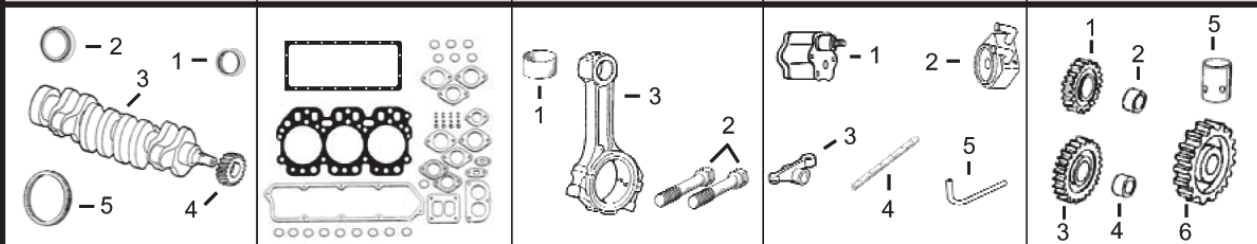

1) Front Seal 2) Rear Seal	1) O/H Gasket Set	1) Bush, Con Rod 2) Bolt, Con Rod	1) Pump, Oil 2) Oil Cooler 3) Rocker Arm 4) Rocker Shaft 5) Pump, Oil Tube	1) Lower Gear 2) Lower Bushing 3) Upper Gear 4) Upper Bushing 5) Cam. Follower 6) Cam. Gear
3) Crankshaft 4) Crankshaft, Gear 5) Ring Gear	2) Head Gasket Set 3) Head Gasket 4) Oil Pan Gasket 5) Rocker Cover Gsk	3) Con Rod		

1) <u>TAR67942</u> 2) <u>TRE44574</u> 3) <u>TAT18031</u> 4) <u>TT20094</u> 5) <u>TR114282</u> (142T)	1) <u>TRE501578</u> 2) <u>TRE38850</u> 3) <u>TR97356</u> 4) <u>TR97341</u> 5) <u>TR75729</u>	1) <u>TR55647</u> x3 2) <u>TR74194</u> x6 3) <u>TRE16495</u> (3)	1) <u>TRE55343</u> 2) <u>TRE31929</u> (2) 3) <u>TRE31973</u> 4) <u>TR54985</u> 5) <u>TR113752</u>	1) <u>TAT24252</u> 2) <u>TT26321</u> 3) <u>TAT18009</u> 4) <u>TT20034</u> 5) <u>TT20073</u> 6) <u>TT20070</u>
--	--	--	---	--

Valve, Intake	Valve, Exhaust	Insert, Valve 1) Intake 2) Exhaust	1) Cap, Valve 2) Lock, Valve	1) Spring, Valve 2) Rotator, Valve 3) O'ring, Valve
<u>TR79623</u> Std. <u>TR79628</u> .003 <u>TR79629</u> .015	<u>TR79624</u> Std. <u>TR79625</u> .003 <u>TR79626</u> .015	1) <u>TR73064</u> Std. 2) <u>TR51734</u> Std.	1) <u>TT20129</u> 2) <u>TT20077</u>	1) <u>TR26125</u> 2) <u>TRE11410</u> 3) <u>TR87627</u>

1) Thermostat 2) Thermostat Cover	Fuel Transfer Pump	Water Pump Rep Kit a) Without Impeller b) With Impeller	Water Pump	Transmission Oil Pump	1) Seal 2) Injector, Pencil
1) <u>TRE33705</u> 180° F (1) 2) <u>TT23620</u>	<u>TRE42211</u>	a) <u>TRE19507</u> b) <u>TRE62658</u>	<u>TAT27018</u> (m) R48997, (m) R51039	<u>TAL120106</u>  Verify P/N for your application	1) <u>TR60746</u> <u>TR48000</u> 2) <u>TAR89564</u>

(1) Do not use with Housing (m) R54096, R70741, R74549.  
 (2) Conversion Kit TMX386 Consists of TT31306 x1 Nipple TR99802 x2 Hose.  
 (3) For Connecting Rods RE16495 and RE21076 Use Connecting Rod Bolt TR80033.