

300 Series
Engine & Equipment
Model

4.239D

4 Cyl

Bore: 4.19 in
 106.5 mm
 Pin Ø: 1.375 in
 35 mm

APPLICATIONS:

AGRICULTURAL

- 940 2450
- 942 2535
- 1640 2550
- 1840 2555CS
- 2130 2650
- 2135 2730
- 2250 2735
- 2350 3330
- 2355 3430
- 2355CS 6602
- 2360

CONSTRUCTION

- 70 400G
- 70D 415B
- 210C 415C
- 244E 490
- 290D 515B
- 310C/D
- 315C

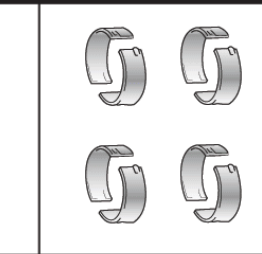
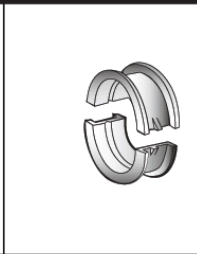
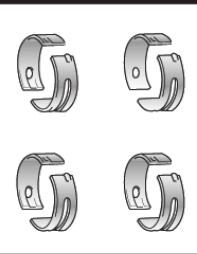
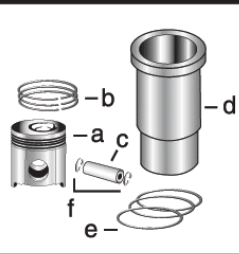
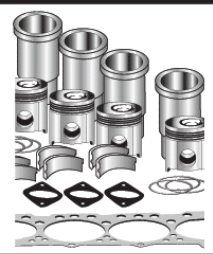

1) Engine O/H Kit **Piston-Liner Kit** **Main Bearing** **Thrust Bearing** **Con Rod Bearing**

2) Engine I/F Kit **TRE30250** **TRE27352** Std. **TAT21139** Std. **TRE27348** Std.

1) TAT86992 Consists of: **TRE27353** .010 **TAT21132** .010 **TRE27349** .010

2) TIK86992 a) **TRE19282** **TRE27360** .020 **TAT21134** .020 **TRE27358** .020

b) **TRE66820** **TRE27368** .030 **TAT21136** .030 **TRE27364** .030

c) **TR125754** **Use 4** **Use 1** **Use 4**

d) **TR116281**

e) **TAR65507**

f) **TM41029**

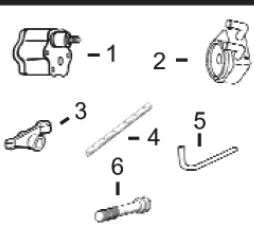
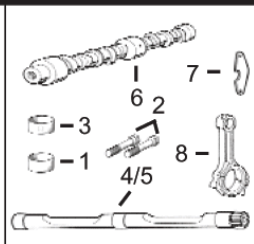
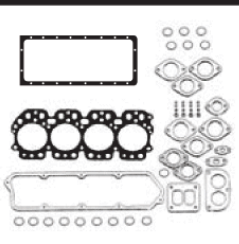
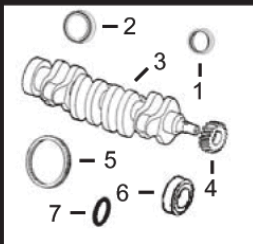

1) Front Seal **1) O/H Gasket Set** **1) Bush, Con Rod** **1) Pump, Oil** **1) Lower Gear**

2) Rear Seal **2) Head Gasket Set** **2) Bolt, Con Rod** **2) Oil Cooler** **2) Lower Bushing**

3) Crankshaft **3) Head Gasket** **3) Bush, Bal. Shaft** **3) Rocker Arm** **3) Upper Gear**

4) Crankshaft, Gear **4) Oil Pan Gasket** **4) Bal. Shaft R/H** **4) Rocker Shaft** **4) Upper Bushing**

5) Ring Gear **5) Rocker Cover Gsk** **5) Bal. Shaft L/H** **5) Pump, Oil Tube** **5) Cam. Follower**

6) Sleeve, Front **6) Camshaft** **6) TR82820** (4) **6) Cyl Hd Cap Screw** **6) Cam. Gear**

7) Packing, Sleeve **7) Bal. Shaft Stop** **7) TR88112** **8) Con Rod** **8) TRE16495**

1) TAR67942 **1) TRE501579** **1) TR55647 x4** **1) TRE55343** **1) TAT24252**

2) TRE44574 **2) TRE38851** **2) TR80033 x8 (3)** **2) TRE31929** **2) TT26321**

3) TAT18030 (1) **3) TR125863** **3) TR57160 x6 (5)** **3) TRE31973** **3) TAT18009**

or **4) TR97342** **4) TRE26282 R/H (*)** **4) TR54987** **4) TT20034**

TRE20585 (2) **5) TR73521** **5) TRE26283 L/H (*)** **5) TR113752** **5) TT20073**

4) TT20094 **6) TR82820 (4)** **6) TR85363 x18 (6)** **6) TR85363 x18 (6)** **6) TT20070**

5) TR114282 (142T) **7) TR88112** **7) TR85363 x18 (6)** **7) TR85363 x18 (6)** **7) TT20070**

6) TR81989 **8) TRE16495** **8) TRE16495** **8) TRE16495** **8) TT20070**

7) TH35244 **9) TR73064 Std.** **9) TR73064 Std.** **9) TR73064 Std.** **9) TR73064 Std.**

1) Valve, Intake **1) Valve, Exhaust** **1) Intake** **1) Cap, Valve** **1) Spring, Valve**

2) Valve, Intake **2) Valve, Exhaust** **2) Exhaust** **2) Lock, Valve** **2) Rotator, Valve**

3) Valve, Intake **3) Valve, Exhaust** **3) O'ring, Valve** **3) TT20129** **3) O'ring, Valve**

1) TR79623 Std. **1) TR79624 Std.** **1) TR73064 Std.** **1) TT20129** **1) TR26125**

2) TR79628 .003 **2) TR79625 .003** **2) TR51734 Std.** **2) TT20077** **2) TRE11410**

3) TR79629 .015 **3) TR79626 .015** **3) TR73064 Std.** **3) TT20077** **3) TR87627**

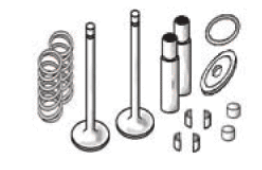

Valve, Intake

Valve, Exhaust

Insert, Valve

1) Cap, Valve
2) Lock, Valve

1) Spring, Valve
2) Rotator, Valve
3) O'ring, Valve



1) Thermostat
2) Thermostat Cover

Fuel Transfer Pump



Water Pump Rep Kit
a) Without Impeller
b) With Impeller

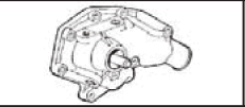

Water Pump

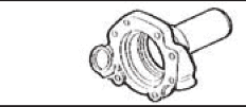

Transmission Oil Pump

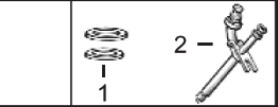

1) Seal
2) Injector, Pencil

1) **TRE33705** 180° F
2) **TT23620**

TRE42211

a) **TRE19507**
b) **TRE62658**

TAR97708
(m) R73604

TAL120106 **TAL68094**

1) **TR60746**
TR48000
2) **TAR89564**

Verify P/N for your application

(*) If these engines use bolt on weights shafts use **TAR69710** RH and **TAR69711** LH.
 (1) **TAT18030** Crankshaft 36mm (short) snout, (m) T23517.
 (2) **TRE20585** Crankshaft 60mm (long) snout, (m) R81959 or R121018.
 (3) For Connecting Rod (m) R58979, use **TR74194** Connecting Rod Bolt available upon request.
 (4) Threaded Type.
 (5) **TR91708** (Outer Diam. 2.00 mm / 0.078 in) Larger and **TR57160R** (Inner Diam 0.5 mm / 0.020 in) Smaller, are also available.
 (6) Replace all R78558 Cap Screws with Flanged Head Cap Screw **TR85363**.