

300 Series
Engine & Equipment
Model

4.239D

4 Cyl

Bore: 4.19 in
 106.5 mm
 Pin Ø: 1.375 in
 35 mm

APPLICATIONS:

AGRICULTURAL

- 940 2450
- 942 2535
- 1640 2550
- 1840 2555CS
- 2130 2650
- 2135 2730
- 2250 2735
- 2350 3330
- 2355 3430
- 2355CS 6602
- 2360

CONSTRUCTION

- 70 400G
- 70D 415B
- 210C 415C
- 244E 490
- 290D 515B
- 310C/D
- 315C

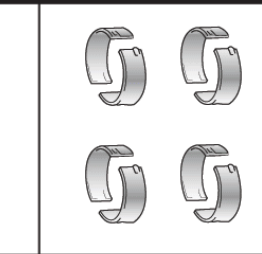
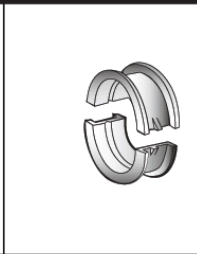
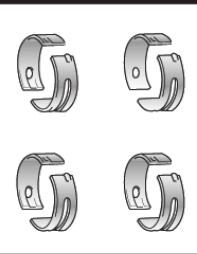
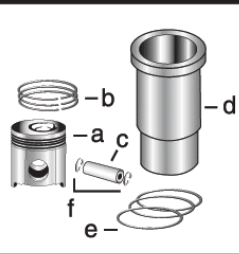
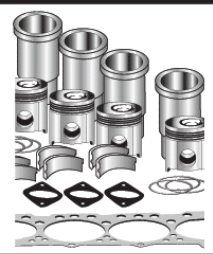

1) Engine O/H Kit **Piston-Liner Kit** **Main Bearing** **Thrust Bearing** **Con Rod Bearing**

2) Engine I/F Kit **TRE30250** **TRE27352** Std. **TAT21139** Std. **TRE27348** Std.

1) TAT86992 Consists of: **TRE27353** .010 **TAT21132** .010 **TRE27349** .010
2) TIK86992 a) **TRE19282** **TRE27360** .020 **TAT21134** .020 **TRE27358** .020
 c) **TR125754** **TRE27368** .030 **TAT21136** .030 **TRE27364** .030
 d) **TR116281**
 e) **TAR65507**
 f) **TM41029**

Use 4

Use 1

Use 4

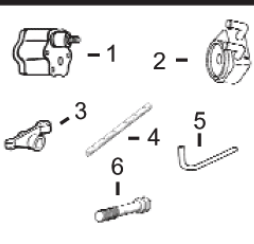
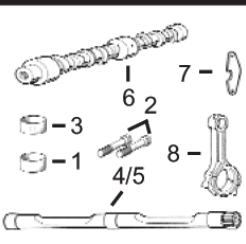
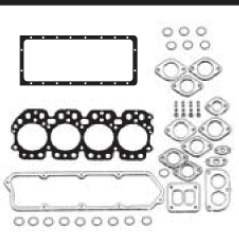
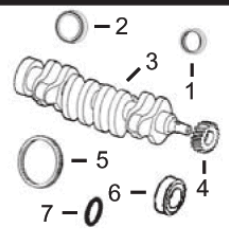

1) Front Seal **1) O/H Gasket Set** **1) Bush, Con Rod** **1) Pump, Oil** **1) Lower Gear**
2) Rear Seal **2) Head Gasket Set** **2) Bolt, Con Rod** **2) Oil Cooler** **2) Lower Bushing**
3) Crankshaft **3) Head Gasket** **3) Bush, Bal. Shaft** **3) Rocker Arm** **3) Upper Gear**
4) Crankshaft, Gear **4) Oil Pan Gasket** **4) Bal. Shaft R/H** **4) Rocker Shaft** **4) Upper Bushing**
5) Ring Gear **5) Rocker Cover Gsk** **5) Bal. Shaft L/H** **5) Pump, Oil Tube** **5) Cam. Follower**
6) Sleeve, Front **6) Camshaft** **6) Camshaft Stop** **6) Cyl Hd Cap Screw** **6) Cam. Gear**
7) Packing, Sleeve **7) Bal. Shaft Stop**
8) Con Rod

1) TAR67942 **1) TRE501579** **1) TR55647 x4** **1) TRE55343** **1) TAT24252**
2) TRE44574 **2) TRE38851** **2) TR80033 x8 (3)** **2) TRE31929** **2) TT26321**
3) TAT18030 (1) **3) TR125863** **3) TR57160 x6 (5)** **3) TRE31973** **3) TAT18009**
 or **4) TR97342** **4) TRE26282 R/H (*)** **4) TR54987** **4) TT20034**
TRE20585 (2) **5) TR73521** **5) TRE26283 L/H (*)** **5) TR113752** **5) TT20073**
4) TT20094 **6) TR82820 (4)** **6) TR88112** **6) TR85363 x18 (6)** **6) TT20070**
5) TR114282 (142T)
6) TR81989
7) TH35244

1) Valve, Intake **Valve, Exhaust** **Insert, Valve** **1) Cap, Valve** **1) Spring, Valve**
1) Intake **1) Intake** **1) Intake** **2) Lock, Valve** **2) Rotator, Valve**
2) Exhaust **2) Exhaust** **2) Exhaust** **2) TT20129** **3) O'ring, Valve**
1) TR79623 Std. **TR79624 Std.** **1) TR73064 Std.** **1) TT20077** **1) TR26125**
TR79628 .003 **TR79625 .003** **2) TR51734 Std.** **2) TT20077** **2) TRE11410**
TR79629 .015 **TR79626 .015** **1) TR87627**

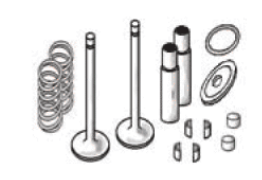

1) Thermostat
2) Thermostat Cover
1) TRE33705 180° F
2) TT23620

Fuel Transfer Pump
TRE42211

Water Pump Rep Kit
 a) Without Impeller
 b) With Impeller
a) TRE19507
b) TRE62658

Water Pump
TAR97708
 (m) R73604

Transmission Oil Pump
TAL120106 **TAL68094**
 Verify P/N for your application

1) Seal
2) Injector, Pencil
1) TR60746
TR48000
2) TAR89564

(*) If these engines use bolt on weights shafts use **TAR69710** RH and **TAR69711** LH.
 (1) **TAT18030** Crankshaft 36mm (short) snout, (m) T23517.
 (2) **TRE20585** Crankshaft 60mm (long) snout, (m) R81959 or R121018.
 (3) For Connecting Rod (m) R58979, use **TR74194** Connecting Rod Bolt available upon request.
 (4) Threaded Type.
 (5) **TR91708** (Outer Diam. 2.00 mm / 0.078 in) Larger and **TR57160R** (Inner Diam 0.5 mm / 0.020 in) Smaller, are also available.
 (6) Replace all R78558 Cap Screws with Flanged Head Cap Screw **TR85363**.