

300 Series
Engine & Equipment
Model

4.239T

4 Cyl

Bore: 4.19 in
 106.5 mm

Pin Ø: 1.625 in
 41 mm

Con Rod (m):
 R80032, R113612,
 R122191

APPLICATIONS:

AGRICULTURAL

- 945 2750
- 952 2755
- 1052 2755 CS/TSS
- 1155 2850
- 2140 2855
- 2450 2855N
- 2555 3430
- 2555 TSS 3830
- 2650

CONSTRUCTION

- 310 C/D (Turbo)
- 315 C/D (Turbo)
- 515B

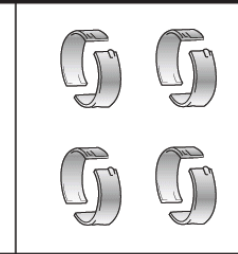
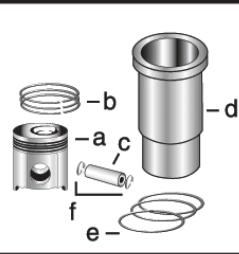

1) Engine O/H Kit **Piston-Liner Kit** **Main Bearing** **Thrust Bearing** **Con Rod Bearing**

2) Engine I/F Kit **TRE33115** **TRE27352** Std. **TAT21139** Std. **TRE27348** Std.

1) TRE54709 Consists of: **TRE27353** .010 **TAT21132** .010 **TRE27349** .010

2) TIK54709 a) **TRE19278** **TRE27360** .020 **TAT21134** .020 **TRE27358** .020

b) **TRE66820** **TRE27368** .030 **TAT21136** .030 **TRE27364** .030

c) **TR124230**

d) **TR116281**

e) **TAR65507**

f) **TR54114**

Use 4

Use 1

Use 4

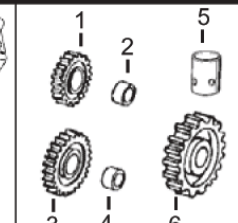
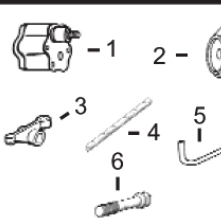
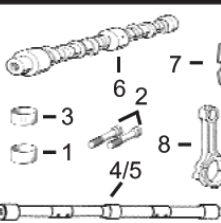
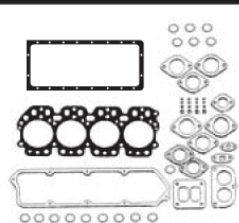
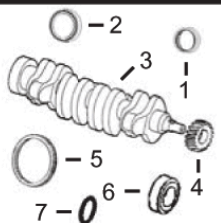

1) Front Seal **1) O/H Gasket Set** **1) Bush, Con Rod** **1) Pump, Oil** **1) Lower Gear**

2) Rear Seal **2) Head Gasket Set** **2) Bolt, Con Rod** **2) Oil Cooler** **2) Lower Bushing**

3) Crankshaft **3) Head Gasket** **3) Bush, Bal. Shaft** **3) Rocker Arm** **3) Upper Gear**

4) Crankshaft, Gear **4) Oil Pan Gasket** **4) Bal. Shaft R/H** **4) Rocker Shaft** **4) Upper Bushing**

5) Ring Gear **5) Rocker Cover Gsk** **5) Bal. Shaft L/H** **5) Pump, Oil Tube** **5) Cam. Follower**

6) Sleeve, Front **6) Camshaft** **6) Bal. Shaft Stop** **6) Cyl Hd Cap Screw** **6) Cam. Gear**

7) Packing, Sleeve **7) Bal. Shaft Stop** **8) Con Rod**

1) TAR67942 **1) TRE501579** **1) TR57451 x4** **1) TRE55343 (2)** **1) TAT24252**

2) TRE44574 **2) TRE38851** **2) TR80033 x8** **2) TRE31929** **2) TT26321**

3) TAT18030 (1) **3) TR125863** **3) TR57160 x6 (3)** **3) TRE31973** **3) TAT18009**

or **4) TR97342** **4) TRE26282 R/H (*)** **4) TR54987** **4) TT20034**

4) TT20094 (4) **5) TR73521** **5) TRE26283 L/H (*)** **5) TR113752** **5) TT20073**

5) TR114282 (142T) **6) TR82820 (5)** **6) TR85363 x18 (6)** **6) TT20070**

6) TR81989

7) TH35244

1) Valve, Intake **Valve, Exhaust** **Insert, Valve** **1) Cap, Valve** **1) Spring, Valve**

2) Lock, Valve **1) Intake** **2) Lock, Valve** **2) Rotator, Valve**

2) Exhaust **2) Exhaust** **3) O'ring, Valve**

TR83071 Std. **TR79624** Std. **1) TR73064** Std. **1) TT20129** **1) TR26125**

TR89223 .003 **TR79625** .003 **2) TR51734** Std. **2) TT20077** **2) TRE11410**

TR89224 .015 **TR79626** .015 **3) TR87627**

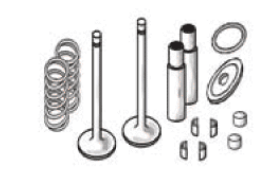

1) Thermostat

2) Thermostat Cover

1) TAR48675 180° F

2) TT23620

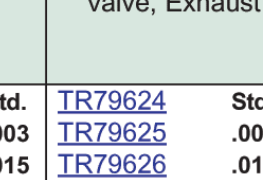

Fuel Transfer Pump

TRE42211

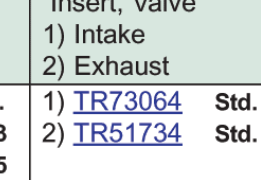

Water Pump Rep Kit

a) Without Impeller

b) With Impeller

See Chart

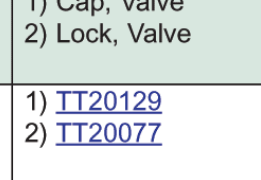

Water Pump

TAR97708

(m) R73604

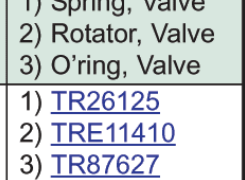

Transmission Oil Pump

TAL120106 **TAL68094**

Verify P/N for your application



1) Seal

2) Injector, Pencil

1) TR60746

TR48000

2) TRE37503

(*) If these engines use bolt on weights shafts use **TAR69710** RH and **TAR69711** LH.

(1) **TAT18030** Crankshaft 36mm (short) snout, (m) T23517.

(2) May use High Capacity Pump, Oil **TRE65580**.

(3) **TR91708** (Outer Diam. 2.00 mm / 0.078 in) Larger and **TR57160R** (Inner Diam 0.5 mm / 0.020 in) Smaller, are also available.

(4) **TRE20585** Crankshaft 60mm (long) snout, (m) R81959 or R121018.

(5) Threaded Type.

(6) Replace all R78558 Cap Screws with Flanged Head Cap Screw **TR85363**.