

**300 Series**  
**Engine & Equipment**  
**Model**

**4.202**

> 158,257

O'rings on liner

4 Cyl

Bore: 3.86 in (2)  
 98 mm  
 Pin Ø: 1.185 in  
 30 mm

**Block (m):**  
 T23406, T24961,  
 T26933

**APPLICATIONS:**

**AGRICULTURAL**  
 2020  
 2510

**CONSTRUCTION**

400  
 440  
 450  
 480

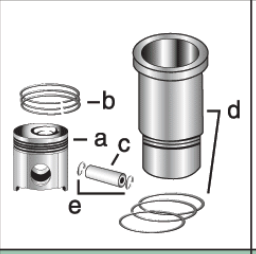
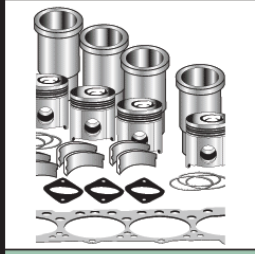

<b>1) Engine O/H Kit</b>	<b>Piston-Liner Kit</b>	<b>Main Bearing</b>	<b>Thrust Bearing</b>	<b>Con Rod Bearing</b>
--------------------------	-------------------------	---------------------	-----------------------	------------------------

<b>2) Engine I/F Kit</b>	<b>TPLK481</b> Consists of:	<b>TRE27352</b> Std.	<b>TAT21139</b> Std.	<b>TRE27348</b> Std.
<b>1) TOK4481</b>	a) <b>TT23481</b>	<b>TRE27353</b> .010	<b>TAT21132</b> .010	<b>TRE27349</b> .010
<b>2) TIK4481</b>	b) <b>TAR70633</b>	<b>TRE27360</b> .020	<b>TAT21134</b> .020	<b>TRE27358</b> .020
	c) <b>TT23482</b>	<b>TRE27368</b> .030	<b>TAT21136</b> .030	<b>TRE27364</b> .030
	d) <b>TAR51902</b>			
	e) <b>TR51112</b>			
		<b>Use 4</b>	<b>Use 1</b>	<b>Use 4</b>

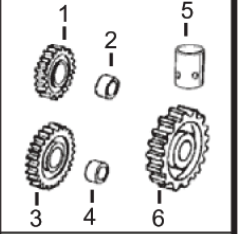
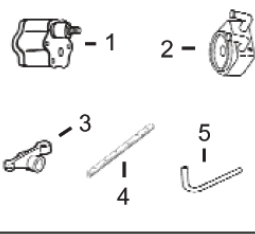
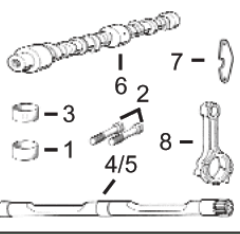
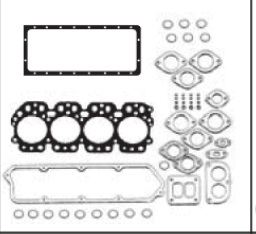
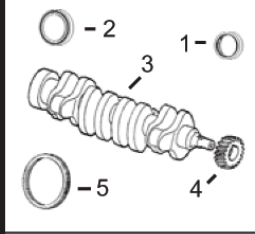

<b>1) Front Seal</b> <b>2) Rear Seal</b>	<b>1) O/H Gasket Set</b>	<b>1) Bush, Con Rod</b> <b>2) Bolt, Con Rod</b> <b>3) Bush, Bal. Shaft</b>	<b>1) Pump, Oil</b> <b>2) Oil Cooler</b> <b>3) Rocker Arm</b> <b>4) Rocker Shaft</b> <b>5) Pump, Oil Tube</b>	<b>1) Lower Gear</b> <b>2) Lower Bushing</b> <b>3) Upper Gear</b> <b>4) Upper Bushing</b> <b>5) Cam. Follower</b> <b>6) Cam. Gear</b>
<b>3) Crankshaft</b> <b>4) Crankshaft, Gear</b> <b>5) Ring Gear</b>	<b>2) Head Gasket Set</b> <b>3) Head Gasket</b> <b>4) Oil Pan Gasket</b> <b>5) Rocker Cover Gsk</b>	<b>4) Bal. Shaft R/H</b> <b>5) Bal. Shaft L/H</b> <b>6) Camshaft</b> <b>7) Bal. Shaft Stop</b> <b>8) Con Rod</b>		

<b>1) TAR67942</b> <b>2) TRE44574 (1)</b> <b>3) TAT18030</b> <b>4) TT20094</b> <b>5) TR114282 (142T)</b>	<b>1) TRE38558</b> <b>2) TRE38847</b> <b>3) TR98461</b> <b>4) TR97342</b> <b>5) TR73521</b>	<b>1) TT23471 x4</b> <b>2) TR74194 x8 (3)</b> <b>3) TR57160 x6 (6)</b> <b>4) TRE26282 R/H</b> <b>5) TRE26283 L/H</b> <b>6) TR82820 (5)</b> <b>7) TR88112</b> <b>8) TAT18005</b>	<b>1) TRE55343</b> <b>2) TRE31929</b> <b>3) TRE31973</b> <b>4) TR54987</b> <b>5) TR113752</b>	<b>1) TAT24252</b> <b>2) TT26321</b> <b>3) TAT18009</b> <b>4) TT20034</b> <b>5) TT20073</b> <b>6) TT20070</b>
--	---	--	---	--

<b>Valve, Intake</b>	<b>Valve, Exhaust</b>	<b>Insert, Valve</b> <b>1) Intake</b> <b>2) Exhaust</b>	<b>1) Cap, Valve</b> <b>2) Lock, Valve</b>	<b>1) Spring, Valve</b> <b>2) Rotator, Valve</b> <b>3) O'ring, Valve</b>
<b>TR79623</b> Std. <b>TR79628</b> .003 <b>TR79629</b> .015	<b>TR79624</b> Std. <b>TR79625</b> .003 <b>TR79626</b> .015	<b>1) TR73064</b> Std. <b>2) TR51734</b> Std.	<b>1) TT20129</b> <b>2) TT20077</b>	<b>1) TR26125</b> <b>2) TRE11410</b> <b>3) TR87627</b>

<b>1) Thermostat</b> <b>2) Thermostat Cover</b>	<b>Fuel Transfer Pump</b>	<b>Water Pump Repair Kit</b>		<b>Injector, Pencil</b>	<b>Seal</b>
<b>1) TRE33705 180° F (4)</b> <b>2) TT23620</b>	<b>TRE42211</b>	<b>Without Impeller</b>	<b>With Impeller</b>	<b>TAR89564</b>	<b>TR60746</b> <b>TR48000</b>
		<b>TRE19507</b>	<b>TRE62658</b>		

(1) Do not use with Flywheel Housing (m) T20300, T22991.  
 (2) Always verify Bore diameter, on Block Replacement is 4.016"/102mm.  
 (3) Use TR74194 with C.Rod (m) T20007; use TR80033 with C.Rod (m) R81410.  
 (4) Do not use with Housing (m) R54096, R70741, R74549.  
 (5) Threaded Type.  
 (6) TR91708 (Outer Diam. 2.00 mm / 0.078 in ) Larger and TR57160R (Inner Diam 0.5 mm / 0.020 in ) Smaller, are also available.