

**300 Series**  
**Engine & Equipment**  
**Model**

**4.239D**

4 Cyl

Bore: 4.19 in  
 106.5 mm  
 Pin Ø: 1.375 in  
 35 mm

**APPLICATIONS:**

**AGRICULTURAL**

- 940 2450
- 942 2535
- 1640 2550
- 1840 2555CS
- 2130 2650
- 2135 2730
- 2250 2735
- 2350 3330
- 2355 3430
- 2355CS 6602
- 2360

**CONSTRUCTION**

- 70 400G
- 70D 415B
- 210C 415C
- 244E 490
- 290D 515B
- 310C/D
- 315C

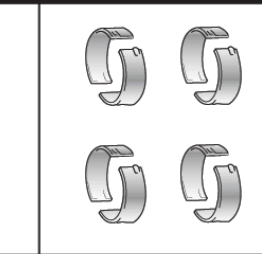
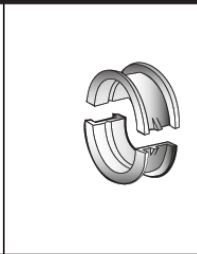
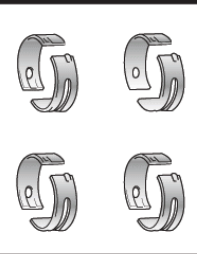
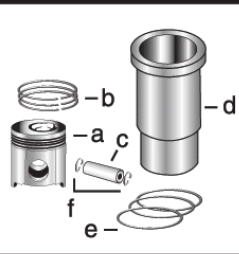
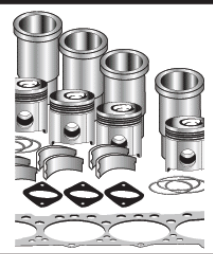

**1) Engine O/H Kit**      **Piston-Liner Kit**      **Main Bearing**      **Thrust Bearing**      **Con Rod Bearing**

**2) Engine I/F Kit**      **TRE30250**      **TRE27352** Std.      **TAT21139** Std.      **TRE27348** Std.

**1) TAT86992**      Consists of:      **TRE27353** .010      **TAT21132** .010      **TRE27349** .010  
**2) TIK86992**      a) **TRE19282**      **TRE27360** .020      **TAT21134** .020      **TRE27358** .020  
 b) **TRE66820**      **TRE27368** .030      **TAT21136** .030      **TRE27364** .030  
 c) **TR125754**  
 d) **TR116281**  
 e) **TAR65507**  
 f) **TM41029**

Use 4

Use 1

Use 4

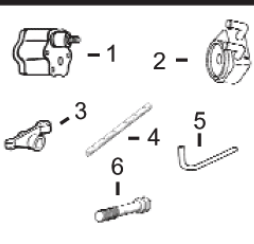
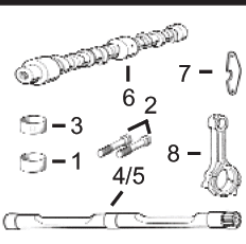
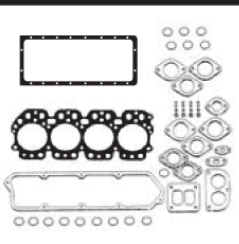
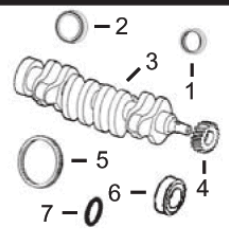

**1) Front Seal**      **1) O/H Gasket Set**      **1) Bush, Con Rod**      **1) Pump, Oil**      **1) Lower Gear**  
**2) Rear Seal**      **2) Head Gasket Set**      **2) Bolt, Con Rod**      **2) Oil Cooler**      **2) Lower Bushing**  
**3) Crankshaft**      **3) Head Gasket**      **3) Bush, Bal. Shaft**      **3) Rocker Arm**      **3) Upper Gear**  
**4) Crankshaft, Gear**      **4) Oil Pan Gasket**      **4) Bal. Shaft R/H**      **4) Rocker Shaft**      **4) Upper Bushing**  
**5) Ring Gear**      **5) Rocker Cover Gsk**      **5) Bal. Shaft L/H**      **5) Pump, Oil Tube**      **5) Cam. Follower**  
**6) Sleeve, Front**      **6) Camshaft**      **6) Camshaft Stop**      **6) Cyl Hd Cap Screw**      **6) Cam. Gear**  
**7) Packing, Sleeve**      **7) Bal. Shaft Stop**  
**8) Con Rod**

**1) TAR67942**      **1) TRE501579**      **1) TR55647 x4**      **1) TRE55343**      **1) TAT24252**  
**2) TRE44574**      **2) TRE38851**      **2) TR80033 x8 (3)**      **2) TRE31929**      **2) TT26321**  
**3) TAT18030 (1)**      **3) TR125863**      **3) TR57160 x6 (5)**      **3) TRE31973**      **3) TAT18009**  
 or  
**TRE20585 (2)**      **4) TR97342**      **4) TRE26282 R/H (\*)**      **4) TR54987**      **4) TT20034**  
**4) TT20094**      **5) TR73521**      **5) TRE26283 L/H (\*)**      **5) TR113752**      **5) TT20073**  
**5) TR114282 (142T)**      **6) TR82820 (4)**      **6) TR85363 x18 (6)**      **6) TR113752**      **6) TT20070**  
**6) TR81989**  
**7) TH35244**



Valve, Intake  
**TR79623** Std.  
**TR79628** .003  
**TR79629** .015

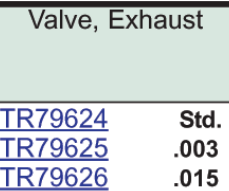

Valve, Exhaust  
**TR79624** Std.  
**TR79625** .003  
**TR79626** .015

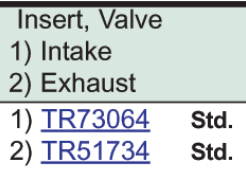

Insert, Valve  
 1) Intake  
 2) Exhaust  
**TR73064** Std.  
**TR51734** Std.

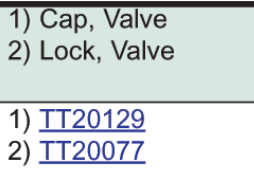

**1) Cap, Valve**  
**2) Lock, Valve**  
**TT20129**  
**TT20077**

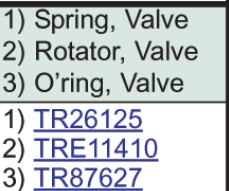

**1) Spring, Valve**  
**2) Rotator, Valve**  
**3) O'ring, Valve**  
**TR26125**  
**TRE11410**  
**TR87627**



**1) Thermostat**  
**2) Thermostat Cover**  
**TRE33705** 180° F  
**TT23620**

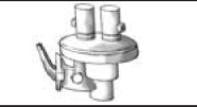

**Fuel Transfer Pump**  
**TRE42211**



**Water Pump Rep Kit**  
 a) Without Impeller  
 b) With Impeller  
**TRE19507**  
**TRE62658**



**Water Pump**  
**TAR97708**  
 (m) R73604

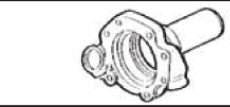

**Transmission Oil Pump**  
**TAL120106**      **TAL68094**  
 Verify P/N for your application

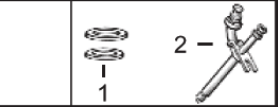

**1) Seal**  
**2) Injector, Pencil**  
**TR60746**  
**TR48000**  
**TAR89564**

(\*) If these engines use bolt on weights shafts use **TAR69710** RH and **TAR69711** LH.  
 (1) **TAT18030** Crankshaft 36mm (short) snout, (m) T23517.  
 (2) **TRE20585** Crankshaft 60mm (long) snout, (m) R81959 or R121018.  
 (3) For Connecting Rod (m) R58979, use **TR74194** Connecting Rod Bolt available upon request.  
 (4) Threaded Type.  
 (5) **TR91708** (Outer Diam. 2.00 mm / 0.078 in ) Larger and **TR57160R** (Inner Diam 0.5 mm / 0.020 in ) Smaller, are also available.  
 (6) Replace all R78558 Cap Screws with Flanged Head Cap Screw **TR85363**.