

**300 Series**  
**Engine & Equipment**  
**Model**

**4.276D**

Small Pin

4 Cyl

Bore: 4.19 in  
 106.5 mm  
 Pin Ø: 1.375 in  
 35 mm

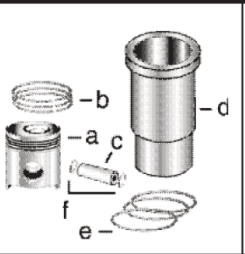

**1) Engine O/H Kit**      **Piston-Liner Kit**      **Main Bearing**      **Thrust Bearing**      **Con Rod Bearing**

**2) Engine I/F Kit**      **TRE19831**      **TRE27352** Std.      **TAT21139** Std.      **TAR97517** Std.

**1) TAT86990**      Consists of:      **TRE27353** .010      **TAT21132** .010      **TAR97653** .010

**2) TIK86990**      a) **TAR63342**      **TRE27360** .020      **TAT21134** .020      **TAR97654** .020

b) **TRE66820**      **TRE27368** .030      **TAT21136** .030      **TAR97655** .030

c) **TR125754**      **Use 4**      **Use 1**      **Use 4**

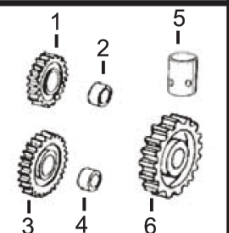
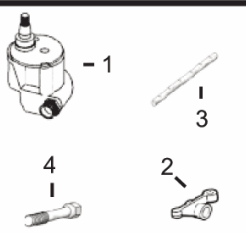
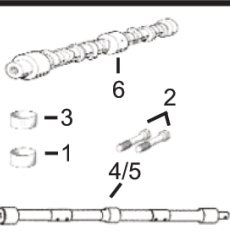
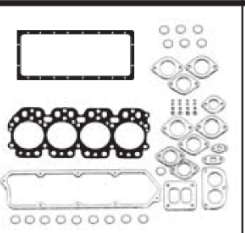
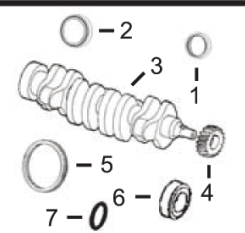

**APPLICATIONS:**

**AGRICULTURAL**

2630  
 2640

**1) Front Seal**      **1) O/H Gasket Set**      **1) Bush, Con Rod**      **1) Pump, Oil**      **1) Lower Gear**  
**2) Rear Seal**      **2) Head Gasket Set**      **2) Bolt, Con Rod**      **2) Rocker Arm**      **2) Lower Bushing**

**3) Crankshaft**      **3) Head Gasket**      **3) Bush, Bal. Shaft**      **3) Rocker Shaft**      **3) Upper Gear**  
**4) Crankshaft, Gear**      **4) Oil Pan Gasket**      **4) Bal. Shaft R/H**      **4) Cyl Hd Cap Screw**      **4) Upper Bushing**  
**5) Ring Gear**      **5) Rocker Cover Gsk**      **5) Bal. Shaft L/H**      **5) Cam. Follower**  
**6) Sleeve, Front**      **6) Camshaft**      **6) Cam. Gear**  
**7) Packing, Sleeve**

**CONSTRUCTION**

410C

**1) TAR67942**      **1) TRE501568**      **1) TR57450 x4**      **1) TRE65580 (1)**      **1) TAT24252**

**2) TRE44574**      **2) TRE38851**      **2) TR74195 x8 (4)**      **2) TRE31973**      **2) TT26321**

**3) TRE56792**      **3) TR125863**      **3) TR57160 x6**      **3) TR54987**      **3) TAT18009**

**4) TT20094**      **4) TR97342**      **4) TAR69710 R/H**      **4) TR85363 x18 (3)**      **4) TT20034**

**5) TR28811 (129T)**      **5) TR73521**      **5) TAR69711 L/H**      **5) TT20073**

**6) TR81989**      **6) TR82820 (2)**      **6) TT20070**

**7) TH35244**



Valve, Intake  
**TR79623** Std.  
**TR79628** .003  
**TR79629** .015

Valve, Exhaust  
**TR79624** Std.  
**TR79625** .003  
**TR79626** .015

Insert, Valve  
 1) Intake  
 2) Exhaust  
**TR73064** Std.  
**TR51734** Std.

1) Cap, Valve  
 2) Lock, Valve  
**TT20129**  
**TT20077**

1) Spring, Valve  
 2) Rotator, Valve  
 3) O'ring, Valve  
**TR26125**  
**TRE11410**  
**TR87627**

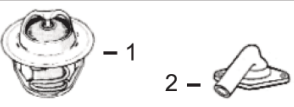

**1) TAR48675** 180° F  
**2) TT23620**  
**TRE42211**



**Water Pump Repair Kit**  
 Without Impeller      With Impeller  
**TRE19507**      **TRE62658**



**Injector, Pencil**  
**TRE37503**



**Seal, Injector**  
**TR60746**  
**TR48000**

(1) This engine may use standard flow Pump, Oil [TRE55343](#).

(2) Threaded Type.

(3) From ESN 137128 Replace all R78558 Cap Screws with Flanged Head Cap Screw [TR85363](#).

(4) When used on connecting rods marked R54617, torque bolts to 95 ft.lbs. Only.