

300 Series
Engine & Equipment
Model

4.276D

Small Pin

4 Cyl

Bore: 4.19 in
 106.5 mm
 Pin Ø: 1.375 in
 35 mm

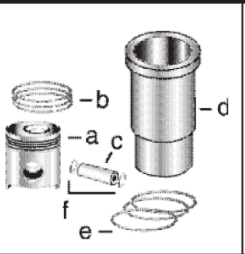

1) Engine O/H Kit

Piston-Liner Kit

Main Bearing

Thrust Bearing

Con Rod Bearing

2) Engine I/F Kit

TRE19831
 Consists of:
 a) [TAR63342](#)
 b) [TRE66820](#)
 c) [TR125754](#)
 d) [TR80500](#)
 e) [TAR65507](#)
 f) [TM41029](#)

[TRE27352](#) Std.
[TRE27353](#) .010
[TRE27360](#) .020
[TRE27368](#) .030
Use 4

[TAT21139](#) Std.
[TAT21132](#) .010
[TAT21134](#) .020
[TAT21136](#) .030
Use 1

[TAR97517](#) Std.
[TAR97653](#) .010
[TAR97654](#) .020
[TAR97655](#) .030
Use 4

1) [TAT86990](#)

2) [TIK86990](#)

APPLICATIONS:

AGRICULTURAL
 2630
 2640

CONSTRUCTION
 410C

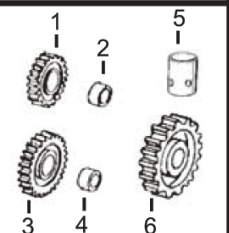
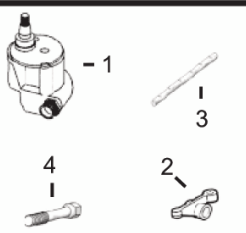
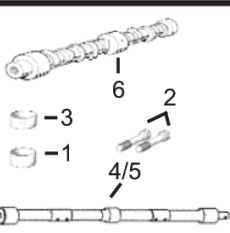
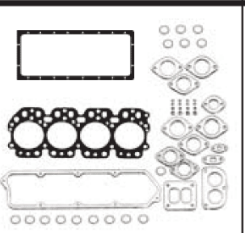
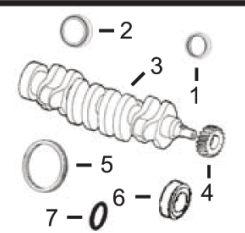

1) Front Seal
 2) Rear Seal

1) O/H Gasket Set

1) Bush, Con Rod
 2) Bolt, Con Rod
 3) Bush, Bal. Shaft

1) Pump, Oil
 2) Rocker Arm
 3) Rocker Shaft
 4) Cyl Hd Cap Screw

1) Lower Gear
 2) Lower Bushing
 3) Upper Gear
 4) Upper Bushing
 5) Cam. Follower
 6) Cam. Gear

3) Crankshaft
 4) Crankshaft, Gear
 5) Ring Gear
 6) Sleeve, Front
 7) Packing, Sleeve

2) Head Gasket Set
 3) Head Gasket
 4) Oil Pan Gasket
 5) Rocker Cover Gsk

4) Bal. Shaft R/H
 5) Bal. Shaft L/H
 6) Camshaft

1) [TAR67942](#)
 2) [TRE44574](#)
 3) [TRE56792](#)
 4) [TT20094](#)
 5) [TR28811](#) (129T)
 or
[TR114282](#) (142T)
 6) [TR81989](#)
 7) [TH35244](#)

1) [TRE501568](#)
 2) [TRE38851](#)
 3) [TR125863](#)
 4) [TR97342](#)
 5) [TR73521](#)

1) [TR57450](#) x4
 2) [TR74195](#) x8 (4)
 3) [TR57160](#) x6
 4) [TAR69710](#) R/H
 5) [TAR69711](#) L/H
 6) [TR82820](#) (2)

1) [TRE65580](#) (1)
 2) [TRE31973](#)
 3) [TR54987](#)
 4) [TR85363](#) x18 (3)

1) [TAT24252](#)
 2) [TT26321](#)
 3) [TAT18009](#)
 4) [TT20034](#)
 5) [TT20073](#)
 6) [TT20070](#)

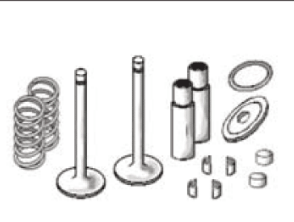

Valve, Intake

Valve, Exhaust

Insert, Valve
 1) Intake
 2) Exhaust

1) Cap, Valve
 2) Lock, Valve

1) Spring, Valve
 2) Rotator, Valve
 3) O'ring, Valve

[TR79623](#) Std.
[TR79628](#) .003
[TR79629](#) .015

[TR79624](#) Std.
[TR79625](#) .003
[TR79626](#) .015

1) [TR73064](#) Std.
 2) [TR51734](#) Std.

1) [TT20129](#)
 2) [TT20077](#)

1) [TR26125](#)
 2) [TRE11410](#)
 3) [TR87627](#)

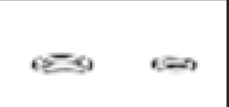
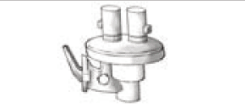
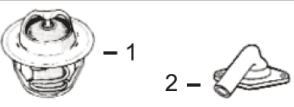

1) Thermostat
 2) Thermostat Cover

Fuel Transfer Pump

Water Pump Repair Kit

Injector, Pencil

Seal, Injector

1) [TAR48675](#) 180° F
 2) [TT23620](#)
[TRE42211](#)

Without Impeller
[TRE19507](#)

With Impeller
[TRE62658](#)

[TRE37503](#)

[TR60746](#)
[TR48000](#)

(1) This engine may use standard flow Pump, Oil [TRE55343](#).

(2) Threaded Type.

(3) From ESN 137128 Replace all R78558 Cap Screws with Flanged Head Cap Screw [TR85363](#).

(4) When used on connecting rods marked R54617, torque bolts to 95 ft.lbs. Only.