

**300 Series**  
**Engine & Equipment**  
**Model**

**4.239T**

4 Cyl

Bore: 4.19 in  
 106.5 mm  
 Pin Ø: 1.625 in  
 41 mm

**Con Rod (m):**  
 R80032, R113612,  
 R122191

**APPLICATIONS:**

**AGRICULTURAL**

- 945 2750
- 952 2755
- 1052 2755 CS/TSS
- 1155 2850
- 2140 2855
- 2450 2855N
- 2555 3430
- 2555 TSS 3830
- 2650

**CONSTRUCTION**

- 310 C/D (Turbo)
- 315 C/D (Turbo)
- 515B



- 1) Thermostat  
 2) Thermostat Cover
- 1) [TAR48675](#) 180° F  
 2) [TT23620](#)

(\*) If these engines use bolt on weights shafts use [TAR69710](#) RH and [TAR69711](#) LH.

(1) [TAT18030](#) Crankshaft 36mm (short) snout, (m) T23517.

(2) May use High Capacity Pump, Oil [TRE65580](#).

(3) [TR91708](#) (Outer Diam. 2.00 mm / 0.078 in ) Larger and [TR57160R](#) (Inner Diam 0.5 mm / 0.020 in ) Smaller, are also available.

(4) [TRE20585](#) Crankshaft 60mm (long) snout, (m) R81959 or R121018.

(5) Threaded Type.

(6) Replace all R78558 Cap Screws with Flanged Head Cap Screw [TR85363](#).

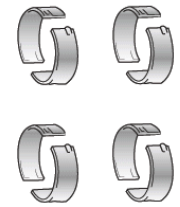
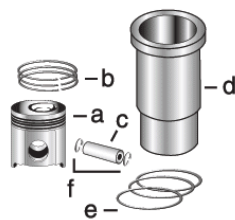

1) Engine O/H Kit

Piston-Liner Kit

Main Bearing

Thrust Bearing

Con Rod Bearing

2) Engine I/F Kit

[TRE33115](#)

Consists of:

- a) [TRE19278](#)
- b) [TRE66820](#)
- c) [TR124230](#)
- d) [TR116281](#)
- e) [TAR65507](#)
- f) [TR54114](#)

[TRE27352](#) Std.

[TAT21139](#) Std.

[TRE27348](#) Std.

1) [TRE54709](#)

[TRE27353](#) .010

[TAT21132](#) .010

[TRE27349](#) .010

2) [TIK54709](#)

[TRE27360](#) .020

[TAT21134](#) .020

[TRE27358](#) .020

[TRE27368](#) .030

[TAT21136](#) .030

[TRE27364](#) .030

Use 4

Use 1

Use 4

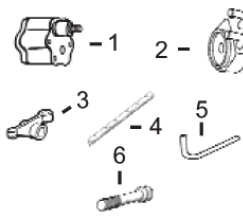
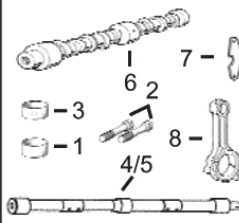
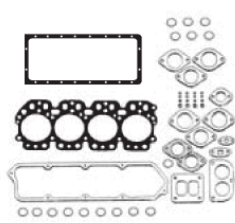
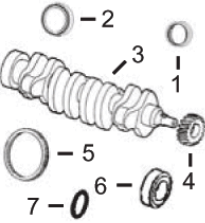

1) Front Seal  
 2) Rear Seal

1) O/H Gasket Set

1) Bush, Con Rod  
 2) Bolt, Con Rod  
 3) Bush, Bal. Shaft

1) Pump, Oil  
 2) Oil Cooler  
 3) Rocker Arm  
 4) Rocker Shaft  
 5) Pump, Oil Tube  
 6) Cyl Hd Cap Screw

1) Lower Gear  
 2) Lower Bushing  
 3) Upper Gear  
 4) Upper Bushing  
 5) Cam. Follower  
 6) Cam. Gear

3) Crankshaft  
 4) Crankshaft, Gear  
 5) Ring Gear  
 6) Sleeve, Front  
 7) Packing, Sleeve

2) Head Gasket Set  
 3) Head Gasket  
 4) Oil Pan Gasket  
 5) Rocker Cover Gsk

4) Bal. Shaft R/H  
 5) Bal. Shaft L/H  
 6) Camshaft  
 7) Bal. Shaft Stop  
 8) Con Rod

1) [TAR67942](#)  
 2) [TRE44574](#)  
 3) [TAT18030](#) (1)  
 or  
[TRE20585](#) (4)  
 4) [TT20094](#)  
 5) [TR114282](#) (142T)  
 6) [TR81989](#)  
 7) [TH35244](#)

1) [TRE501579](#)  
 2) [TRE38851](#)  
 3) [TR125863](#)  
 4) [TR97342](#)  
 5) [TR73521](#)

1) [TR57451](#) x4  
 2) [TR80033](#) x8  
 3) [TR57160](#) x6 (3)  
 4) [TRE26282](#) R/H (\*)  
 5) [TRE26283](#) L/H (\*)  
 6) [TR82820](#) (5)  
 7) [TR88112](#)  
 8) [TRE58347](#)

1) [TRE55343](#) (2)  
 2) [TRE31929](#)  
 3) [TRE31973](#)  
 4) [TR54987](#)  
 5) [TR113752](#)  
 6) [TR85363](#) x18 (6)

1) [TAT24252](#)  
 2) [TT26321](#)  
 3) [TAT18009](#)  
 4) [TT20034](#)  
 5) [TT20073](#)  
 6) [TT20070](#)

Valve, Intake

Valve, Exhaust

Insert, Valve

1) Cap, Valve  
 2) Lock, Valve

1) Spring, Valve  
 2) Rotator, Valve  
 3) O'ring, Valve

[TR83071](#) Std.  
[TR89223](#) .003  
[TR89224](#) .015

[TR79624](#) Std.  
[TR79625](#) .003  
[TR79626](#) .015

1) [TR73064](#) Std.  
 2) [TR51734](#) Std.

1) [TT20129](#)  
 2) [TT20077](#)

1) [TR26125](#)  
 2) [TRE11410](#)  
 3) [TR87627](#)

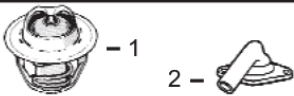

1) Thermostat  
 2) Thermostat Cover

1) [TAR48675](#) 180° F  
 2) [TT23620](#)



Fuel Transfer Pump

[TRE42211](#)



Water Pump Rep Kit  
 a) Without Impeller  
 b) With Impeller

See Chart



Water Pump

[TAR97708](#)  
 (m) R73604



Transmission Oil Pump

[TAL120106](#)    [TAL68094](#)

Verify P/N for your application

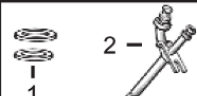

1) Seal  
 2) Injector, Pencil

1) [TR60746](#)  
[TR48000](#)  
 2) [TRE37503](#)