

400 Series
Engine & Equipment
Model

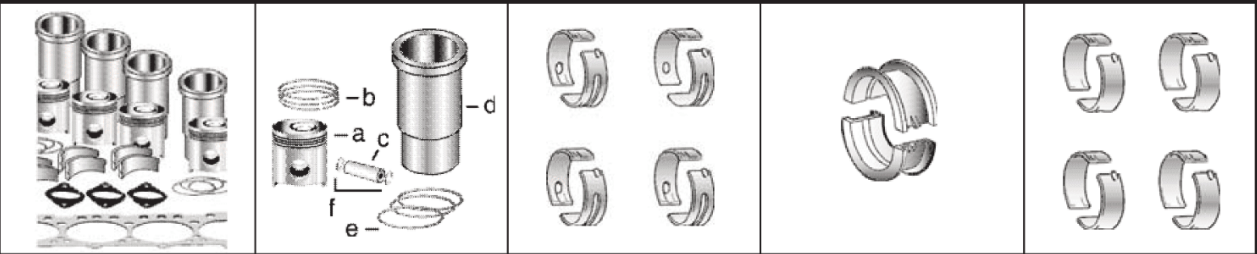

4.270

> 280,000

4 Cyl

Bore: 4.25 in
 108 mm
 Pin Ø: 1.50 in
 38 mm

Block (m):
 R26160, R32020,
 R40850

APPLICATIONS:

AGRICULTURAL
 3010
 3020

CONSTRUCTION

500
 500A
 500B
 500C
 510

1) Engine O/H Kit Piston-Liner Kit Main Bearing Thrust Bearing Con Rod Bearing

2) Engine I/F Kit	TRE23173 Consists of:	TAR49243 Std.	TAR49242 Std.	TAR45723 Std.
1) TRG17899	a) TR23172	TAR49245 .010	TAR49238 .010	TAR46396 .010
2) TIK17899	b) TAR55630	TAR49246 .020	TAR49239 .020	TAR46397 .020
	c) TR44161	TAR49247 .030	TAR49240 .030	TAR46398 .030
	d) TR32050			
	e) TAR40155			
	f) TH80753			
		Use 4	Use 1	Use 4

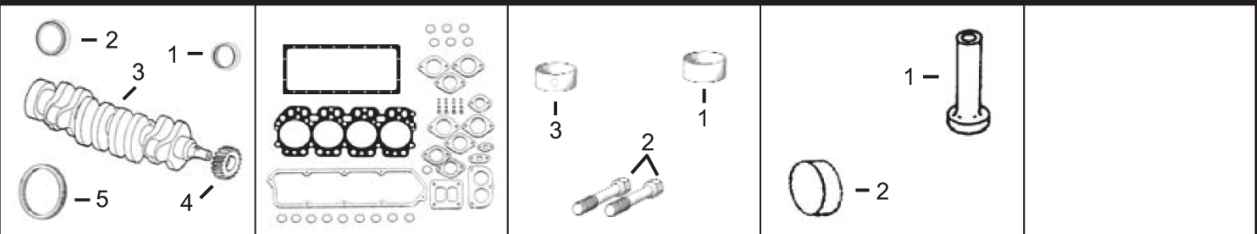

1) Front Seal 2) Rear Seal	1) O/H Gasket Set	1) Bush, Con Rod 2) Bolt, Con Rod 3) Bushing, Cam	1) Cam Follower 2) Plug, Camshaft
3) Crankshaft 4) Crankshaft, Gear 5) Ring Gear	2) Head Gasket Set 3) Head Gasket 4) Oil Pan Gasket		

1) TAR49025 2) TRE520036 3) TAR40485 (1) c/s (m) R40570 4) TR26049 (23T) 5) TR28811 (129T)	1) TAR53033 2) TAR53032 3) TR45616 4) TR71917	1) TR30939 x4 2) TR66452 x8 3) TR46903 x3	1) TR26342 2) TR26115
--	--	--	--

Valve, Intake	Valve, Exhaust	Insert, Valve 1) Intake 2) Exhaust	1) Cap, Valve 2) Rotator, Valve	1) Spring, Valve 2) Guide, Valve 3) O'ring, Valve
TR26124 Std. ES > 157,001 TR44174 Std. ES 157,002-280,000	TR26123 Std. ES > 157,001 TR44175 Std. ES 157,002-280,000	1) TR43680 Std. 2) TR43681 Std.	1) N/A 2) N/A	1) TR26125 2) TR28654 3) TR87627

Thermostat	Fuel Transfer Pump	Water Pump Repair Kit		Injector, Pencil	Seal, Injector
TR36846 180° F	TAR53567 TRE42211	Without Impeller	With Impeller	TAR50781	TR60746 TR48000
		See Chart			

(1) New style crankshaft. To adapt to old style center hole needs to be enlarged 2.835 in. (72.0009 mm). Extra bolt holes need to be plugged with Allen head screws and tread lock.